

## EDITORIAL &amp; PRODUCTION

**Senior Vice President**

Jeff Prescott, PharmD, RPh

**Assistant Director,****Content Services**

Angelia Szwed

**Scientific Directors**

Danielle Jamison,

PharmD, MS

Darrja Zangari,

PharmD, BCPS, BCGP

**Senior Clinical****Project Managers**

Ida Delmendo

Danielle Mroz, MA

**Clinical Project****Managers**

Lauren Burawski, MA

Ted Pigeon

**Project Managers**

Lindsay Caporrino

Andrea Szeszko

**Associate Editors**

Hayley Fahey

Jill Pastor

Amanda Thomas

**Medical Writers**

Amber Schilling,

PharmD

Valerie Sjoberg

Samantha Stone, PhD

**Copy Chief**

Jennifer Potash

**Copy Supervisor**

Paul Silverman

**Medical & Scientific****Quality Review Editor**

Stacey Abels, PhD

**Copy Editors**

Georgina Carson

Rachelle Laliberte

Kirsty Mackay

Amy Oravec

**Creative Director,****Publishing**

Melissa Feinen

**Art Director**

Julianne Costello

## SALES &amp; MARKETING

**Vice President**

Gil Hernandez

**Senior National****Account Managers**

Ben Baruch

Megan Halsch

**National Account****Managers**

Robert Foti

Ryan O'Leary

**National Account****Associate**

Kevin George

## OPERATIONS &amp; FINANCE

**Circulation Director**

Jon Severn

circulation@mjhassoc.com

**Vice President,****Finance**

Leah Babitz, CPA

**Controller**

Katherine Wyckoff

## CORPORATE

**Chairman & Founder**

Mike Hennessy Sr

**Vice Chairman**

Jack Lepping

**President & CEO**

Mike Hennessy Jr

**Chief Financial Officer**

Neil Glasser, CPA/CFE

**Executive Vice****President, Operations**

Tom Tolvé

**Executive Vice****President, Global****Medical Affairs &****Corporate Development**

Joe Petroziello

**Senior Vice President,****Content**

Silas Inman

**Senior Vice President,****I.T. & Enterprise****Systems**

John Moricone

**Senior Vice President,****Audience Generation &****Product Fulfillment**

Joy Puzzo

**Vice President,****Human Resources****and Administration**

Shari Lundenberg

**Vice President,****Business Intelligence**

Chris Hennessy

**Executive****Creative Director,****Creative Services**

Jeff Brown

This publication was sponsored by Grifols USA, LLC.

# Immunoglobulin Potency and Purity Considerations for Patients With Primary Immunodeficiency

## INTRODUCTION AND BACKGROUND

Primary immunodeficiency (PID) diseases occur in about 1 in every 1200 individuals and are associated with recurrent infections and several comorbidities that contribute to its substantial morbidity and mortality, especially prior to diagnosis.<sup>1-5</sup> Most PID diseases are chronic, and, thereby require continuous treatment.<sup>2,6</sup> Herein, the epidemiology, clinical burden, and economic burden of PID will be summarized. Additionally, current treatment options for PID will be reviewed and a subcutaneous (SC) immunoglobulin G (IgG) therapy will be introduced.

### Disease Overview

PID diseases are a group of chronic, noncontagious disorders that are characterized by a dysregulated immune system. PID is caused by genetic or hereditary defects and affects both children and adults. There are over 400 rare types of PID disorders that can affect 1 or more components of the immune system.<sup>7</sup> They can be categorized based on whether they affect specific or adaptive immunity (eg, humoral or antibody deficiencies) or combined deficiencies affecting both humoral and cellular immune mechanisms.<sup>8</sup> Approximately half of all patients with a diagnosis of PID have antibody deficiencies.<sup>3</sup>

Patients with PID have variable clinical presentations of the disease, although most have higher predisposition to infections.<sup>9</sup> These infections are periodic or due to unusual organisms and can affect the skin, ears, brain, spinal cord, respiratory system, urinary tract, or gastrointestinal tract.<sup>2</sup> The affected organ systems and pathogens involved vary based on the type of immune defect, although many immunodeficiencies have autoimmune disease and malignancy characteristics as a common phenotype.<sup>8</sup>

Diagnosis of PID typically does not occur until after a patient experiences recurrent or severe infections, highlighting the need for earlier detection.<sup>2</sup> The average time to diagnosis of PID after onset of symptoms is 12.4 years, and in some patients it may take up to 20 years for a diagnosis.<sup>10,11</sup> A delayed diagnosis of PID can result in permanent functional impairment, loss of function, and substantial morbidity. In a 2013 survey of 1394 patients with PID conducted by the Immune Deficiency Foundation (IDF), patients reported permanent impairment or losses in lung function (28%), hearing (15%), digestive function (14%), mobility (9%), neurological function (9%), vision (6%), kidney function (3%), and liver function (2%) prior to PID diagnosis.<sup>10</sup> In separate analyses, a delayed diagnosis of PID was most commonly associated with recurrent sinusitis, recurrent pneumonia, and/or subsequent treatment with IgG.<sup>3,5</sup> PID diagnosis may be suspected if there are recurrent or persistent infections, when mild childhood disease becomes life-threatening, or if there

**AJMC**  
THE AMERICAN JOURNAL OF MANAGED CARE

© 2020 Managed Care & Healthcare Communications, LLC

Opinions expressed by authors, contributors, and advertisers are their own and not necessarily those of Managed Care & Healthcare Communications, LLC, the editorial staff, or any member of the editorial advisory board. Managed Care & Healthcare Communications, LLC, is not responsible for accuracy of dosages given in articles printed herein. The appearance of advertisements in this publication is not a warranty, endorsement, or approval of the products or services advertised or of their effectiveness, quality, or safety. Managed Care & Healthcare Communications, LLC, disclaims responsibility for any injury to persons or property resulting from any ideas or products referred to in the articles or advertisements.

are high or low blood cell counts.<sup>2</sup> PID is most often diagnosed by an immunologist and 17% of patients have a family history.<sup>11</sup>

### Epidemiology

PID is estimated to occur in 83.3 per 100,000 individuals based on a 2007 survey sample of 10,000 households.<sup>1</sup> This estimate corresponds to an estimated prevalence of 270,193 of 3.13 million in the United States, based on an estimation of the 2011 US population drawn from World Population Prospects, 2010 Revision.<sup>1,12</sup> Results of several studies have demonstrated PID prevalence has increased over time in the United States.<sup>13,14</sup> In 1 report, the prevalence of diagnosed PID increased by 30% and 41% from 2001 to 2007 and 2001 to 2005, respectively.<sup>13</sup> The physician-reported prevalence of patients with PID increased by 57% from 2013 to 2018 (40,560 patients in 2013 and 63,684 patients in 2018).<sup>14</sup> Campaigns to educate and raise awareness of PID among health care providers and the general public may have contributed to the rise in incidence and prevalence of PID over time.<sup>13</sup>

### Clinical Burden of PID

PID is associated with substantial morbidity and mortality in a majority of patients, especially due to increased susceptibility to infections.<sup>4,13</sup> Additional comorbidities in patients with PID include gastrointestinal diseases, liver diseases, autoimmune diseases, cytopenias, and cancer.<sup>3,15</sup> To understand the burden of PID-associated morbidity, the number of hospital admissions and length of hospitalizations for patients with PID were identified using claims data from the Truven Health MarketScan of Commercial Claims and Encounters (from 2001-2007) and Multi-State Medicaid databases (from 2001-2005). Patients with PID were 2 times more likely to be hospitalized and have significantly longer hospital stays than patients without PID, which may partly be due to infections and other comorbidities.<sup>13</sup> According to data from the National Center for Health Statistics from 1999 to 2014, the overall age-adjusted mortality rate in patients with PID was 0.43 per 1,000,000 population (95% CI, 0.40-0.46), with the highest mortality rates from the southern part of the United States (36% PID-related deaths).<sup>4</sup> The contributing cause of mortality in the US PID population included extrapulmonary infections (35%), respiratory illnesses that were either infectious (eg, pneumonia) or noninfectious (eg, acute respiratory distress syndrome) pulmonary illnesses (17%), cardiovascular (11%), endocrine/metabolic (6%), and malignancy (5%).<sup>4</sup> Some serious complications of primary antibody deficiency may be fatal. Patients with PID have a 10-year survival rate of 93.5% after diagnosis with PID.<sup>3,15,16</sup>

The results of studies have reported that patients with PID experience lower health-related quality of life (HRQOL) than those without PID.<sup>17,18</sup> In a 2016 observational study of 18 adult patients and 8 pediatric patients diagnosed with PID—specifically primary antibody deficiencies—HRQOL was assessed through self-administered questionnaires.<sup>17</sup> Patients who were eligible were recently diagnosed with or suspected of having common variable immunodeficiency, X-linked agammaglobulinemia, or autosomal recessive agammaglobulinemia,

or specific antibody deficiency. Patients who had a life expectancy of 1 year or less, dementia and/or mental incapacity, or comorbidities or other conditions that would interfere with interpretation of the data were excluded. The 36-question Short Form Health Survey, version 2 (SF-36v2) was used to assess HRQOL in adults; it measures 8 domains including limitations in physical activities because of health problems (physical function), limitations in usual role activities because of physical health problems (role physical), bodily pain, general health perceptions, mental component score, vitality (ie, energy and fatigue), limitations in social activities because of physical or emotional problems (social functioning), limitations in usual role activities because of emotional problems (role emotional), general mental health (ie, psychologic distress and well-being). The Pediatric Quality of Life Inventory was used in children, which evaluates physical, emotional, social, and school-related parameters. Comparative samples were age- and sex-matched using separate least squares multiple regression models for each QOL scale and summary measure with the available normative data for the SF-36v2. For the mental health domains of the SF-36v2, adult patients with PID experienced significantly diminished ( $P < .05$ ) vitality (38.2 vs 49.4), social functioning (33.6 vs 49.8), and role emotional (41.0 vs 49.7), but not mental health, compared with the general US population. Compared with the general US population, adult patients with PID had lower HRQOL scores, with significantly lower scores on the physical domains assessed by the SF-36v2. (Table 1). In children, The Pediatric Quality of Life Inventory, which evaluates physical, emotional, social, and school-related parameters was used. Some pediatric patients reported an improvement after 12 months of treatment, however, others reported no change or worsening of their HRQOL; changes were not significant.<sup>17</sup>

In a separate survey-based 2-part study, 945 adult patients with common variable immune deficiency completed a 75-question survey (IDF survey), followed by a 12-question Short Form Health Survey (SF-12), to assess their HRQOL as a measure of disease burden. Results of the survey showed that the population with PID reported substantially diminished functional health and well-being compared with the general US population.<sup>18</sup>

### Economic Burden of PID

Prior to diagnosis of PID, patients experience a substantially higher rate of acute infections (6.38 vs 1.78), severe infections (4.32 vs 0.59), and bacterial pneumonias (2.84 vs 0.62) compared with postdiagnosis (Table 2).<sup>19</sup> As a result of this increased infection burden in patients with PID who have not yet been diagnosed, there is potential that greater healthcare resource utilization for infection management and productivity losses may drive the economic burden of this disease even before diagnosis. For example, this increased rate of infection can lead to more days in the hospital (70.88 vs 11.79) and a greater number of school or work days missed (33.90 vs 8.90) compared with patients who experience infections postdiagnosis.<sup>19</sup> The estimated annual cost of PID per patient prior to diagnosis was \$138,760.<sup>19</sup> After diagnosis and IgG replacement therapy, including

the cost of treatment, the estimated cost per patient was \$60,297—an annual savings of \$78,166 that is attributable to treatment of PID.<sup>17,19</sup> A report conducted in 2018 found that the annual savings post diagnosis were \$85,882 globally.<sup>14</sup>

In patients treated with IgG therapy, infections are common, with 2.16 infections per patient per year on average.<sup>20</sup> A retrospective claims analysis investigated the cost of infection among patients with PID, including infection-related resource utilization and infection-related medical expenditures longitudinally across a 7-month period.<sup>21</sup> A total of 1742 patients with a diagnosis of PID and healthcare claims for immunoglobulin intravenous (IGIV) therapy were identified from the Truven Health Analytics MarketScan Commercial Research Database (January 1, 2008, to September 30, 2010).<sup>21</sup> Across the 7-month study period, 490 patients had claims for a resource that indicated they experienced 1 or more infections; of those patients, 89.8% had 1 or more infection-related office visits and 25.1% had infection-related inpatient hospitalizations.<sup>21</sup> The mean total infection-related medical expenses were \$11,925 per patient during the 7-month study period.<sup>21</sup> Among the drivers of infection-related resource utilization, inpatient hospitalizations, outpatient visits, and emergency department visits were the highest cost contributors per patient (\$38,574, \$1460, and \$899, respectively).<sup>21</sup>

## CURRENT TREATMENT OPTIONS AND UNMET NEEDS

### IgG, the Main Treatment Modality for PID

Treatment of PID antibody deficiency using IgG replacement therapy is common for most patients (administered through IV or SC).<sup>2</sup> Patients with selective immunoglobulin A (IgA) deficiency and transient hypogammaglobulinemia of infancy are typically not treated with IgG replacement therapy.<sup>2</sup> IgG replacement therapy contains purified pooled plasma with a broad spectrum of antibodies from multiple individuals (10,000-50,000).<sup>6</sup> It is a lifelong therapy that requires repeat doses of IgG at regular intervals because the body

**Table 1.** Patient HRQOL: SF-36v2 Physical and Mental Scores for Adult Patients With PID and US General Population<sup>17a,b</sup>

Component	PID N = 18	US general Population N = 4024
Physical component	37.4	50.5 <sup>b</sup>
Limitations in physical activities because of health problems (physical function)	41.4	50.4 <sup>b</sup>
Limitations in usual role activities because of physical health problems (role physical)	34.8	50.5 <sup>b</sup>
Bodily pain	42.9	49.9 <sup>c</sup>
General health perceptions	32.5	49.9 <sup>b</sup>
Mental component	41.6	49.2 <sup>c</sup>
Vitality (ie, energy and fatigue)	38.2	49.4 <sup>c</sup>
Limitations in social activities because of physical or emotional problems (social functioning)	33.6	49.8 <sup>b</sup>
Limitations in usual role activities because of emotional problems (role emotional)	41.0	49.7 <sup>c</sup>
General mental health (ie, psychologic distress and well-being)	44.8	49.3 <sup>d</sup>

HRQOL indicates health-related quality of life; PID, primary immunodeficiency; SF, short form; SF-36v2, Short Form Health Survey, version 2.

<sup>a</sup>HRQOL scores were derived from a comparison of patients with PID versus the US general population that were age- and sex-matched.

<sup>b</sup>The SF-36v2 normative database scores were compared with normative data from the US general population and patients with other chronic conditions.

<sup>c</sup>P < .01 compared with PID patient population.

<sup>d</sup>P < .05 compared with PID sample population.

Adapted from Routes J, Costa-Carvalho BT, Grimbacher B, et al. *J Clin Immunol*. 2016;36(5):450-461. doi:10.1007/s10875-016-0279-0

**Table 2.** Comparison of the Frequent Cost-Related Adverse Events Affecting Patients with PID in the Year Before and the Year After Diagnosis<sup>19a</sup>

Infection	Average before diagnosis	Average post diagnosis
Acute infections, n	6.4	1.8
Severe infections, n	4.3	0.6
Bacterial pneumonias, n	2.8	0.6
Physician / hospital / ER visits, n	44.7	12.6
Chronic infections, n of days	44.7	12.6
Hospitalization, n of days	19.2	5.1
Antibiotics, n of days	166.2	72.9
School/work days missed, n of days	33.9	8.9

n, number; PID, primary immunodeficiency.

<sup>a</sup>A survey was sent to physician experts at 254 centers in the Jeffrey Modell Centers Network, asking them to provide the number of patients with a specific PID disease diagnosis. Physician experts were asked to determine the number of patients on immunoglobulin replacement therapy receiving intravenous immunoglobulin in the clinic or at home or treated with subcutaneous administration of immunoglobulins.

Adapted from Modell V, Gee B, Lewis DB, et al. *Immunol Res*. 2011;51(1):61-70. doi:10.1007/s12026-011-8241-y

**Table 3.** Adverse Events in 10% or More of Patients During or After IGIV-C 10% Treatment<sup>24a</sup>

Adverse event	Percentage of IGIV-treated patients
Headaches	77%
Muscle aches	45%
Fever and/or chills	40%
Increased blood pressure	16%
Anxiety	15%
Redness at infusion site	13%
Abdominal pain	13%
Swelling at infusion site	13%
Decreased blood pressure	12%
Wheezing	10%

IGIV, immunoglobulin intravenous.

<sup>a</sup>A total of 2500 patients with primary immunodeficiency diseases, who had reported either intravenous immunoglobulin therapy, or subcutaneous immunoglobulin therapy, were randomly selected from the Immune Deficiency Foundation database for this survey.

Adapted from IDF website. Published May 6, 2009. Accessed March 23, 2020. <https://primaryimmune.org/publication/surveys/treatment-experiences-and-preferences-among-patients-primary-immunodeficiency>

produces IgG from its own immune cells and IgG must be replenished periodically.<sup>6</sup> The typical half-life of IgG antibodies is about 19 to 21 days.<sup>2</sup> IGIV is administered every 3 or 4 weeks, whereas IGSC may be administered daily, weekly, or every 3 to 4 weeks depending on the specific IGSC product administered.<sup>6</sup> The dominant route of administration for IgG therapy has historically been IV<sup>22</sup>; however, more recent data show SC infusion to be an acceptable form of therapy for patients with PID.<sup>23</sup> The use of IGSC has increased from 23.0% in 2008 to 45.2% in 2013 based on IDF surveys conducted during that time.<sup>10,24</sup> Additionally, of 509 patients who switched from IGIV to IGSC, 55% of those patients reported they made the decision due to the convenience of IGSC therapy.<sup>10</sup>

IgG replacement therapy has resulted in improved in HRQOL in patients with PID administered through IV and SC.<sup>17</sup> A 12-month observational study assessed the burden of disease of PID along with impact of IgG treatment on HRQOL as measured by the SF-36v2.<sup>17</sup> Patients with PID experienced significant improvements in SF-36v2 domain score including physical role (34.7 vs 43.5;  $P = .01$ ), general health (31.2 vs 40.3;  $P = .02$ ), and social functioning (36.1 vs 44.9;  $P = .02$ ) from baseline to 12 months of IgG treatment, respectively.<sup>17</sup>

### Unmet Needs and Considerations in IgG Treatment

SC administration of IgG preparations provides another option for patients with poor venous access and a history of adverse events (AEs) to IGIV, and offers patient convenience due to at-home administration and lower infusion volume requirements.<sup>25</sup> In a 2008 survey conducted among patients with PID (N = 68), 8% reported discontinuation of IgG therapy due to safety issues or AEs.<sup>24</sup> AEs that occurred

in 10% or more of the population treated with IGIV-10% included headaches, muscle aches, abdominal pain, fever/chills, an increase or decrease in blood pressure, anxiety, redness or swelling at infusion site, and wheezing (Table 3).<sup>24</sup> In contrast, fewer systemic AEs are associated with IGSC and the majority are infusion site reactions.<sup>6</sup> The results of another study found that more IGIV-treated patients reported experiencing fatigue and with greater frequency than IGSC-treated patients (46.0% vs 28.5%, respectively).<sup>18</sup> Among the IGIV products available, there are numerous differences in product-specific formulations and features, including clinical tolerability, volume load, osmolality, sodium content, sugar content, pH, and IgA content.<sup>24,25</sup> Formulas with a higher IgG concentration require lower volume and shorter infusion time. A greater incidence of thromboembolic complications is associated with formulations with higher sodium, whereas renal failure or insufficiency is associated with higher sugar content.<sup>26</sup>

An additional consideration with IGIV treatment is the wear-off effect that can occur toward the end of the dosing cycle. Three phase 3 studies were included in a pooled analysis of patients treated with IGIV for 3 or 4 weeks. The probability of acquiring an infection significantly increased during the final cycle week—by 1.26 and 1.55 for patients on 3- and 4-week dosing schedules, respectively—compared with week 1, suggesting a wear-off effect of the drug.<sup>27</sup> Further, IgG replacement therapy only replaces circulating IgG levels and not external secretions of IgG, a factor that must be considered because infections that involve mucosal surfaces can be an issue.<sup>2</sup>

IGSC administration occurs at home, either via self-infusion or with the help of a caregiver, resulting in improvements in HRQOL and patient satisfaction versus administration of IGIV at a physician's office or a hospital.<sup>23,28</sup> Patients who received home infusions had higher HRQOL scores compared with patients who received treatment at an infusion suite.<sup>18</sup> Additionally, adults and children with PID who switched from IGIV to IGSC had improved perceptions of general health after 12 months of treatment.<sup>29</sup> Rider et al compared HRQOL in number of patients by route of IgG administration. In patients who perceived their PID to be less than adequately controlled, their mental component score of the SF-12 was higher when treated with IGSC compared with IGIV.<sup>18</sup>

The measurement of serum trough IgG levels to ensure adequate protection against infection is important when administering IgG therapy.<sup>6</sup> A meta-analysis of pneumonia rates and trough IgG levels showed that with every 100 mg/dL increment in trough IgG the rate of pneumonia incidence declined by 27%.<sup>30</sup> A clinical study measured serum trough IgG levels in patients (n = 51) during IGSC treatment and compared them with levels that were previously recorded while the patients had IGIV therapy. Mean serum trough IgG levels with IGSC were 25% to 34% higher than the recorded levels for each subject during IGIV treatment.<sup>29</sup> Therefore, serum trough IgG levels should be checked more often when a patient first starts IgG replacement therapy and then once per year after commencing therapy to determine if there are differences in the metabolism of blood levels of IgG.<sup>2</sup>

## IGSC-C 20% FOR PID

### Product Description

The FDA approved Xembify® (immune globulin subcutaneous, human—klhw) a 20% immune globulin solution for SC infusion (referred to as IGSC-C 20%) in July 2019.<sup>28,31</sup> It is indicated as a weekly SC dose for the treatment of primary humoral immunodeficiency in patients at least 2 years old. If desired, the dose may be divided into 2 to 7 infusions per week. It provides a wide spectrum of opsonizing and neutralizing IgG antibodies that fight bacterial, viral, parasitic, and mycoplasma agents and their toxins as well as antibodies able to interact and alter immune cell activity.<sup>28</sup> The product is an appropriate option for patients with risk factors, including pediatric and elderly patients, and patients with diabetes, renal dysfunction, thromboembolic risk, and/or cardiac impairment.<sup>26</sup> It has trace amounts of sodium, is sugar-free, and is close to physiologic osmolality.<sup>25,26</sup> This is achieved through a unique manufacturing process using caprylate/chromatography. Caprylate is a safe, naturally occurring fatty acid of plant origin that is used in both the purification and virus-inactivation capacity steps of the manufacturing process. This process provides at least 98% IgG protein for maximum potency and maximum purity. Caprylate/chromatography yields maximum amounts of IgG protein, maintains IgG in liquid phase, and minimizes the denaturing of the IgG protein. The final result is a ready-to-use, sterile SC infusion that can be administered at home.<sup>28</sup>

IGSC-C 20% is manufactured by Grifols, similar to IGIV-C 10%, through a combination of cold ethanol fractionation, caprylate

precipitation and filtration, and anion-exchange chromatography of plasma pooled from healthy human donors.<sup>25,32</sup> Although the plasma fractionation and caprylate purification steps are the same for IGIV-C 10% and IGSC-C 20%, there are additional steps required to refine the formulation into an IGSC-C 20%, resulting in an approximately 55% increase in manhours and production equipment time compared with that of IGIV-C 10%. The IGSC-C 20% production involves a second purification and sterilization. IGSC-C 20% was found to have a similar composition, antibody potency, and purity as IGIV-C 10%, but it utilizes a smaller volume for administration than IGIV-C 10%, which results in shorter infusion times.<sup>25,26</sup> The antibody potencies of IGSC-C 20% and IGIV-C 10% were tested for diphtheria, measles, polio, hepatitis A, hepatitis B, and parvovirus and were found to be comparable and above the US minimum requirements. In 2018, the FDA lowered the specification for measles (from  $0.48 \times$  reference to  $0.36 \times$  reference), but IGSC-C 20% still maintains the higher specification previously required.<sup>25</sup>

### Clinical Benefits

An interim pharmacokinetics (PK) analysis on 8 participants was conducted to confirm that a SC dose adjustment factor (DAF) of 1.37 was adequate and safe. The results of this analysis concluded that using an IV to SC dose-adjustment factor of 1.37, was noninferior and bioequivalent as assessed by overall serum exposure to the IV dose of IGIV-C 10% over an equal time interval; additionally, the PK outcomes were similar to those observed in studies of other IGSC products. The authors also noted that the rates of infections and serious bacterial infections were low in patients with PID treated

## INDICATION

XEMBIFY® (immune globulin subcutaneous human—klhw) is a 20% immune globulin indicated for treatment of primary humoral immunodeficiency disease (PID) in patients 2 years of age and older. XEMBIFY is for subcutaneous administration only.

## IMPORTANT SAFETY INFORMATION

### WARNING: THROMBOSIS

- **Thrombosis may occur with immune globulin products, including XEMBIFY. Risk factors may include: advanced age, prolonged immobilization, estrogens, indwelling vascular catheters, hyperviscosity, and cardiovascular risk factors. Thrombosis may occur in the absence of known risk factors**
- **For patients at risk of thrombosis, administer XEMBIFY at the minimum dose and infusion rate practicable. Ensure adequate hydration in patients before administration. Monitor for signs and symptoms of thrombosis and assess blood viscosity in patients at risk of hyperviscosity**

### Contraindications

XEMBIFY is contraindicated in patients who have had an anaphylactic or severe systemic reaction to the administration of human immune globulin. It is contraindicated in IgA-deficient patients with antibodies against IgA and a history of hypersensitivity.

### Warnings and Precautions

**Hypersensitivity.** Severe hypersensitivity reactions may occur with immune globulin products, including XEMBIFY. In case of hypersensitivity, discontinue infusion immediately and institute appropriate treatment. XEMBIFY contains IgA. Patients with known antibodies to IgA may have a greater risk of developing potentially severe hypersensitivity and anaphylactic reactions.

Please see Important Safety Information on pages 5-7, and refer to accompanying full Prescribing Information for XEMBIFY®(immune globulin subcutaneous human-klhw) 20%.

with IGSC-C 20% and comparable with those of other IgG products. Additionally, IGSC-C 20% administered in the home setting was well tolerated in both children and adults.<sup>32</sup>

The PK of IGSC-C 20% were evaluated in a phase 3, prospective, multicenter, single sequence, open-label study. The primary objective was to determine if IGSC-C 20% was inferior to IGIV-C 10% with respect to the steady-state area under the curve (AUC) of total IgG. Other objectives were to test if IGSC-C 20% replacement therapy had comparable mean steady-state trough levels of total IgG to IGIV-C 10% and to determine the safety of IGSC-C 20%. The study was divided into 5 parts: screening phase, run-in phase, IV phase, SC phase, and an end of study visit. In the run-in phase, participants who were not receiving IGIV-C 10% at 300 to 800 mg/kg per infusion every 3 to 4 weeks for 3 or more months prior to screening were allowed to reach an approximate steady-state prior to PK profiling. The IV phase served as a reference (control) phase; in the SC phase, participants received weekly SC doses of IGSC-C 20% for 24 weeks.<sup>32</sup>

Based on the PK parameters analyzed, IGSC-C 20% was found to be noninferior and bioequivalent to IGIV-C 10% (geometric least squares mean ratio [SC/IV] for steady state AUC<sub>0-7</sub> days ranged from 1.04-1.06).<sup>32</sup> Importantly, IGSC-C 20% demonstrated 33% higher trough values than IV administration; higher trough values are associated with lower rates of infection (eg, pneumonia).<sup>30,32</sup> During the IV infusion phase, the average IgG concentration rose to 2075 (396) mg/dL and decreased to 913 (192) mg/dL at the end of the 4 weeks. While in the SC phase, all participants had stable IgG levels that were maintained at greater than 580 mg/dL after SC

administration. Peak IgG levels after IGSC-C 20% infusion occurred after 76 hours, on average.<sup>32</sup>

In a population of 49 patients with PID who were administered IGSC-C 20%, results showed a lower rate of any annual infection, serious bacterial infection, number of days treated with antibiotics, number of hospitalizations due to infection, and number of days of work/school missed compared with patients administered IGIV-C 10%. The annual rate of any infections were 2.367 (95% CI 1.601-3.345) in patients treated with IGSC-C 20% compared to 2.750 (95% CI 1.937-3.764) in patients treated with IGIV-C 10%. The rate of serious bacterial infections were 0.049 (95% CI 0.020-0.098) and 0.120 (95% CI 0.051-0.232) in patients treated with IGSC-C 20% and IGIV-C 10%, respectively. The number of days on prophylactic antibiotics were lower in patients administered IGSC-C 20% (27.660 days) compared with patients treated with IGIV-C 10% (34.080 days). The number of hospitalizations were lower in patients treated with IGSC-C 20% (0.049) compared with those administered IGIV-C 10% (0.060). Lastly the number of days of work/school missed were 3.049 (95% CI 1.584-5.221) in patients treated with IGSC-20% and 2.268 (95% CI 1.055-4.174) in patients treated with IGIV-C 10%.<sup>32</sup>

### Safety

In an analysis of the safety outcomes from the IGSC-C 20% treatment group (n = 49), the majority of the AEs were mild or moderate in severity. A total of 41 patients (83.7%) experienced any grade AE in the SC phase, of which 28.6% were treatment-related AEs. The most common AEs that occurred at a rate of 5% or more in the IGSC-C 20% treatment group included infusion site reactions (infusion

## IMPORTANT SAFETY INFORMATION (continued)

### Warnings and Precautions (continued)

**Thrombosis.** Thrombosis may occur following treatment with immune globulin products, including XEMBIFY. Thrombosis may occur in the absence of known risk factors. In patients at risk, administer at the minimum dose and infusion rate practicable. Ensure adequate hydration before administration. Monitor for signs and symptoms of thrombosis and assess blood viscosity in patients at risk of hyperviscosity.

**Aseptic meningitis syndrome (AMS).** AMS may occur with human immune globulin treatment, including XEMBIFY. Conduct a thorough neurological exam on patients exhibiting signs and symptoms to rule out other causes of meningitis. Discontinuation of treatment has resulted in remission within several days without sequelae.

**Renal dysfunction/failure.** Acute renal dysfunction/failure, acute tubular necrosis, proximal tubular nephropathy, osmotic nephrosis, and death may occur with use of human immune globulin products, especially those containing sucrose. XEMBIFY does not contain sucrose. Ensure patients are not volume-depleted prior to starting infusion. In patients at risk due to preexisting renal insufficiency or predisposition to acute renal failure, assess renal function prior to the initial infusion of XEMBIFY and again at appropriate intervals thereafter. If renal function deteriorates, consider discontinuation.

**Hemolysis.** XEMBIFY may contain blood group antibodies that may cause a positive direct antiglobulin reaction and hemolysis. Monitor patients for clinical signs and symptoms of hemolysis. If signs and symptoms are present after infusion, perform confirmatory lab testing.

**Transfusion-related acute lung injury (TRALI).** Noncardiogenic pulmonary edema may occur in patients following treatment with immune globulin products, including XEMBIFY. Monitor patients for pulmonary adverse reactions. If TRALI is suspected, perform appropriate tests for the presence of antineutrophil and anti-HLA antibodies in both the product and patient serum. TRALI may be managed using oxygen therapy with adequate ventilatory support.

site erythema, pain, swelling, bruising, nodule, pruritus, induration, scab, and edema) and systemic reactions (cough and diarrhea) (Table 4).<sup>31</sup> Four patients discontinued IGSC-C 20% treatment due to infusion site nodules, infusion site discomfort, skin papules or plaques, and arthralgia or myalgia.<sup>32</sup>

## SUMMARY

PID is associated with significant morbidity and mortality, especially prior to diagnosis, primarily due to recurrent infections, leading to an overall reduction in patient HRQOL.<sup>2,17,19</sup> Most patients diagnosed with PID are treated with IgG replacement therapy, which can be administered through IV or SC methods.<sup>2</sup> SC administration is useful for patients with a history of AEs from IGIV and poor venous access.<sup>23</sup> Additionally, the SC option can be administered at home, which results in improvements in HRQOL compared with IGIV administered at a physician's office or hospital.<sup>23</sup> IGSC-C 20% is a ready-to-use, SC option that has demonstrated safety and tolerability as well as lower rates of annual infection, serious bacterial infection, number of days treated with antibiotics, number of hospitalizations due to infection, and number of days of work/school missed in patients with PID 2 years or older compared with patients treated with IGIV-C 10%.<sup>32</sup> IGSC-C 20% displayed higher trough levels than IGIV-C 10% and the higher concentration of IGSC-C 20% allows for patients to use a lower volume than other formulations, which results in shorter infusion times.<sup>25,26,32</sup> Taken together, IGSC-C 20% is an efficacious and highly purified therapeutic option for patients with PID that can be self-administered at home.<sup>28,32</sup> ●

**Table 4.** Adverse Events in at Least 5% of Patients During Infusions of IGSC-C 20%<sup>32</sup>

Adverse event <sup>a</sup>	By patient, n (%) <sup>b</sup> (n = 49 patients)	By infusion, n (rate) <sup>c</sup> (n = 1053 infusions)
All local infusion site reactions		
Erythema	19 (39%)	123 (0.117)
Pain	9 (18%)	32 (0.030)
Swelling	8 (16%)	124 (0.118)
Bruising	8 (16%)	26 (0.025)
Nodule	8 (16%)	13 (0.012)
Pruritus	5 (10%)	28 (0.027)
Induration	4 (8%)	6 (0.006)
Scab	3 (6%)	6 (0.006)
Edema	3 (6%)	5 (0.005)
Systemic adverse events		
Cough	3 (6%)	4 (0.004)
Diarrhea	3 (6%)	3 (0.003)

IGSC, immune globulin solution for subcutaneous infusion.

<sup>a</sup>Including all adverse events that occurred after the first dose of IGSC-C 20% regardless of causality, excluding infections.

<sup>b</sup>Number and percentage of patients with the adverse events.

<sup>c</sup>Rate per infusion is calculated as the total number of adverse events divided by the total number of infusions.

Adapted from Sleasman JW, Lumry WR, Hussain I, et al. *Immunotherapy*. 2019;11(16):1371-1386. doi:10.2217/imt-2019-0159

## IMPORTANT SAFETY INFORMATION (continued)

### Warnings and Precautions (continued)

**Transmissible infectious agents.** Because XEMBIFY is made from human blood, it may carry a risk of transmitting infectious agents, eg, viruses, the variant Creutzfeldt-Jakob disease (vCJD) agent, and, theoretically, the Creutzfeldt-Jakob disease (CJD) agent. No cases of transmission of viral diseases, vCJD, or CJD have ever been associated with the use of XEMBIFY.

**Interference with lab tests.** After infusion of XEMBIFY, passively transferred antibodies in the patient's blood may yield positive serological testing results, with the potential for misleading interpretation.

### Adverse Reactions

The most common adverse reactions in ≥5% of subjects in the clinical trial were local adverse reactions, including infusion-site erythema (redness), infusion-site pain, infusion-site swelling (puffiness), infusion-site bruising, infusion-site nodule, infusion-site pruritus (itching), infusion-site induration (firmness), infusion-site scab, infusion-site edema, and systemic reactions including cough and diarrhea.

### Drug Interactions

Passive transfer of antibodies may transiently interfere with the immune responses to live attenuated virus vaccines (eg, measles, mumps, rubella, and varicella).

Please see accompanying full [Prescribing Information](#) for XEMBIFY.

## REFERENCES

- Boyle JM, Buckley RH. Population prevalence of diagnosed primary immunodeficiency diseases in the United States. *J Clin Immunol*. 2007;27(5):497-502. doi:10.1007/s10875-007-9103-1
- Diagnostic & Clinical Care Guidelines for Primary Immunodeficiency Diseases*. 3rd ed. Immune Deficiency Foundation; 2015.
- Joshi AY, Iyer VN, Hagan JB, St Sauver JL, Boyce TG. Incidence and temporal trends of primary immunodeficiency: a population-based cohort study. *Mayo Clin Proc*. 2009;84(1):16-22. doi:10.1016/S0025-6196(11)60802-1
- Fernández Pérez ER, Hunter M, Katial RK. United States trends in mortality rates for primary immunodeficiency diseases. *J Allergy Clin Immunol Pract*. 2019;7(3):1045-1048. doi:10.1016/j.jaip.2018.09.030
- Seymour B, Miles J, Haeney M. Primary antibody deficiency and diagnostic delay. *J Clin Pathol*. 2005;58(5):546-547. doi:10.1136/jcp.2004.016204
- Immunoglobulin therapy & other medical therapies for antibody deficiencies. IDF website. Accessed March 1, 2020. primaryimmune.org/treatment-information/immunoglobulin-therapy
- About primary immunodeficiencies. IDF website. Accessed February 28, 2020. primaryimmune.org/about-primary-immunodeficiencies
- Bonilla FA, Khan DA, Ballas ZK, et al; Joint Task Force on Practice Parameters, representing the American Academy of Allergy, Asthma & Immunology; the American College of Allergy, Asthma & Immunology; and the Joint Council of Allergy, Asthma & Immunology. Practice parameter for the diagnosis and management of primary immunodeficiency. *J Allergy Clin Immunol*. 2015;136(5):1186-1205. e1-e78. doi:10.1016/j.jaci.2015.04.049
- McCusker C, Upton J, Warrington R. Primary immunodeficiency. *Allergy Asthma Clin Immunol*. 2018;14(suppl 2):61. doi:10.1186/s13223-018-0290-5
- 2013 IDF national immunoglobulin treatment survey. IDF website. Accessed March 10, 2020. primaryimmune.org/sites/default/files/2013\_IDF\_National\_Immunoglobulin\_Treatment\_Survey.pdf
- primary immunodeficiency diseases in America: 2007. IDF website. Published May 1, 2009. Accessed March 23, 2020. <https://primaryimmune.org/publication/surveys/primary-immunodeficiency-diseases-america-third-national-survey-patients-2007>
- Bousfiha AA, Jeddane L, Ailal F, et al. Primary immunodeficiency diseases worldwide: more common than generally thought. *J Clin Immunol*. 2013;33(1):1-7. doi:10.1007/s10875-012-9751-7
- Kobrynski L, Powell RW, Bowen S. Prevalence and morbidity of primary immunodeficiency diseases, United States 2001-2007. *J Clin Immunol*. 2014;34(8):954-961. doi:10.1007/s10875-014-0102-8
- Modell V, Orange JS, Quinn J, Modell F. Global report on primary immunodeficiencies: 2018 update from the Jeffrey Modell Centers Network on disease classification, regional trends, treatment modalities, and physician reported outcomes. *Immunol Res*. 2018;66(3):367-380. doi:10.1007/s12026-018-8996-5
- Abbott JK, Gelfand EW. Common variable immunodeficiency: diagnosis, management, and treatment. *Immunol Allergy Clin North Am*. 2015;35(4):637-658. doi:10.1016/j.jiac.2015.07.009
- Resnick ES, Moshier EL, Godbold JH, Cunningham-Rundles C. Morbidity and mortality in common variable immunodeficiency over 4 decades. *Blood*. 2012;119(7):1650-1657. doi:10.1182/blood-2011-09-377945
- Routes J, Costa-Carvalho BT, Grimbacher B, et al. Health-related quality of life and health resource utilization in patients with primary immunodeficiency disease prior to and following 12 months of immunoglobulin G treatment. *J Clin Immunol*. 2016;36(5):450-461. doi:10.1007/s10875-016-0279-0
- Rider NL, Kutac C, Hajar J, et al. Health-related quality of life in adult patients with common variable immunodeficiency disorders and impact of treatment. *J Clin Immunol*. 2017;37(5):461-475. doi:10.1007/s10875-017-0404-8
- Modell V, Gee B, Lewis DB, et al. Global study of primary immunodeficiency diseases (PI)—diagnosis, treatment, and economic impact: an updated report from the Jeffrey Modell Foundation. *Immunol Res*. 2011;51(1):61-70. doi:10.1007/s12026-011-8241-y
- Lucas M, Lee M, Lortan J, Lopez-Granados E, Misbah S, Chapel H. Infection outcomes in patients with common variable immunodeficiency disorders: relationship to immunoglobulin therapy over 22 years. *J Allergy Clin Immunol*. 2010;125(6):1354-1360.e4. doi:10.1016/j.jaci.2010.02.040
- Menzin J, Sussman M, Munsell M, Zbrozek A. Economic impact of infections among patients with primary immunodeficiency disease receiving IGIV therapy. *Clinicoecon Outcomes Res*. 2014;6:297-302. doi:10.2147/CEOR.S63200
- Chapel HM. Consensus on diagnosis and management of primary antibody deficiencies. *BMJ*. 1994;308(6928):581-585. doi:10.1136/bmj.308.6928.581
- Wasserman RL, Irani A-M, Tracy J, et al. Pharmacokinetics and safety of subcutaneous immune globulin (human), 10% caprylate/chromatography purified in patients with primary immunodeficiency disease. *Clin Exp Immunol*. 2010;161(3):518-526. doi:10.1111/j.1365-2249.2010.04195.x
- Treatment experiences and preferences among patients with primary immunodeficiency diseases national survey of patients: 2008. IDF website. Published May 6, 2009. Accessed March 23, 2020. <https://primaryimmune.org/publication/surveys/treatment-experiences-and-preferences-among-patients-primary-immunodeficiency>
- Alonso W, Vandeberg P, Lang J, et al. Immune globulin subcutaneous, human 20% solution (Xembify®), a new high concentration immunoglobulin product for subcutaneous administration. *Biologicals*. 2020;63:34-40. doi:10.1016/j.biologicals.2020.01.004
- Gelfand EW. Differences between IGIV products: impact on clinical outcome. *Int Immunopharmacol*. 2006;6(4):592-599. doi:10.1016/j.intimp.2005.11.003
- Rojavin MA, Hubsch A, Lawo J-P. Quantitative evidence of wear-off effect at the end of the intravenous IgG (IGIV) dosing cycle in primary immunodeficiency. *J Clin Immunol*. 2016;36(3):210-219. doi:10.1007/s10875-016-0243-z
- XEMBIFY® (immune globulin subcutaneous, human—klhw) 20% solution. Prescribing information. Grifols Therapeutics LLC; July 2019. <https://www.fda.gov/media/128601/download>
- Berger M, Murphy E, Riley P, Bergman GE; VIRTUE Trial Investigators. Improved quality of life, immunoglobulin G levels, and infection rates in patients with primary immunodeficiency diseases during self-treatment with subcutaneous immunoglobulin G. *South Med J*. 2010;103(9):856-863. doi:10.1097/SMJ.0b013e3181ebab6a
- Orange JS, Grossman WJ, Navickis RJ, Wilkes MM. Impact of trough IgG on pneumonia incidence in primary immunodeficiency: a meta-analysis of clinical studies. *Clin Immunol*. 2010;137(1):21-30. doi:10.1016/j.clim.2010.06.012
- BLA approval. FDA website. Published July 3, 2019. Accessed February 29, 2020. [fda.gov/media/128602/download](https://www.fda.gov/media/128602/download)
- Steasman JW, Lumry WR, Hussain I, et al. Immune globulin subcutaneous, human - klhw 20% for primary humoral immunodeficiency: an open-label, phase III study. *Immunotherapy*. 2019;11(16):1371-1386. doi:10.2217/imt-2019-0159



## HIGHLIGHTS OF PRESCRIBING INFORMATION

These highlights do not include all the information needed to use XEMBIFY safely and effectively. See full prescribing information for XEMBIFY.

XEMBIFY (immune globulin subcutaneous, human – klhw)  
20% solution

Initial U.S. Approval: 2019

**WARNING: THROMBOSIS**  
See full prescribing information for complete boxed warning.

- Thrombosis may occur with immune globulin products, including XEMBIFY. Risk factors may include: advanced age, prolonged immobilization, hypercoagulable conditions, history of venous or arterial thrombosis, use of estrogens, indwelling vascular catheters, hyperviscosity, and cardiovascular risk factors. Thrombosis may occur in the absence of known risk factors.
- For patients at risk of thrombosis, administer XEMBIFY at the minimum dose and infusion rate practicable. Ensure adequate hydration in patients before administration. Monitor for signs and symptoms of thrombosis and assess blood viscosity in patients at risk for hyperviscosity.

### INDICATIONS AND USAGE

XEMBIFY™ (immune globulin subcutaneous, human- klhw) is a 20% immune globulin solution for subcutaneous injection indicated for treatment of Primary Humoral Immunodeficiency (PI) in patients 2 years of age and older. (1)

### DOSAGE AND ADMINISTRATION

#### For subcutaneous infusion only.

Before switching to XEMBIFY, obtain the patient's serum IgG trough level to guide subsequent dose adjustments.

#### Dose (2.1)

- Switching from immune globulin intravenous (human), 10% (IVIg) to XEMBIFY: calculate the dose by using a dose adjustment factor (1.37).
- Weekly: Begin XEMBIFY one week after last IVIg infusion.
- Establish initial weekly dose by converting the monthly (or every 3 weeks) IVIg dose into an equivalent weekly dose and increasing it using a dose adjustment factor (1.37).  
$$\text{Initial weekly dose (grams)} = \frac{\text{Prior IVIg dose (in grams)}}{\text{Number of weeks between IVIg doses}} \times 1.37$$
- Frequent dosing (2-7 times per week): Divide the calculated weekly dose by the desired number of times per week.
- Switching from immune globulin subcutaneous (human) treatment (IGSC): Weekly dose (grams) should be the same as the weekly dose of prior IGSC treatment (grams).

## FULL PRESCRIBING INFORMATION: CONTENTS\*

### WARNING: THROMBOSIS

#### 1 INDICATIONS AND USAGE

#### 2 DOSAGE AND ADMINISTRATION

- 2.1 Dose
- 2.2 Preparation and Handling
- 2.3 Administration

#### 3 DOSAGE FORMS AND STRENGTHS

#### 4 CONTRAINDICATIONS

#### 5 WARNINGS AND PRECAUTIONS

- 5.1 Hypersensitivity
- 5.2 Thrombosis
- 5.3 Aseptic Meningitis Syndrome (AMS)
- 5.4 Renal Dysfunction/Failure
- 5.5 Hemolysis
- 5.6 Transfusion-Related Acute Lung Injury (TRALI)
- 5.7 Transmissible Infectious Agents
- 5.8 Interference with Laboratory Tests

#### 6 ADVERSE REACTIONS

- 6.1 Clinical Trials Experience
- 6.2 Postmarketing Experience

#### Administration (2.3)

Infusion sites: up to 6 infusion sites simultaneously, with at least 2 inches (5 cm) between sites avoiding bony prominences. Rotate sites for each administration.

### DOSAGE FORMS AND STRENGTHS

XEMBIFY is a solution containing 0.2 g/mL (200 mg/mL; 20%) protein solution for subcutaneous infusion. (3)

### CONTRAINDICATIONS

- Anaphylactic or severe systemic reactions to human immunoglobulin or inactive ingredients of XEMBIFY such as polysorbate 80. (4)
- IgA deficient patients with antibodies against IgA and a history of hypersensitivity. (4)

### WARNINGS AND PRECAUTIONS

- Hypersensitivity and anaphylactic reactions may occur. IgA deficient patients with antibodies against IgA are at greater risk of developing severe hypersensitivity or anaphylactic reactions. (5.1)
- Aseptic Meningitis Syndrome (AMS) may occur within two days of treatment. (5.3)
- Monitor for renal function in patients at risk for renal failure. (5.4)
- Hemolysis can develop. Risk factors include high doses and non-O blood group. Closely monitor for hemolysis and hemolytic anemia. (5.5)
- Monitor patients for pulmonary adverse reactions (transfusion-related acute lung injury [TRALI]). (5.6)
- XEMBIFY is made from human plasma and may carry a risk of transmitting infectious agents, e.g., viruses, the variant Creutzfeldt-Jakob disease (vCJD) agent and, theoretically, the Creutzfeldt-Jakob disease (CJD) agent. (5.7)
- Passive transfer of antibodies may confound serologic testing. (5.8)

### ADVERSE REACTIONS

The most common adverse reactions in ≥ 5% of subjects in the clinical trial were local adverse reactions including infusion site erythema (redness), infusion site pain, infusion site swelling (puffiness), infusion site bruising, infusion site nodule, infusion site pruritus (itching), infusion site induration (firmness), infusion site scab, infusion site edema, and systemic reactions including cough and diarrhea. (6.1)

To report SUSPECTED ADVERSE REACTIONS, contact Grifols Therapeutics LLC at 1-800-520-2807 or FDA at 1-800-FDA-1088 or [www.fda.gov/medwatch](http://www.fda.gov/medwatch).

### DRUG INTERACTIONS

The passive transfer of antibodies may transiently interfere with the response to live virus vaccines, such as measles, mumps, rubella, and varicella. (7.2)

### USE IN SPECIFIC POPULATIONS

Geriatric: In patients over 65 years, do not exceed the recommended dose and infuse XEMBIFY at the minimum rate practicable. (8.5)

See 17 for PATIENT COUNSELING INFORMATION and FDA approved patient labeling. Revised: 7/2019

## 7 DRUG INTERACTIONS

- 7.1 Serological Testing
- 7.2 Live Attenuated Virus Vaccines

## 8 USE IN SPECIFIC POPULATIONS

- 8.1 Pregnancy
- 8.2 Lactation
- 8.4 Pediatric Use
- 8.5 Geriatric Use

## 11 DESCRIPTION

## 12 CLINICAL PHARMACOLOGY

- 12.1 Mechanism of Action
- 12.2 Pharmacodynamics
- 12.3 Pharmacokinetics

## 13 NONCLINICAL TOXICOLOGY

- 13.1 Carcinogenesis, Mutagenesis, Impairment of Fertility
- 13.2 Animal Toxicology and/or Pharmacology

## 14 CLINICAL STUDIES

## 15 REFERENCES

## 16 HOW SUPPLIED/STORAGE AND HANDLING

## 17 PATIENT COUNSELING INFORMATION

\*Sections or subsections omitted from the full prescribing information are not listed.

**FULL PRESCRIBING INFORMATION****WARNING: THROMBOSIS**

- **Thrombosis may occur with immune globulin products, including XEMBIFY. Risk factors may include: advanced age, prolonged immobilization, hypercoagulable conditions, history of venous or arterial thrombosis, use of estrogens, indwelling central vascular catheters, hyperviscosity, and cardiovascular risk factors. Thrombosis may occur in the absence of known risk factors. [see Warnings and Precautions (5.2), Patient Counseling Information (17)]**
- **For patients at risk of thrombosis, administer XEMBIFY at the minimum dose and infusion rate practicable. Ensure adequate hydration in patients before administration. Monitor for signs and symptoms of thrombosis and assess blood viscosity in patients at risk for hyperviscosity. [see Warnings and Precautions (5.2)]**

**1 INDICATIONS AND USAGE**

XEMBIFY™ (immune globulin subcutaneous, human – klhw) is a 20% immune globulin solution for subcutaneous injection indicated for treatment of primary humoral immunodeficiency (PI) in patients 2 years of age and older. This includes, but is not limited to, congenital agammaglobulinemia, common variable immunodeficiency, X-linked agammaglobulinemia, Wiskott-Aldrich syndrome, and severe combined immunodeficiencies.<sup>1-4</sup>

**2 DOSAGE AND ADMINISTRATION****For subcutaneous infusion only.**

Before switching to XEMBIFY, obtain the patient's serum IgG trough level to guide subsequent dose adjustments.

**2.1 Dose**

Individualize the dose based on the patient's pharmacokinetic and clinical response.

Measure the patient's serum IgG trough level as early as 5 weeks after initiating XEMBIFY treatment to determine if a dose adjustment is needed.

Monitor the patient's IgG trough level every 2 to 3 months to determine subsequent dose adjustments and dosing intervals as needed (Table 1).

Doses divided over the course of a week or once weekly achieve similar exposure when administered regularly at steady-state.

For frequent dosing (2-7 times per week), divide the calculated weekly dose by the desired number of times per week.

For dose adjustments, calculate the difference (in mg/dL) of the patient's serum IgG trough level from the target IgG trough level, then find this difference in Table 1 (below). Locate the corresponding amount (in mL) by which to increase or decrease the weekly dose based on the patient's body weight. For example, if a patient with a body weight of 70 kg has an actual IgG trough level of 900 mg/dL and the target level is 1,000 mg/dL, this results in a difference of 100 mg/dL. Therefore, increase the weekly dose of subcutaneous dose by 5 mL.

The patient's clinical response should be the primary consideration in dose adjustment. If a patient on XEMBIFY does not maintain an adequate clinical response or a serum IgG trough level equivalent to that of a previous treatment, adjust the dose accordingly.

**Table 1: Adjustment (±mL) of the Weekly Subcutaneous Dose Based on the Difference (±mg/dL) From the Target Serum IgG Trough Level**

Difference From Target IgG Trough Level (mg/dL)	Body Weight (kg)												
	10	15	20	30	40	50	60	70	80	90	100	110	120
	Dose Adjustment (mL per Week)*												
50	0	1	1	1	2	2	2	3	3	3	4	4	5
100	1	1	2	2	3	4	5	5	6	7	8	8	9
150	1	2	2	3	5	6	7	8	9	10	11	13	14
200	2	2	3	5	6	8	9	11	12	14	15	17	18
250	2	3	4	6	8	9	11	13	15	17	19	21	23
300	2	3	5	7	9	11	14	16	18	20	23	25	27
350	3	4	5	8	11	13	16	19	21	24	27	29	32
400	3	5	6	9	12	15	18	21	24	27	30	33	36
450	3	5	7	10	14	17	20	24	27	31	34	38	41
500	4	6	8	11	15	19	23	27	30	34	38	42	45

\* Dose adjustment in mL is based on the slope of the serum IgG trough level response to subcutaneous administration of XEMBIFY dose increments (about 6.6 mg/dL per increment of 1 mg/kg per week).

#### Switching to XEMBIFY from IVIG

Begin treatment with XEMBIFY one week after the patient's last IVIG infusion.

Calculate the initial weekly dose of XEMBIFY. Divide the previous monthly (or every 3 weeks) IVIG dose in grams by the number of weeks between IVIG infusions, then multiply this dose by the dose adjustment factor of 1.37.

$$\text{Initial weekly dose (grams)} = \frac{\text{Prior IVIG dose (in grams)}}{\text{Number of weeks between IVIG doses}} \times 1.37$$

To convert the XEMBIFY dose (in grams) to milliliters (mL), multiply the calculated Initial SC dose (in grams) by 5.

Provided the total weekly dose is maintained, any dosing interval from daily up to weekly will achieve similar systemic IgG exposure when administered regularly at steady-state.

#### Switching to XEMBIFY from subcutaneous immune globulin (IGSC)

Administer the same weekly dose of XEMBIFY (in grams) as the weekly dose of prior IGSC treatment (in grams).

## **2.2 Preparation and Handling**

XEMBIFY is a clear to slightly opalescent, and colorless or pale yellow solution.

Visually inspect XEMBIFY for particulate matter and discoloration prior to administration, whenever solution and container permit.

Do not use if the solution is cloudy or turbid.

Do not shake.

Do not dilute.

The XEMBIFY vial is for single use only.

Do not store any vial that has been entered by a needle during preparation for infusion, punctured, partially used, or opened.

Administer within 8 hours after beginning infusion preparation (i.e., once XEMBIFY is transferred from the vial into a syringe).

Administer XEMBIFY separately from other drugs or medications that the patient may be receiving.

Do not mix XEMBIFY with other medications including immune globulins from other manufacturers.

Do not use after expiration date.

Discard unused portion.

## 2.3 Administration

### For subcutaneous infusion only.

Prior to use, allow the solution to reach ambient room temperature.

Do not shake.

Follow the steps below and use aseptic technique to administer XEMBIFY.

1. Inspect the vials: inspect for clarity, color, and expiration date(s).
2. Prepare for infusion:
  - Gather supplies: XEMBIFY vial(s), ancillary supplies, sharps container, patient's treatment diary/logbook, and the infusion pump.
  - Prepare a clean work area.
  - Wash hands.
3. Remove the protective cap from the vial to expose the central portion of the stopper.
 

*If the packaging shows any sign of tampering, do not use the product and notify Grifols Therapeutics LLC immediately [1-800-520-2807].*
4. Wipe the stopper with alcohol and allow to dry.
5. Using a sterile syringe and needle, prepare to withdraw XEMBIFY by first injecting air into the vial that is equivalent to the amount of XEMBIFY to be withdrawn. Then withdraw the desired volume of XEMBIFY. If multiple vials are required to achieve the desired dose, repeat this step. (Figure 1)
6. Use XEMBIFY as soon as practicable, within 2 hours to avoid the potential formation of particles caused by siliconized syringes.
7. Follow the manufacturer's instructions for preparing the pump and administration tubing. Be sure to prime the administration tubing to ensure that no air is left in the tubing or needle by filling the tubing/needle with XEMBIFY.
8. Select the number and location of injection sites. Rotate sites for each administration. (Figure 2)
 

Infuse XEMBIFY in the abdomen, thigh, upper arm, sides, back and/or lateral hip.

Avoid bony areas, scars, areas of inflammation, superficial infection or blood vessels.
9. Cleanse the injection site(s) with antiseptic solution using a circular motion working from the center of the site and moving to the outside. Sites should be clean, dry, and at least 2 inches (5 cm) apart. (Figure 3)
10. Grasp the skin between 2 fingers (pinch at least one inch (2.5 cm) of skin) and insert the needle at a 90-degree angle into the subcutaneous tissue. (Figure 4)
11. After inserting each needle, make sure that a blood vessel has not been accidentally entered. Attach a sterile syringe to the end of the primed administration tubing, pull back on the plunger, and if you see blood, remove and discard the needle and administration tubing. (Figure 5)
12. Repeat priming and needle insertion steps using a new needle, administration tubing and a new infusion site. Secure the needle in place by applying sterile gauze or transparent dressing over the site.
13. Infuse XEMBIFY at a maximum rate of 25 mL per hour per infusion site using up to 6 infusion sites (most patients used 4 infusion sites). Ensure that the infusion sites are at least 2 inches (5 cm) apart for patients of all ages. The number of infusion sites is at healthcare provider discretion. Children will require less total volume for a specific XEMBIFY dose (mg/kg body weight) than adults. The healthcare provider may choose a smaller volume/site for children and/or fewer infusion sites to achieve the target total dose, depending on the needs of the child. The total dose volume of XEMBIFY is divided by the desired volume (mL/site) to obtain number of infusion sites to be used.



Figure 1

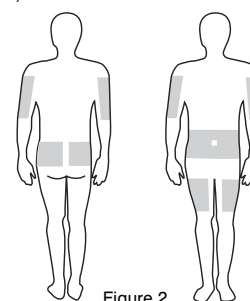

Figure 2

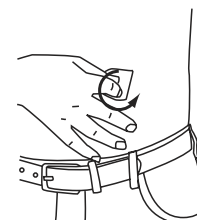

Figure 3

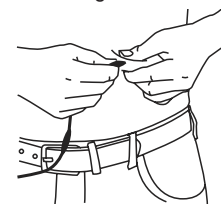

Figure 4

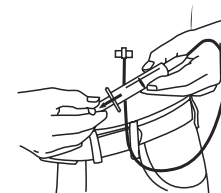

Figure 5

Volume to Be Infused SC	Rate	Number of Sites (most frequent is 4)	Site Distance Apart
25 mL per site	≤25 mL/hr/infusion site	≤6	≥2 inches (5 cm)

Record information about the infusion (e.g., lot number, expiration date, dose, date, time, infusion site location(s), side effects) in a patient treatment record or infusion log.

14. Discard the needle(s) and infusion line(s) in an appropriate container. Follow the manufacturer's instructions for storage of the infusion pump.
15. Discard partially used vial(s).

### 3 DOSAGE FORMS AND STRENGTHS

XEMBIFY is a protein solution containing 20% IgG (200 mg/ml; 0.2 g/ml) for subcutaneous infusion.

### 4 CONTRAINDICATIONS

XEMBIFY is contraindicated in:

Patients who have had an anaphylactic or severe systemic reaction to the administration of human immune globulin.

IgA deficient patients with antibodies against IgA and history of hypersensitivity to human immune globulin treatment.

### 5 WARNINGS AND PRECAUTIONS

#### 5.1 Hypersensitivity

Severe hypersensitivity reactions may occur with human immune globulin products, including XEMBIFY. If a hypersensitivity reaction occurs, discontinue the XEMBIFY infusion immediately and institute appropriate treatment.

XEMBIFY contains IgA. Patients with known anti-IgA antibodies have a greater risk of developing potentially severe hypersensitivity and/or anaphylactic reactions. XEMBIFY is contraindicated in IgA deficient patients with antibodies against IgA and history of hypersensitivity to human immune globulin treatment. *[see Contraindications (4)]*

#### 5.2 Thrombosis

Thrombosis may occur following treatment with immune globulin products, including XEMBIFY.<sup>5-7</sup> Risk factors may include: advanced age, prolonged immobilization, hypercoagulable conditions, history of venous or arterial thrombosis, use of estrogens, indwelling central vascular catheters, hyperviscosity, and cardiovascular risk factors. Thrombosis may occur in the absence of known risk factors.

Consider baseline assessment of blood viscosity in patients at risk for hyperviscosity, including those with cryoglobulins, fasting chylomicronemia/markedly high triacylglycerols (triglycerides), or monoclonal gammopathies. For patients at risk of thrombosis, administer XEMBIFY at the minimum dose and infusion rate practicable. Ensure adequate hydration in patients before administration. Monitor for signs and symptoms of thrombosis and assess blood viscosity in patients at risk for hyperviscosity. *[see Boxed Warning, Dosage and Administration (2.3), Patient Counseling Information (17)]*

#### 5.3 Aseptic Meningitis Syndrome (AMS)

AMS has been reported with the use of human immune globulin administered intravenously and subcutaneously. It usually begins within several hours to 2 days following immune globulin treatment. AMS may occur more frequently in females than in males.

AMS is characterized by the following signs and symptoms: severe headache, nuchal rigidity, drowsiness, fever, photophobia, painful eye movements, nausea and vomiting. Cerebrospinal fluid (CSF) studies frequently show pleocytosis up to several thousand cells per cubic millimeter, predominantly from the granulocytic series, and elevated protein levels up to several hundred mg/dL, but negative culture results. To rule out other causes of meningitis, conduct a thorough neurological examination on patients exhibiting such symptoms and signs, including CSF studies. AMS may occur more frequently in association with high doses (>2 g/kg) and/or rapid infusion of immune globulin products. Discontinuation of immune globulin treatment has resulted in remission of AMS within several days without sequelae.

#### 5.4 Renal Dysfunction/Failure

Acute renal dysfunction/failure, acute tubular necrosis, proximal tubular nephropathy, osmotic nephrosis and death may occur upon use of human immune globulin products, especially those containing sucrose.<sup>8,9</sup> XEMBIFY does not contain sucrose. Ensure that patients are not volume depleted prior to administration of XEMBIFY.

In patients at risk of developing renal dysfunction, including patients with any degree of preexisting renal insufficiency or predisposition to acute renal failure (such as diabetes mellitus, age greater than 65 years, volume depletion, sepsis, paraproteinemia, or patients receiving known nephrotoxic drugs), monitor renal function and consider lower, more frequent dosing. [see *Dosage and Administration (2.3)*]

Periodic monitoring of renal function and urine output is particularly important in patients judged to have a potential increased risk for developing acute renal failure. Assess renal function, including measurement of blood urea nitrogen (BUN)/serum creatinine, prior to the initial infusion of XEMBIFY and again at appropriate intervals thereafter. If renal function deteriorates, consider discontinuation of XEMBIFY. [see *Patient Counseling Information (17)*]

### 5.5 Hemolysis

IgG products, including XEMBIFY can contain blood group antibodies that may act as hemolysins and induce *in vivo* coating of red blood cells (RBCs) with immunoglobulin, causing a positive direct antiglobulin (Coombs') test result and hemolysis.<sup>10-13</sup> Delayed hemolytic anemia can develop subsequent to human immune globulin therapy due to enhanced RBC sequestration, and acute hemolysis consistent with intravascular hemolysis has been reported. [see *Adverse Reactions (6)*]

Monitor XEMBIFY recipients for clinical signs and symptoms of hemolysis, particularly patients with risk factors such as non-O blood group, or patients receiving high IgG doses ( $\geq 2$  grams/kg).<sup>14</sup> Underlying inflammatory state in an individual patient may increase the risk of hemolysis, but its role is uncertain.<sup>15</sup>

If signs and/or symptoms of hemolysis are present after XEMBIFY infusion, perform appropriate confirmatory laboratory testing.

### 5.6 Transfusion-related Acute Lung Injury (TRALI)

Noncardiogenic pulmonary edema may occur in patients following treatment with human immune globulin products.<sup>16</sup> TRALI is characterized by severe respiratory distress, pulmonary edema, hypoxemia, normal left ventricular function, and fever. Symptoms typically occur within 1 to 6 hours after treatment.

Monitor patients for pulmonary adverse reactions. If TRALI is suspected, perform appropriate tests for the presence of anti-neutrophil and anti-HLA antibodies in both the product and patient serum. TRALI may be managed using oxygen therapy with adequate ventilatory support.

### 5.7 Transmissible Infectious Agents

Because XEMBIFY is made from human blood, it may carry a risk of transmitting infectious agents, e.g., viruses, the variant Creutzfeldt-Jakob disease (vCJD) agent and, theoretically, the Creutzfeldt-Jakob disease (CJD) agent. This also applies to unknown or emerging viruses and other pathogens. No cases of transmission of viral diseases or CJD have been associated with the use of XEMBIFY. ALL infections suspected by a physician to have possibly been transmitted by XEMBIFY should be reported by the physician or other healthcare provider to Grifols Therapeutics LLC [1-800-520-2807].

### 5.8 Interference with Laboratory Tests

After infusion with XEMBIFY, the transitory rise of various passively transferred antibodies in the patient's blood may yield false-positive serological testing results, with the potential for misleading interpretation. Passive transmission of antibodies to erythrocyte antigens (e.g., A, B, and D) may cause a positive direct or indirect antiglobulin (Coombs') test.

## 6 ADVERSE REACTIONS

The most common adverse reactions in  $\geq 5\%$  of subjects in the clinical trial were local adverse reactions including infusion site erythema (redness), infusion site pain, infusion site swelling (puffiness), infusion site bruising, infusion site nodule, infusion site pruritus (itching), infusion site induration (firmness), infusion site scab, infusion site edema, and systemic reactions including cough and diarrhea.

### 6.1 Clinical Trials Experience

Because clinical studies are conducted under widely varying conditions, adverse reaction rates observed in the clinical trials of one drug cannot be directly compared to rates in other clinical trials of another drug and may not reflect the rates observed in clinical practice.

Clinical safety data are based on an open-label, single-arm prospective multi-center study of 49 subjects with primary immunodeficiency (PI) who received subcutaneous XEMBIFY (immune globulin subcutaneous, human-klhw) for at least 6 months.

A total of 49 subjects received 1053 XEMBIFY infusions, including 14 subjects between 2 to 16 years of age during the clinical trial. The average number of infusions per subject was 21.5 infusions, median 24 infusions (range 1-26 infusions). There were a total of 390 local infusion site reactions which occurred at a rate per infusion of 0.370 (about 1 in 2.7 infusions). Of these, the most common was infusion site erythema which had a median duration of 24.9 hours. Infusion site swelling, and infusion site pain had median durations of 24.5 and 22.8 hours, respectively. Local infusion site reactions of all kinds by site of infusion (where site of infusion was recorded) occurred in 50.0% and 52.6% of patients during infusions in the abdomen versus thigh, respectively, and across 773 abdominal infusions and 279 thigh infusions rates were 0.184 and 0.735 per infusion, respectively; this corresponds to 1 in 5.4 infusions (for abdomen) and 1 in 1.4 infusions (for thigh). No local infusion site reactions were severe or serious.

The adverse reactions occurring in  $\geq 5\%$  of subjects on XEMBIFY in the clinical trial for the duration of the subcutaneous (SC) phase are depicted in the table below which includes all treatment-emergent adverse reactions except infections.

**Table 2: Adverse Reactions in  $\geq 5\%$  of Subjects During Infusions of XEMBIFY**

Adverse Reaction*	By Subject n (%) <sup>†</sup> (N=49 subjects)	By Infusion n (rate) <sup>‡</sup> (N=1053 infusions)
Infusion site erythema	19 (39%)	123 (0.117)
Infusion site pain	9 (18%)	32 (0.030)
Infusion site swelling	8 (16%)	124 (0.118)
Infusion site bruising	8 (16%)	26 (0.025)
Infusion site nodule	8 (16%)	13 (0.012)
Infusion site pruritus	5 (10%)	28 (0.027)
Infusion site induration	4 (8%)	6 (0.006)
Infusion site scab	3 (6%)	6 (0.006)
Infusion site edema	3 (6%)	5 (0.005)
Cough	3 (6%)	4 (0.004)
Diarrhea	3 (6%)	3 (0.003)

\* Including all adverse reactions that occurred after the first dose of XEMBIFY regardless of causality, excluding infections.

† Number and percentage of subjects with the adverse reaction.

‡ Rate per infusion is calculated as the total number of adverse reactions divided by the total number of infusions.

Four subjects discontinued XEMBIFY due to adverse reactions which were infusion site nodules, infusion site discomfort, skin papules/plaques, and arthralgia/myalgia.

## 6.2 Postmarketing Experience

Because postmarketing reporting of adverse reactions is voluntary and from a population of uncertain size, it is not always possible to reliably estimate the frequency of these reactions or establish a causal relationship to product exposure.

The following adverse reactions have been identified and reported during the postmarketing use of immune globulin products administered subcutaneously:

Cardiac disorders: Tachycardia

Nervous system disorders: Tremor and paresthesia

Respiratory, thoracic and mediastinal disorders: Dyspnea and laryngospasm

## 7 DRUG INTERACTIONS

### 7.1 Serological Testing

Various passively transferred antibodies in immunoglobulin preparations, including XEMBIFY, can confound the results of serological testing.

### 7.2 Live Attenuated Virus Vaccines

Passive transfer of antibodies may transiently interfere with the immune response to live virus vaccines such as measles, mumps, rubella and varicella. Inform the immunizing healthcare provider of recent therapy with XEMBIFY so that appropriate measures may be taken.

## 8 USE IN SPECIFIC POPULATIONS

### 8.1 Pregnancy

#### Risk Summary

No human data are available to indicate the presence or absence of drug associated risk. Animal reproduction studies have not been conducted with XEMBIFY. It is not known whether XEMBIFY can cause fetal harm when administered to a pregnant woman or can affect reproduction capacity. Immune globulins cross the placenta from maternal circulation increasingly after 30 weeks of gestation. In the U.S. general population, the estimated background risk of major birth defect and miscarriage in clinically recognized pregnancies is 2-4% and 15-20%, respectively.

### 8.2 Lactation

#### Risk Summary

No human data are available to indicate the presence or absence of drug associated risk. The developmental and health benefits of breastfeeding should be considered along with the mother's clinical need for XEMBIFY and any potential adverse effects on the breastfed infant from XEMBIFY or from the underlying maternal condition.

### 8.4 Pediatric Use

XEMBIFY was evaluated in 14 pediatric subjects with PI (2-16 years of age) in a multi-center clinical trial. The safety and efficacy profiles were similar to adult subjects. No pediatric-specific dose requirements were necessary to achieve the desired serum IgG levels.

Safety and effectiveness of XEMBIFY in pediatric patients below 2 years of age have not been established.

### 8.5 Geriatric Use

Clinical studies of XEMBIFY did not include sufficient numbers of subjects over age 65 years to determine whether they respond differently from younger subjects. Three study subjects enrolled in the clinical trial were 65 years and older. In general, dose selection for an elderly patient should be cautious, usually starting at the low end of the dosing range, reflecting the greater frequency of decreased hepatic, renal, or cardiac function, and of concomitant disease or other drug therapy.

## 11 DESCRIPTION

XEMBIFY, immune globulin subcutaneous, human-klhw, is a 20% ready-to-use sterile, non-pyrogenic solution of human immune globulin protein for subcutaneous administration. The purity is  $\geq 98\%$  IgG with a sub-class distribution similar to that found in normal serum.

XEMBIFY consists of 18% to 22% protein in 0.16 M to 0.26 M glycine and 10 to 40 mcg/mL polysorbate 80 at a pH of 4.1 to 4.8. The solution is clear to slightly opalescent, and colorless or pale yellow. The osmolality range is 280 to 404 mOsmol/kg. XEMBIFY contains no preservative and is not made with natural rubber latex.

XEMBIFY is made from large pools of human plasma by a combination of cold ethanol fractionation, caprylate precipitation and filtration, and anion-exchange chromatography. Isotonicity is achieved by the addition of glycine. XEMBIFY is incubated in the final container (at the low pH of 4.1 to 4.8).

The capacity of the manufacturing process to remove and/or inactivate enveloped and non-enveloped viruses has been validated by laboratory spiking studies on a scaled down process model, using the following enveloped and non-enveloped viruses: human immunodeficiency virus, type I (HIV-1) as the relevant virus for HIV-1 and HIV-2; bovine viral diarrhea virus (BVDV) as a model for hepatitis C virus; pseudorabies virus (PRV) as a model for large enveloped DNA viruses (e.g. herpes viruses); West Nile Virus (WNV) as a relevant virus; Reovirus type 3 (Reo) as a model for non-enveloped viruses and for its resistance to physical and chemical inactivation; hepatitis A virus (HAV) as relevant non-enveloped virus, and porcine parvovirus (PPV) as a model for human parvovirus B19.

Overall virus clearance capacity was calculated only from steps that were mechanistically independent from each other and truly additive. In addition, each step was verified to provide robust virus reduction across the production range for key parameters.



**Table 3: Summary of Virus Clearance Capacity (Log<sub>10</sub>)**

Process Step	Enveloped Viruses				Non-enveloped Viruses		
	HIV-1	BVDV	PRV	WNV	Reo3	HAV	PPV
Caprylate Precipitation/ Depth Filtration	C/I*	2.7	C/I*	C/I*	≥3.5	≥3.6	4.0
Caprylate Incubation†	≥4.5	≥4.5	≥4.6	≥5.1	NA‡	NA‡	NA‡
Column Chromatography	≥3.0	4.0	≥3.3	ND§	≥4.0	≥1.4	4.2
Nanofiltration	≥3.7	≥4.1	ND§	ND§	≥1.8	ND§	0.5
Low pH Final Container Incubation	≥5.3	4.9	≥5.1	≥5.3	NA‡	NA‡	NA‡
<b>Overall Clearance Capacity</b>	<b>≥16.5</b>	<b>≥20.2</b>	<b>≥13.0</b>	<b>≥10.4</b>	<b>≥9.3</b>	<b>≥5.0</b>	<b>8.2</b>

\* C/I: Interference by caprylate precluded determination of virus clearance capacity for this step.

† DHBV and SINV were also evaluated for the caprylate incubation step. The log<sub>10</sub> clearance capacities were ≥3.6 and ≥6.0, respectively.

‡ NA = Not applicable: This step is not applicable to non-enveloped viruses.

§ Due to interfering effects of the process intermediate matrix the virus clearance capacity could not be determined.

Additionally, the manufacturing process was investigated for its capacity to decrease the infectivity of an experimental agent of transmissible spongiform encephalopathy (TSE), considered as a model for the variant Creutzfeldt-Jakob disease (vCJD), and Creutzfeldt-Jakob disease (CJD) agents.

Several of the individual production steps of the manufacturing process have been shown to decrease TSE infectivity of an experimental model agent. TSE reduction steps include depth filtrations (a total of ≥ 6.6 log<sub>10</sub>). These studies provide reasonable assurance that low levels of vCJD/CJD agent infectivity, if present in the starting material, would be removed.

## 12 CLINICAL PHARMACOLOGY

### 12.1 Mechanism of Action

XEMBIFY supplies a broad spectrum of opsonizing and neutralizing immunoglobulin G (IgG) antibodies against bacterial, viral, parasitic, and mycoplasmal agents and their toxins. XEMBIFY also contains a spectrum of antibodies capable of interacting with and altering the activity of cells of the immune system. The role of these antibodies and the mechanism of action of XEMBIFY are not fully understood.

### 12.2 Pharmacodynamics

Human normal immunoglobulin contains mainly (IgG) with a broad spectrum of antibodies against infectious agents. Human normal immunoglobulin contains the IgG antibodies present in the normal population. XEMBIFY has a distribution of IgG subclasses closely proportional to that in native human plasma. Adequate doses of XEMBIFY may restore abnormally low IgG levels to the normal range.

### 12.3 Pharmacokinetics

Pharmacokinetic (PK) parameters of subcutaneously administered XEMBIFY were evaluated in subjects with primary immunodeficiency (PI) during a clinical trial. [see *Clinical Studies (14)*] Subjects were treated intravenously with a comparator product [GAMUNEX-C®, immune globulin injection (human), 10% caprylate/chromatography purified] during a 3-4 months run-in period prior to IV PK profiling in 50 subjects, and then 49 subjects switched to weekly subcutaneous infusions of XEMBIFY for 24 weeks at 137% of the intravenous dose with PK profiling at SC Week #13-14. A comparison of the area under the curve (AUC) for subcutaneous versus intravenous infusion was performed.

At this dose adjustment, the geometric least-squares means ratio of the AUC for subcutaneous XEMBIFY versus IV administration of GAMUNEX-C was 104% (90% CI: 100%-107%). The peak IgG level occurred at a mean of 76 hours after subcutaneous XEMBIFY administration. The average mean IgG trough level at steady state was higher with XEMBIFY (1245 mg/dL) compared with IV GAMUNEX-C (957 mg/dL) (average mean trough ratio SC/IV of 1.3). PK parameters of XEMBIFY are summarized in Table 4. PK parameters did not significantly differ between age groups (Table 5).

**Table 4: PK Parameters of Total IgG at Steady-State in IV and SC Phases (PK Population) in Children and Adults**

Phase	Statistics	AUC <sub>(0-7 days)</sub> (h*mg/mL)*	C <sub>max</sub> (mg/mL)	t <sub>max</sub> (hour)
IV	n	49	49	49
	Mean±SD	2122±418	22±4	5.814
	CV%	20	20	
SC	n	39	41	41
	Mean±SD	2183±481	14±3	76±36
	CV%	22	22	47
	Min, Max	1027, 3675	6, 23	0, 168 <sup>†</sup>

\* AUC<sub>(0-7 days)</sub> in the IV Phase is calculated as AUC<sub>(0-21 days)</sub>/3 for subjects on an every-3-week IV dosing schedule (n=6), and as AUC<sub>(0-28 days)</sub>/4 for subjects on an every-4-week IV dosing schedule (n=43).

† The apparent variability in t<sub>max</sub> in the SC Phase can be attributed to the low fluctuation in IgG concentrations and is unlikely to be of any clinical relevance.

**Table 5: Steady-State PK Parameters for XEMBIFY by Age**

Age Group (years)	Statistics	AUC <sub>(0-7 days)</sub> (h*mg/mL)*	C <sub>max</sub> (mg/mL)	Mean Trough (mg/mL)	t <sub>max</sub> (hour)
2 -5 (n)		1	1	1	1
	Mean±SD	1839±NC*	11±NC*	11± NC*	72±NC*
>5 -12 (n)		5	5	6	5
	Mean±SD	2156±276	14±2	12±2	71±26
	CV%	13	13	15.3	37.16
	Min, Max	1878, 2456	12, 16	10, 15	28.2, 100.8
>12 -16 (n)		4	5	5	5
	Mean±SD	2400±406	15±3	14±2	73±50
	CV%	17	18	15.2	68.44
	Min, Max	2056, 2987	13, 20	11, 17	23.7, 143.1
>16 (n)		29	30	32	30
	Mean±SD	2170±524	14±3	12±3	78±36
	CV%	24	24	23.9	46.66
	Min, Max	1027, 3675	6, 23	7, 20	0.00, 167.7

\* NC = Not calculated

## 13 NONCLINICAL TOXICOLOGY

### 13.1 Carcinogenesis, Mutagenesis, Impairment of Fertility

No nonclinical studies were conducted to evaluate the carcinogenic or mutagenic effects of XEMBIFY or its effects on fertility.

### 13.2 Animal Toxicology and/or Pharmacology

Single and repeated dose toxicology studies were conducted in male New Zealand White rabbits. In a single-dose toxicity study, no adverse effects were observed with subcutaneous dose levels of 500, 1000 and 1500 mg/kg. In a repeated-dose toxicity study, the systemic safety and toxicity profiles of XEMBIFY and comparator GAMUNEX-C were similar following 5 consecutive daily subcutaneous doses at levels of 500, 1000 and 1500 mg/kg/day. Transient local injection site swelling was observed in XEMBIFY but not in the GAMUNEX-C groups.

In improper delivery route studies, XEMBIFY administered as a single intravenous, intra-arterial or perivascular dose of 100 mg/kg caused injection site irritation in New Zealand White rabbits. The findings were of higher incidence following perivascular administration of either XEMBIFY or GAMUNEX-C, and were within the norms of this route of administration in this species.

## 14 CLINICAL STUDIES

Study 1 was a prospective, open-label single-arm, multi-center clinical trial designed to evaluate pharmacokinetics and safety of XEMBIFY as compared to GAMUNEX-C. Efficacy was based on annualized serious bacterial infection (SBI) rate during the 6 months on XEMBIFY. The GAMUNEX-C run-in phase prior to XEMBIFY (subcutaneous phase) lasted 3 or 4 months to achieve steady state prior to pharmacokinetic profiling. The definition of SBI was either bacteremia/sepsis, bacterial meningitis, bacterial pneumonia, osteomyelitis/septic arthritis, or visceral abscess.

This clinical trial determined the safety and pharmacokinetics of XEMBIFY in 53 adult and pediatric subjects with PI (9.4% Hispanic or Latino; 90.6% White, 3.8% Black or African American, 5.7% American Indian or Alaskan Native). During the run-in and IV GAMUNEX-C phases 4 subjects discontinued (1 lost to follow-up, 2 withdrawal by subject, 1 adverse event). XEMBIFY was administered to a total of 49 subjects (14 children aged 2 to ≤ 16 years and 35 adults) with a mean ± SD dose of 179 ± 45 mg/kg/week for a median treatment duration of 24 weeks and mean ± SD of 21.6 ± 6.5 weeks. The median dose was 171 mg/kg/week and the range of doses was 71 mg/kg/week to 276 mg/kg/week. The total exposure of XEMBIFY was 20.28 subject-years and 1053 infusions.

Study 2 is an ongoing study in which XEMBIFY is being administered for 1 year and is being conducted in the European Union and Australia. A total of 61 subjects including 29 children were enrolled. The interim safety data in adult and pediatric study subjects appear consistent with the safety results of the clinical trial in Study 1.

The rate of serious bacterial infections (SBIs) which was an exploratory endpoint in Study 1, was 0.05 events per subject-year (1 event in 20 subject-years) (upper 99% confidence limit: 0.11) during XEMBIFY treatment. This annual rate was lower than 1.0 SBI/subject-year, the threshold specified as effective.

The summary of infections and associated events for subjects during subcutaneous treatment with XEMBIFY is summarized in Table 6.

**Table 6: Summary of Infections and Associated Events on XEMBIFY in Study 1**

Parameters	Results
Number of Subjects (efficacy period)	49
Total number of subject days on treatment	7,407
Total number of subject-years on treatment	20.28
<b>Infections</b>	
Annual rate of SBIs* (per subject-year)	0.05 (95% CI: 0.02 - 0.10)
Annual rate of infections of any kind (per subject-year)	2.4 (95% CI: 1.6 - 3.3)
Days on antibiotics (prophylactic) (rate per subject-year)	27.7 (95% CI: 13.6 - 49.0)
Days on antibiotics (therapeutic) (rate per subject-year)	28.9 (95% CI: 17.3 - 44.8)
Days missed work/school/unable to perform normal daily activities due to infections (rate per subject-year)	2.3 (95% CI: 1.1 - 4.2)
Hospitalizations due to infections (rate per subject-year)	0.05 (95% CI: 0.02 - 0.10)

\* Serious bacterial infections included bacteremia/sepsis, bacterial meningitis, bacterial pneumonia, osteomyelitis/septic arthritis, or visceral abscess.

**15 REFERENCES**

1. Buckley RH, Schiff RI. The use of intravenous immune globulin in immunodeficiency diseases. *N Engl J Med* 1991;325(2):110-7.
2. Cunningham-Rundles C, Bodian C. Common variable immunodeficiency: clinical and immunological features of 248 patients. *Clin Immunol* 1999;92(1):34-48.
3. Pruzanski W, Sussman G, Dorian W, et al. Relationship of the dose of intravenous gammaglobulin to the prevention of infections in adults with common variable immunodeficiency. *Inflammation* 1996;20(4):353-9.
4. Stephan JL, Vlekova V, Le Deist F, et al. Severe combined immunodeficiency: a retrospective single-center study of clinical presentation and outcome in 117 patients. *J Pediatr* 1993;123(4):564-72.
5. Dalakas MC. High-dose intravenous immunoglobulin and serum viscosity: risk of precipitating thromboembolic events. *Neurology* 1994;44:223-6.
6. Woodruff RK, Grigg AP, Firkin FC, et al. Fatal thrombotic events during treatment of autoimmune thrombocytopenia with intravenous immunoglobulin in elderly patients. *Lancet* 1986;2:217-8.
7. Wolberg AS, Kon RH, Monroe DM, et al. Coagulation factor XI is a contaminant in intravenous immunoglobulin preparations. *Am J Hematol* 2000;65:30-4.
8. Cayco AV, Perazella MA, Hayslett JP. Renal insufficiency after intravenous immune globulin therapy: a report of two cases and an analysis of the literature. *J Am Soc Nephrol* 1997;8(11):1788-94.
9. Pierce LR, Jain N. Risks associated with the use of intravenous immunoglobulin. *Trans Med Rev* 2003;17:241-51.
10. Copelan EA, Strohm PL, Kennedy MS, et al. Hemolysis following intravenous immune globulin therapy. *Transfusion* 1986;26:410-2.
11. Thomas MJ, Misbah SA, Chapel HM, et al. Hemolysis after high-dose intravenous Ig. *Blood* 1993;15:3789.
12. Wilson JR, Bhoopalam N, Fisher M. Hemolytic anemia associated with intravenous immunoglobulin. *Muscle & Nerve* 1997;20:1142-5.
13. Kessary-Shoham H, Levy Y, Shoenfeld Y, et al. In vivo administration of intravenous immunoglobulin (IVIg) can lead to enhanced erythrocyte sequestration. *J Autoimmun* 1999;13:129-35.
14. Kahwaji J, Barker E, Pepkowitz S, et al. Acute hemolysis after high-dose intravenous immunoglobulin therapy in highly HLA sensitized patients. *Clin J Am Soc Nephrol* 2009;4:1993-7.
15. Daw Z, Padmore R, Neurath D, et al. Hemolytic transfusion reactions after administration of intravenous immune (gamma) globulin: A case series analysis. *Transfusion* 2008;48:1598-601.
16. Rizk A, Gorson KC, Kenney L, et al. Transfusion-related acute lung injury after the infusion of IVIG. *Transfusion* 2001;41:264-8.

**16 HOW SUPPLIED/STORAGE AND HANDLING**

XEMBIFY is supplied in 1, 2, 4, and 10 gram single use vials.

<b>Package NDC Number</b>	<b>Container NDC Number</b>	<b>Size</b>	<b>Gram Protein</b>
13533-810-05	13533-810-06	5 ml	1
13533-810-10	13533-810-11	10 ml	2
13533-810-20	13533-810-21	20 ml	4
13533-810-50	13533-810-51	50 ml	10

Components used in the packaging are not made with natural rubber latex and contains no preservative.

Store XEMBIFY at 2–8°C (36–46°F).

Note: XEMBIFY may be stored at temperatures not to exceed 25°C (77°F) for up to 6 months any time prior to the expiration date. Following 25°C (77°F) storage, use the product immediately or discard.

Do not freeze.

Do not use solutions that have been frozen.

Do not use after expiration date.

Discard unused portion.

## 17 PATIENT COUNSELING INFORMATION

Advise the patient to read the FDA-approved patient labeling (Information for Patients).

Ask about a history of IgA deficiency, and hypersensitivity reactions to immune globulin treatment. *[see Warnings and Precautions (5.1)]*

Inform patients to immediately report the following signs and symptoms to their healthcare provider: *[see Boxed Warning and Warnings and Precautions]*

Hypersensitivity reaction including hives, generalized urticaria, tightness of the chest, wheezing, low blood pressure, and anaphylaxis *[see Warnings and Precautions (5.1)]*

Symptoms of thrombosis which may include: pain and/or swelling of an arm or leg with warmth over the affected area, discoloration of an arm or leg, unexplained shortness of breath, chest pain or discomfort that worsens on deep breathing, unexplained rapid pulse, numbness or weakness on one side of the body *[see Warnings and Precautions (5.2)]*

Severe headache, neck stiffness, drowsiness, fever, sensitivity to light, painful eye movements, nausea, and vomiting *[see Warnings and Precautions (5.3)]*

Decreased urine output, sudden weight gain, fluid retention/edema, and/or shortness of breath *[see Warnings and Precautions (5.4)]*

Increased heart rate, fatigue, yellowing of the skin or eyes, and dark-colored urine *[see Warnings and Precautions (5.5)]*

Trouble breathing, chest pain, blue lips or extremities, and fever *[see Warnings and Precautions (5.6)]*

Inform patients/caregivers that because XEMBIFY is made from human blood, it may carry a risk of transmitting infectious agents, e.g., viruses, the variant Creutzfeldt-Jakob disease (vCJD) agent and, theoretically, the Creutzfeldt-Jakob disease (CJD) agent. *[see Warnings and Precautions (5.7)]*

Inform patients that XEMBIFY can interfere with their immune response to live virus vaccines such as measles, mumps, rubella, and varicella. Inform patients to notify their healthcare provider of this potential interaction when they are receiving vaccinations. *[see Drug Interactions (7.2)]*

### Self-administration

Advise the patient to read the FDA-approved patient labeling (Information for Patients).

If self-administration is deemed appropriate by the healthcare provider, provide clear instructions and training on subcutaneous infusion to the patient/caregiver, and document demonstration of their ability to independently administer subcutaneous infusions.

Ensure the patient/caregiver understands the importance of consistent subcutaneous infusions to maintain appropriate steady IgG levels.

Tell the patient/caregiver to start the infusion promptly after withdrawing XEMBIFY into the syringe. Ensure the patient/caregiver understands that administration should be completed within 2 hours to avoid the potential formation of particles caused by siliconized syringes.

Instruct patient to rotate infusion sites for subsequent infusions.

Instruct the patient/caregiver to keep a treatment diary/log book. This diary/log book should include information about each infusion such as, the time, date, dose, lot number(s), infusion sites, and any reactions.

Inform the patient that mild to moderate local infusion site reactions (e.g., pain, redness and itching) are a common side effect of subcutaneous treatment, but to contact their healthcare provider if a local reaction increases in severity or persists for more than a few days.

Instruct patient to return to the healthcare facility for evaluation at regular intervals so IgG levels can be checked in order to ensure IgG trough levels are adequate.

Manufactured by:

**GRIFOLS**

**Grifols Therapeutics LLC**

Research Triangle Park, NC 27709 USA

U.S. License No. 1871

3054808

Revised 7/2019

**INFORMATION FOR PATIENTS**  
**XEMBIFY™**  
**(immune globulin subcutaneous, human-klhw)**  
**20% solution**

The following summarizes important information about XEMBIFY (zem-ba-fi). Please read this information carefully before using this medicine. This patient information does not take the place of talking with your healthcare provider about your medical condition or your treatment, and it does not include all of the important information about XEMBIFY. If you have any questions after reading this, contact your healthcare provider.

**What is XEMBIFY?**

XEMBIFY is a ready-to-use, liquid medicine that contains immunoglobulin G (IgG) antibodies, which protect the body against infection. XEMBIFY is used to treat patients with primary immunodeficiency disease (PI).

There are many forms of PI. The most common types of PI result in an inability to make a very important type of protein called antibodies, which help the body fight off infections from bacteria or viruses. XEMBIFY is made from human plasma that is donated by healthy people. It contains antibodies collected from these healthy people that replace the missing antibodies in PI patients.

**Who should NOT take XEMBIFY?**

Do not use XEMBIFY if you have a known history of severe allergic reaction to immune globulin (human) or other blood products. If you have such a history, discuss this with your healthcare provider to determine if XEMBIFY is right for you.

Tell your healthcare provider if you have or ever had:

- a serious reaction to other medicines that contain immune globulin.
- an immunoglobulin A (IgA) deficiency.
- a history of heart or blood vessel disease.
- blood clots or “thick blood”.
- inability to move for some time.

**How should I take XEMBIFY?**

XEMBIFY is given under the skin (subcutaneously). Most of the time, infusions under the skin are given at home by self-infusion or by infusion with a caregiver’s help. Self-infusion is different from giving yourself a shot.

Instructions for taking XEMBIFY are at the end of this patient information. [see “Instructions for Use”] Only use XEMBIFY by yourself after you have been instructed by your healthcare provider.

**What should I tell my healthcare provider before using XEMBIFY?**

Tell your healthcare provider if you have had a serious reaction to other medicines that contain immune globulin. Also tell your healthcare provider if you have an immunoglobulin A (IgA) deficiency.

XEMBIFY can make certain types of vaccines (like measles/mumps/rubella or chickenpox) not work as well for you. Before you get a vaccine, tell the healthcare provider that you are taking XEMBIFY.

Tell your healthcare provider if you are pregnant or plan to become pregnant, or if you are nursing.

**What are possible or reasonably likely side effects of XEMBIFY?**

The most common side effects with XEMBIFY are:

- Infusion site reactions, including but not limited to
  - infusion site erythema (redness)
  - infusion site pain
  - infusion site swelling (puffiness)
  - infusion site bruising
  - infusion site nodule
  - infusion site pruritus (itching)
  - infusion site induration (firmness)
  - infusion site scab
  - infusion site edema

Cough

Diarrhea

If any of the following problems occur after starting treatment with XEMBIFY, stop the infusion immediately and contact your healthcare provider or call emergency services. These could be signs of a serious problem.

Hives, swelling in the mouth or throat, itching, trouble breathing, wheezing, fainting or dizziness. These could be signs of a serious allergic reaction.

Bad headache with nausea, vomiting, stiff neck, fever, and sensitivity to light. These could be signs of irritation of the lining around your brain.

Reduced urination, sudden weight gain, or swelling in your legs. These could be signs of a kidney problem.

Pain, swelling, warmth, redness, or a lump in your legs or arms. These could be signs of a blood clot.

Brown or red urine, fast heart rate, yellow skin or eyes. These could be signs of a liver problem or a blood problem.

Chest pain or trouble breathing, or blue lips or extremities. These could be signs of a serious heart or lung problem.

Severe headache, stiff neck, fatigue, fever, sensitivity to light, painful eye movements, nausea and vomiting. These could be signs of a type of brain inflammation called aseptic meningitis.

Fever over 100°F (37.8°C). This could be a sign of an infection.

Tell your healthcare provider about any side effects that concern you. You can ask your healthcare provider to give you the full prescribing information available to healthcare providers. You are encouraged to report side effects to Grifols Therapeutics LLC [1-800-520-2807].

**How do I store XEMBIFY?**

XEMBIFY comes in single use vials.

- Keep XEMBIFY refrigerated. Do not freeze.
- If needed, you can store XEMBIFY at room temperature for up to 6 months, but you must use it within that time or you must throw it away.
- Do not return XEMBIFY to the refrigerator if it was warmed to room temperature.
- Check the expiration date on the carton and vial label.
- Do not use XEMBIFY after the expiration date.

**What else should I know about XEMBIFY?**

Do not use XEMBIFY for a medical condition for which it was not prescribed. Do not share XEMBIFY with other people, even if they have the same diagnosis and symptoms that you have.

## INSTRUCTIONS FOR USE

Infuse XEMBIFY only after you have been trained by your healthcare provider. Below are step-by-step instructions to help you remember how to use XEMBIFY. Ask your healthcare provider about any instructions you do not understand.

### **Before Using XEMBIFY**

Prior to use, allow the solution to come to room temperature (68-77°F or 20-25°C). This can take 60 minutes or longer.

Do not apply heat or place in the microwave.

#### Step 1: Assemble supplies

Gather the XEMBIFY vial(s), ancillary supplies, sharps container, patient's treatment diary/logbook, and the infusion pump.

#### Step 2: Clean surface

Set up your infusion area on a clean, flat, non-porous surface, such as a kitchen counter.

Avoid using porous surfaces such as wood. Clean the surface with an alcohol wipe using a circular motion from the center outward.

#### Step 3: Wash hands

Wash and dry your hands thoroughly before using XEMBIFY.

Your healthcare provider may recommend that you use antibacterial soap or that you wear gloves.

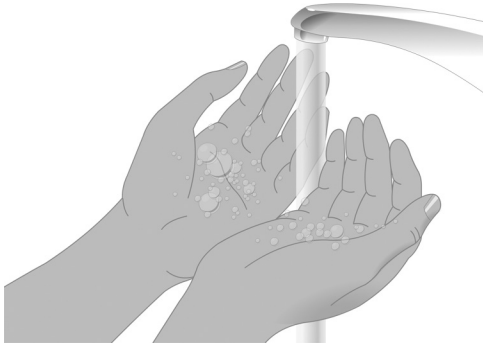

#### Step 4: Check vials

The liquid in the vial should be clear to slightly opalescent, and colorless or pale yellow.

Do not use the vial if:

- the solution is cloudy or discolored. The solution should be clear to slightly opalescent, and colorless or pale yellow.
- the protective cap is missing, or there is any evidence of tampering. Tell your healthcare provider immediately.
- the expiration date has passed.

#### Step 5: Remove the protective cap

Remove the protective cap from the vial to expose the middle of the stopper.

Wipe the stopper with alcohol and allow to dry.

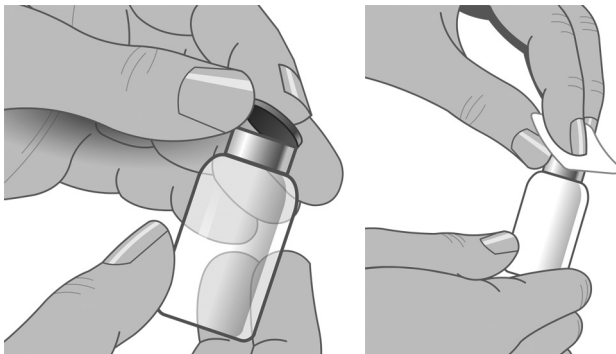



**Step 6: Transfer XEMBIFY from vial(s) to syringe**

Do not allow your fingers or other objects to touch the inner stem of the plunger, the syringe tip, or other areas that can touch the XEMBIFY solution. Make sure needles are capped until used and that needles and syringes stay on the clean area created in Step 2. This is called “aseptic technique” to prevent germs from getting into the XEMBIFY.

Using aseptic technique, attach each needle to the syringe tip.

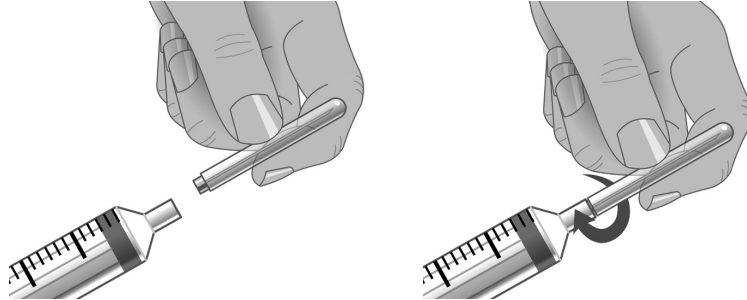
**Step 7: Prepare the syringe and draw XEMBIFY solution into syringe**

Remove cap from needle.

Pull the syringe plunger back to the level matching the amount of XEMBIFY™ (immune globulin subcutaneous, human-klhw) to be withdrawn from the vial.

Place the XEMBIFY vial on a clean flat surface and insert the needle into the center of the vial stopper.

Inject air into the vial. The amount of air should match the amount of XEMBIFY to be withdrawn.

Turn the vial upside down and withdraw the correct amount of XEMBIFY. If multiple vials are required to get the correct dose, repeat Step 4.

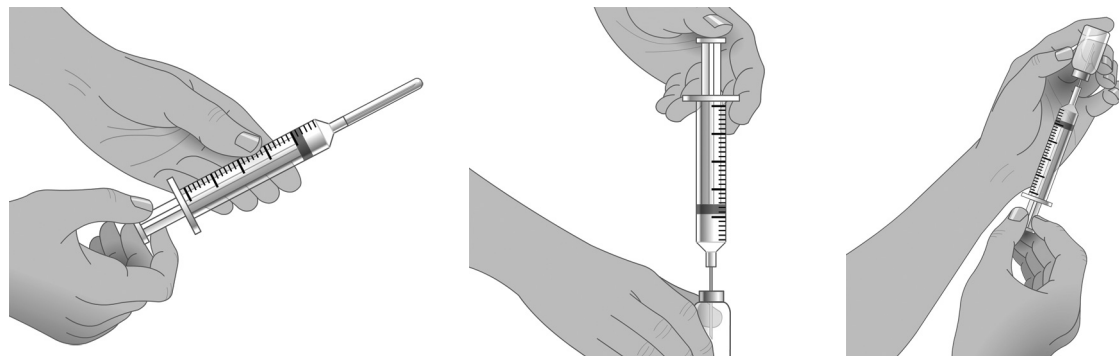
**Step 8: Fill the pump reservoir and prepare the infusion pump**

Follow the pump manufacturer’s instructions for filling the pump reservoir and preparing the infusion pump, administration tubing and Y-site connection tubing, if needed.

Prime the administration tubing with XEMBIFY to take out any air left in the tubing or needle. To prime, hold the syringe in one hand and the administration tubing’s capped needle in the other. Gently squeeze on the plunger until you see a drop of XEMBIFY come out of the needle.

**Step 9: Select the number and location of infusion sites**

Select one or more infusion sites as directed by your healthcare provider.

The number and location of injection sites depends on the volume of the total dose.

Avoid: bony areas, visible blood vessels, scars, and any areas of inflammation (irritation) or infection.

Rotate sites between future infusions.

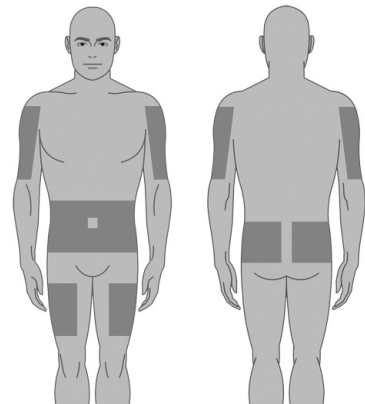

**Step 10: Prepare the infusion site**

Wipe the infusion site(s) with a sterile alcohol wipe beginning at the center of each infusion site and moving outward in circular motion. Allow the infusion site(s) to dry (at least 30 seconds).

Before infusion, sites should be clean, dry, and at least 2 inches (5 cm) apart.

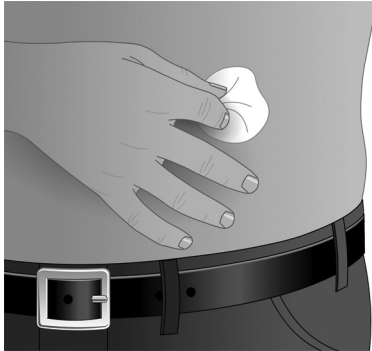
**Step 11: Insert the needle**

Grasp the skin between two fingers (pinch at least 1 inch (2.5 cm) of skin) and insert the needle at a 90-degree angle into the tissue underneath the skin or subcutaneous tissue.

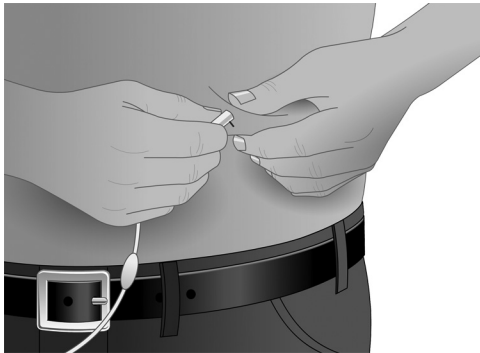
**Step 12: Make sure the needle is not in a blood vessel**

After inserting each needle into tissue (and before your infusion), make sure that a blood vessel has not been accidentally entered. To do this, attach a sterile syringe to the end of the primed administration tubing. Pull back on the syringe plunger and watch for any blood flowing back into administration tubing.

If you see any blood, remove and discard the needle and administration tubing.

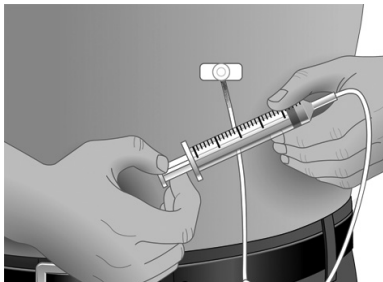

Repeat priming and needle insertion steps using a new needle, administration tubing and a new infusion site.

Secure the needle in place by applying sterile gauze or transparent dressing over the site.

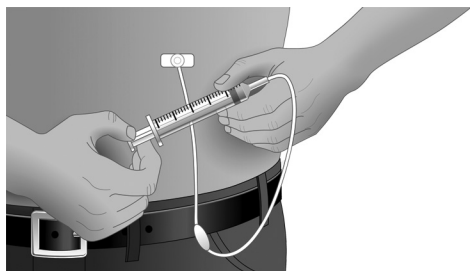

Step 13: Repeat for other sites, as needed

Step 14: Infuse XEMBIFY

Infuse XEMBIFY as soon as possible after it is prepared.

Follow the pump manufacturer's instructions for filling the tubing and using the infusion pump.

Step 15: After infusion

Follow manufacturer's instructions to turn off pump.

Undo and discard any dressing or tape.

Gently remove the inserted needle(s) or catheter(s).

Discard any unused solution in an appropriate waste container as instructed.

Discard any used administration equipment in an appropriate waste container.

Store your supplies in a safe place.

Follow manufacturer's instructions to care for the infusion pump.

Step 16: Record each infusion

Remove the peel-off label with the product lot number from the XEMBIFY vial and use this to complete the patient record. Include information about each infusion such as: the time, date, dose, lot number(s), infusion sites, and any reactions.

Remember to bring your journal with you when you visit your healthcare provider. Your healthcare provider may ask to see your treatment diary/logbook.

Tell your healthcare provider about any problems you have during your infusions. Call your healthcare provider for medical advice about side effects. You can also report side effects to FDA at 1-800-FDA-1088 or [www.fda.gov/medwatch](http://www.fda.gov/medwatch).

Manufactured by:

**GRIFOLS**

**Grifols Therapeutics LLC**

Research Triangle Park, NC 27709 USA

U.S. License No. 1871

3054808

Revised 7/2019