

Welcome to

**ELLEN**

Fotografiska, Stadsgårdshamnen 22, Stockholm



Fotografiska



# Ellen

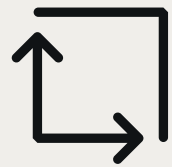

380 M<sup>2</sup>/4090 FT<sup>2</sup>



<88 P



<300 P



<54 P



<110 P

Ellen is located at the entrance level, in the east part of Fotografiska, and offers an exclusive entrance from the dock. The venue is L-shaped and has flexible, movable walls, making it possible to divide it into several smaller rooms and adapt it for different kinds of meetings. Ellen can, for example, be rented as one large room, two smaller rooms with a lounge, or one larger room with a lounge.

Here, we offer two connecting walls where we can create interactive projection solutions through our built-in Watchout system, and enable changeable environments throughout your event. Naturally, we also offer possibilities to broadcast, record, and host hybrid meetings. Or why not use the built in Watchout system to transform the space into an vibrant dance floor after a delicious dinner?

Next to Ellen is a 970 sq.ft. (90 sq.m.) joint event entrance. It can be used for registration at larger events, or for photo walls. The flexible, movable doors can merge the entrance and Ellen into a bigger, combined lounge. Some of the doors can also be replaced with glass doors, overlooking the dock,

to let a lot of lovely light in and give you a panoramic view of the city and the water.

Combined with our connecting venue, Annie, Ellen offers a space of more than 8,600 sq.ft. (800 sq.m.), making it possible to arrange large events with many guests. If you're planning a dinner in Annie or The Dining Room, you could have the entrance, cloak room, welcome drink, and after party in Ellen.

The area is also excellent when combined for larger events where you need space for e.g. exhibitors, partner activities, mingle lunch, coffee breaks and networking.

Outside the entrance it's possible to drop off or pick up your guests with e.g. bus or boat.

Adjacent to Ellen there is also a smaller room that can be used as back office, dressing room or storage.

## THIS VENUE IS SUITABLE FOR:

conferences, lectures, kick-offs, general meetings, fairs, events, parties, shows, gala banquets, fashion shows, award ceremonies, mingle, product launches, client and partner events, hybrid events, broadcasts, or for parallel/breakout sessions.



# This is included with this venue



- > 70 ft. (20 m.) wall projection with Watchout system



- > 4 wireless hand-held microphones or headsets
- > Soundsystem/Unit for playing music/ Speakers for speech



- > General lights
- > Current: 2 × 16 A, 1 × 32 A, 10 A



- > Stage
- > Stand-up table for laptop
- > Standard furnishing
- > In Ellen, chairs for cinema-staging are included, along with 5 stand-up tables for mingling, a 40 sq.ft. (4 sq.m.) stage, as well as general lighting.



- > With a confirmed booking, a three-hour consultation with a dedicated project leader is included. We are always available for further consultation, depending on needs and wishes.

# How and when?



Ellen is normally booked for full day or evening event, with the following start/end times:

**9.00 AM–5.00 PM** for full day events

**7.00 PM–1.00 AM** for evening events

Do you wish to book Ellen outside of the times mentioned above? If available, we are happy to accommodate your needs! Contact us for more information and to get a quote.

It is possible to extend the opening hours until 3.00 am.



# Ellen: Floor Plan

Please feel free to contact us for additional information on measurements and furnishing possibilities.

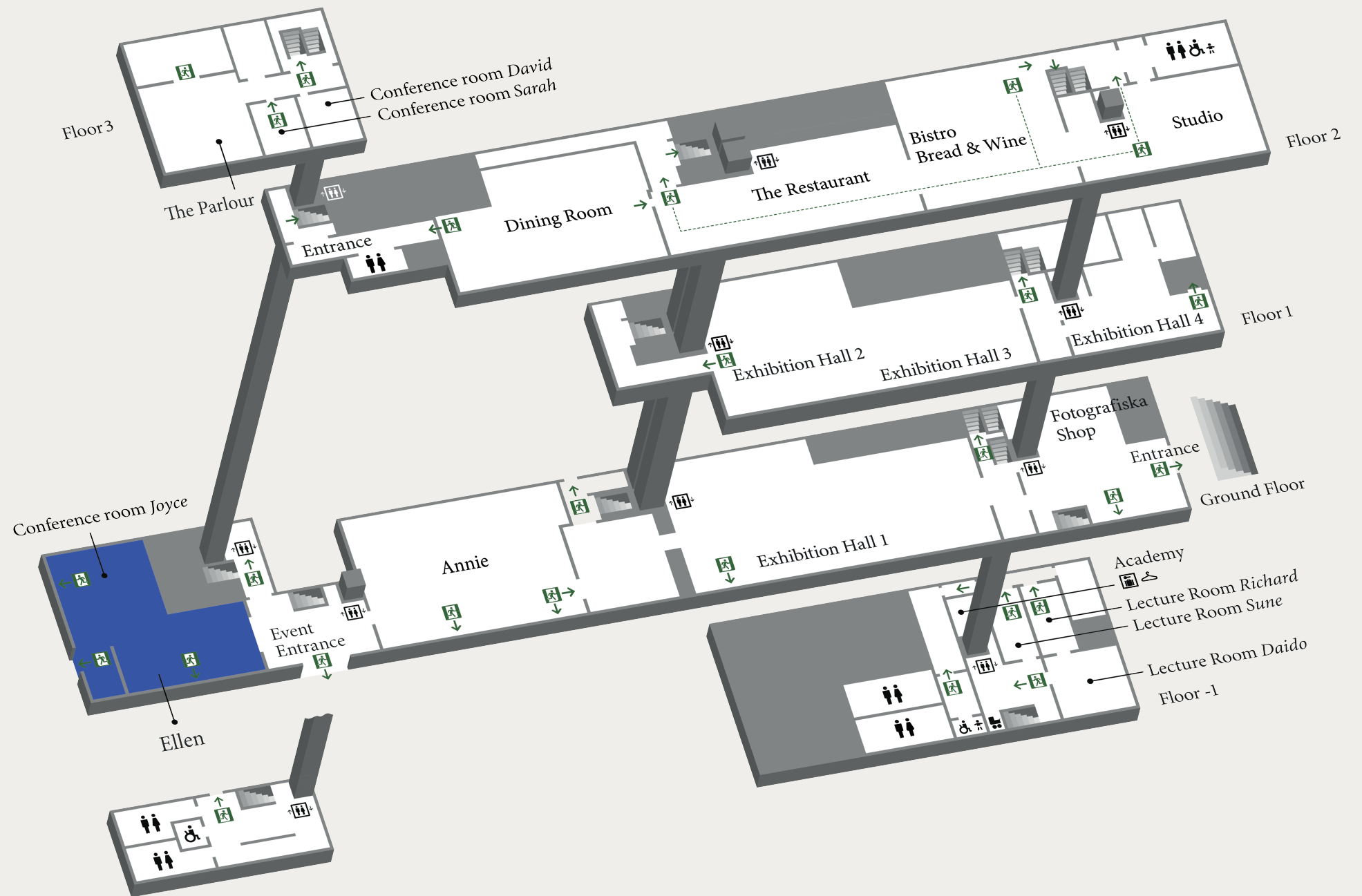



# Please, contact us!

Or read more at [www.fotografiska.com/sto/en/moten-event](http://www.fotografiska.com/sto/en/moten-event)

## **Fotografiska Meetings & Events**

events.sto@fotografiska.com

### **Emmy Sundberg**

Director of Meetings & Private Events

emmy.sundberg@fotografiska.com

+46 (0)73 730 65 76

### **Annika Sundbaum Strömberg**

Sales Manager, Meetings & Events

annika.sundbaum@fotografiska.com

+46 (0)70 497 19 08

### **Richard Nilsson**

Sales Manager, Meetings & Events

richard.nilsson@fotografiska.com

+46 (0)70 783 75 40