

2D Special order dxf-files

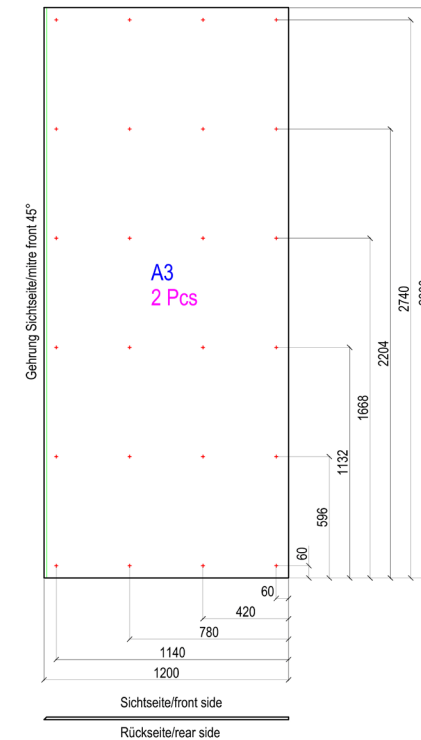
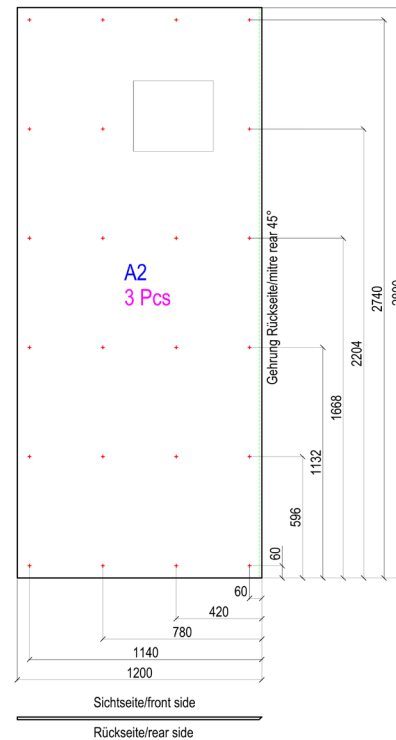
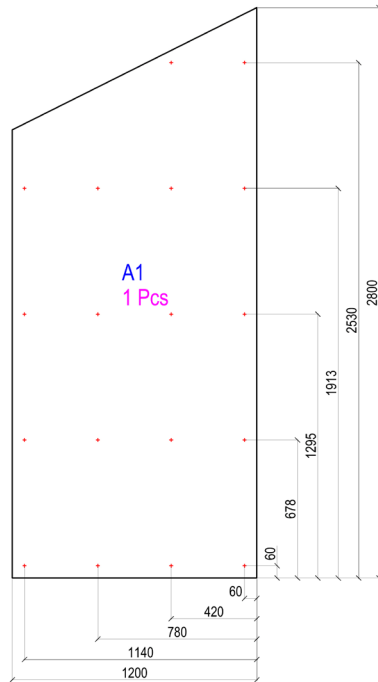

IMPORTANT NOTES

- The panel curve must be a closed curve.
- Drillholes can be represented by circle or cross.
- Perforations must be a closed curve.
- For mitre cuts please type the degrees in an additional information outside of the panel (see above).
- If mitre cuts are on the front side please add "mitre front", otherwise we'll assume the mitre cuts are on the rear side.
- Please save all panels in one dxf-file.
- For general technical information refer to our technical manual.
- A partitioning by packaging of the panels according to customer requirements must be indicated accordingly.
- More details about the CAD standard of Rieder are available in the download area at www.rieder.cc.

LAYER STRUCTURE

- Layer 01 - panel curve
- Layer 02 - position number
- Layer 03 - drilling
- Layer 04 - mitre
- Layer 05 - quantity
- Layer 06 - cut-outs
- Layer 07 - dimension
- Layer 08 - substructure
- Layer 09 - bull nose
- Layer 10 - section

MATERIAL INFORMATION

- colour, surface, texture
- kind of drilling
- viewing direction: front side
- or rear side
- measurements in mm
- scale 1:1

3D Special order dxf-files

Rieder

formparts U-shaped

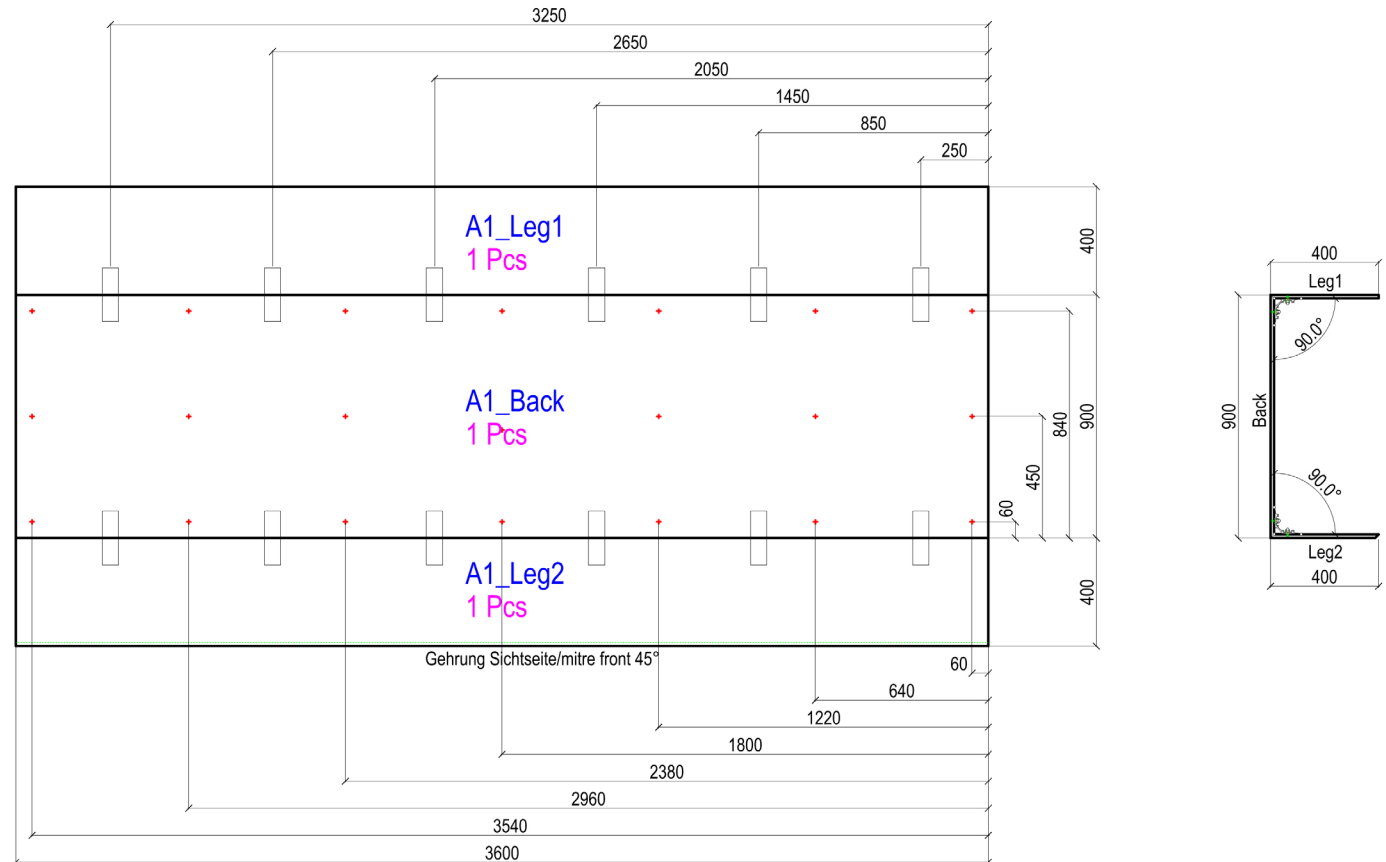

IMPORTANT NOTES

- The panel curve must be a closed curve.
- Drillholes can be represented by circle or cross.
- Perforations must be a closed curve.
- For mitre cuts please type the degrees in an additional information outside of the panel (see above).
- If mitre cuts are on the front side please add "mitre front", otherwise we'll assume the mitre cuts are on the rear side.
- Please save all panels in one dxf-file.

- For general technical information refer to our technical manual.
- A partitioning by packaging of the panels according to customer requirements must be indicated accordingly.
- More details about the CAD standard of Rieder are available in the download area at www.rieder.cc.

LAYER STRUCTURE

- Layer 01 - panel curve
- Layer 02 - position number
- Layer 03 - drilling
- Layer 04 - mitre
- Layer 05 - quantity
- Layer 06 - cut-outs
- Layer 07 - dimension
- Layer 08 - substructure
- Layer 09 - bull nose
- Layer 10 - section

MATERIAL INFORMATION

- colour, surface, texture
- kind of drilling
- viewing direction: front side
- or rear side
- measurements in mm
- scale 1:1

3D Special order dxf-files

Rieder

formparts L-shaped

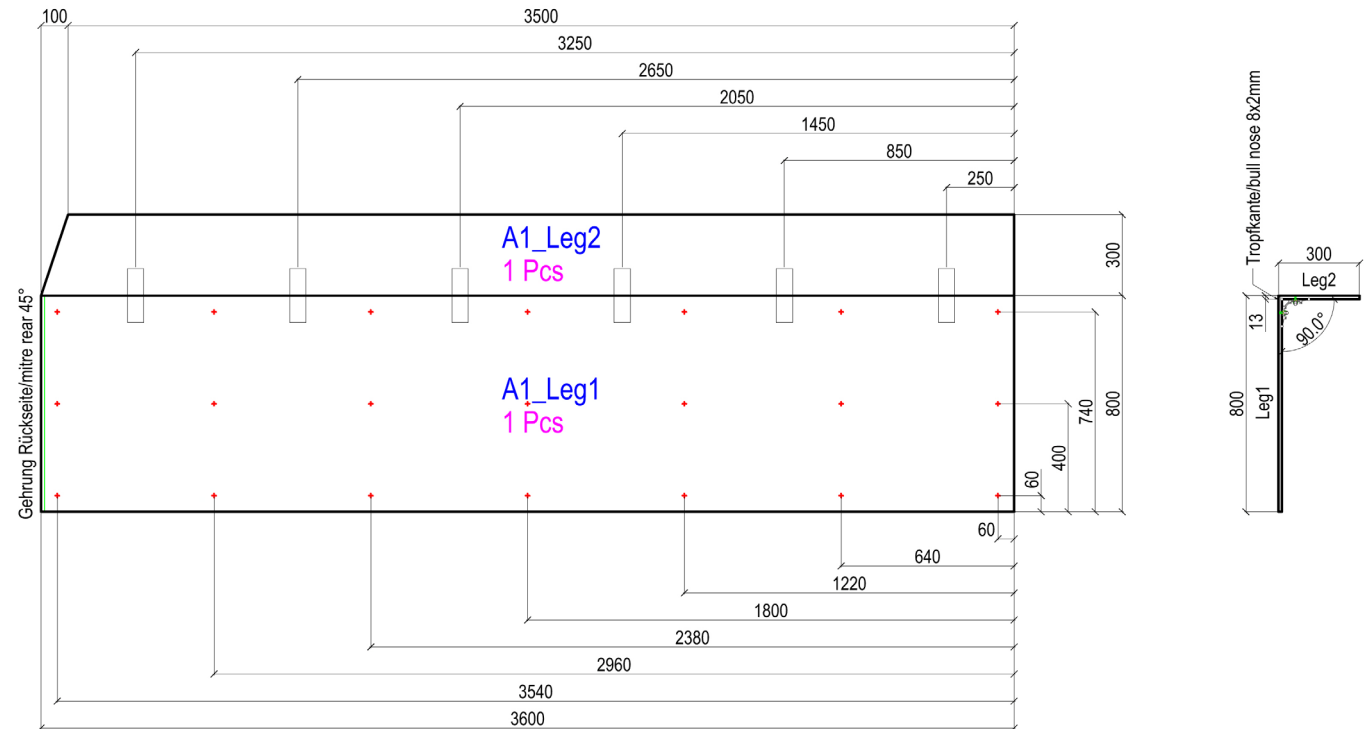

IMPORTANT NOTES

- The panel curve must be a closed curve.
- Drillholes can be represented by circle or cross.
- Perforations must be a closed curve.
- For mitre cuts please type the degrees in an additional information outside of the panel (see above).
- If mitre cuts are on the front side please add "mitre front", otherwise we'll assume the mitre cuts are on the rear side.
- Please save all panels in one dxf-file.

- For general technical information refer to our technical manual.
- A partitioning by packaging of the panels according to customer requirements must be indicated accordingly.
- More details about the CAD standard of Rieder are available in the download area at www.rieder.cc.

LAYER STRUCTURE

- Layer 01 - panel curve
- Layer 02 - position number
- Layer 03 - drilling
- Layer 04 - mitre
- Layer 05 - quantity
- Layer 06 - cut-outs
- Layer 07 - dimension
- Layer 08 - substructure
- Layer 09 - bull nose
- Layer 10 - section

MATERIAL INFORMATION

- colour, surface, texture
- kind of drilling
- viewing direction: front side
- or rear side
- measurements in mm
- scale 1:1

3D Special order dxf-files

Rieder

formparts C-shaped

perspective

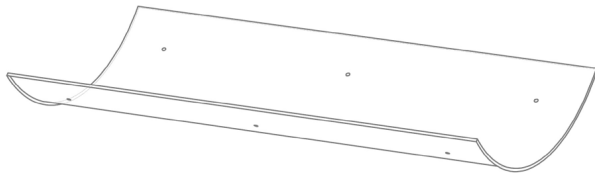

unrolled view - rear side

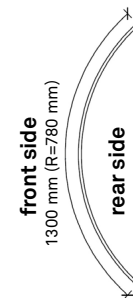
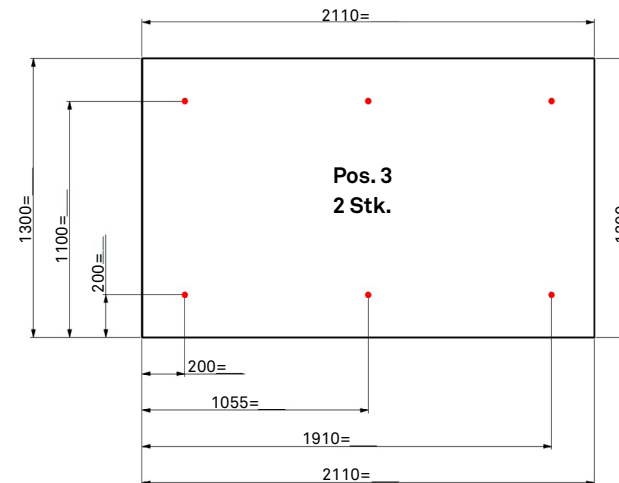

IMPORTANT NOTES

- The panel curve must be a closed curve.
- Drillholes can be represented by circle or cross.
- Perforations must be a closed curve.
- For mitre cuts please type the degrees in an additional information outside of the panel (see above).
- If mitre cuts are on the front side please add "mitre front", otherwise we'll assume the mitre cuts are on the rear side.
- Please save all panels in one dxf-file.
- For general technical information refer to our technical manual.
- A partitioning by packaging of the panels according to customer requirements must be indicated accordingly.
- More details about the CAD standard of Rieder are available in the download area at www.rieder.cc.

LAYER STRUCTURE

- Layer 01 - panel curve
- Layer 02 - position number
- Layer 03 - drilling
- Layer 04 - mitre
- Layer 05 - quantity
- Layer 06 - cut-outs
- Layer 07 - dimension
- Layer 08 - substructure
- Layer 09 - bull nose
- Layer 10 - section

MATERIAL INFORMATION

- colour, surface, texture
- kind of drilling
- viewing direction: front side
- or rear side
- measurements in mm
- scale 1:1