

ARCH WALL LIGHT

The Arch Collection features vertical panels surrounding a radial central light source creating a soft and ambient glow.

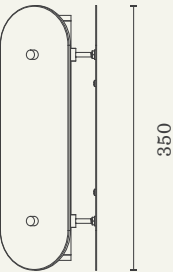

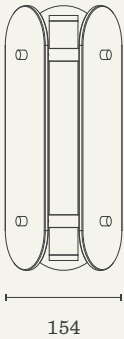
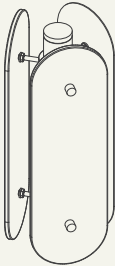
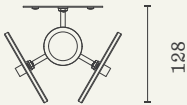

MATERIALS

- Brass (Fixture / Panel)
- Glass (Panels)
- Acrylic (Tube)

LAMP

- 7.4W LED
- Warm White 3000K
- 800 Lumens
- Dimmable
- 24V transformer supplied

METAL FINISHES

- Natural Brass
- Brushed Gold
- Blackened Brass
- Brushed Chrome

GLASS

- Bronze
- Reflective
- Natural Brass Panel

Notes

- Lead time - see website
- IP Rating available
- 3 year warranty

ASSEMBLY INSTRUCTIONS

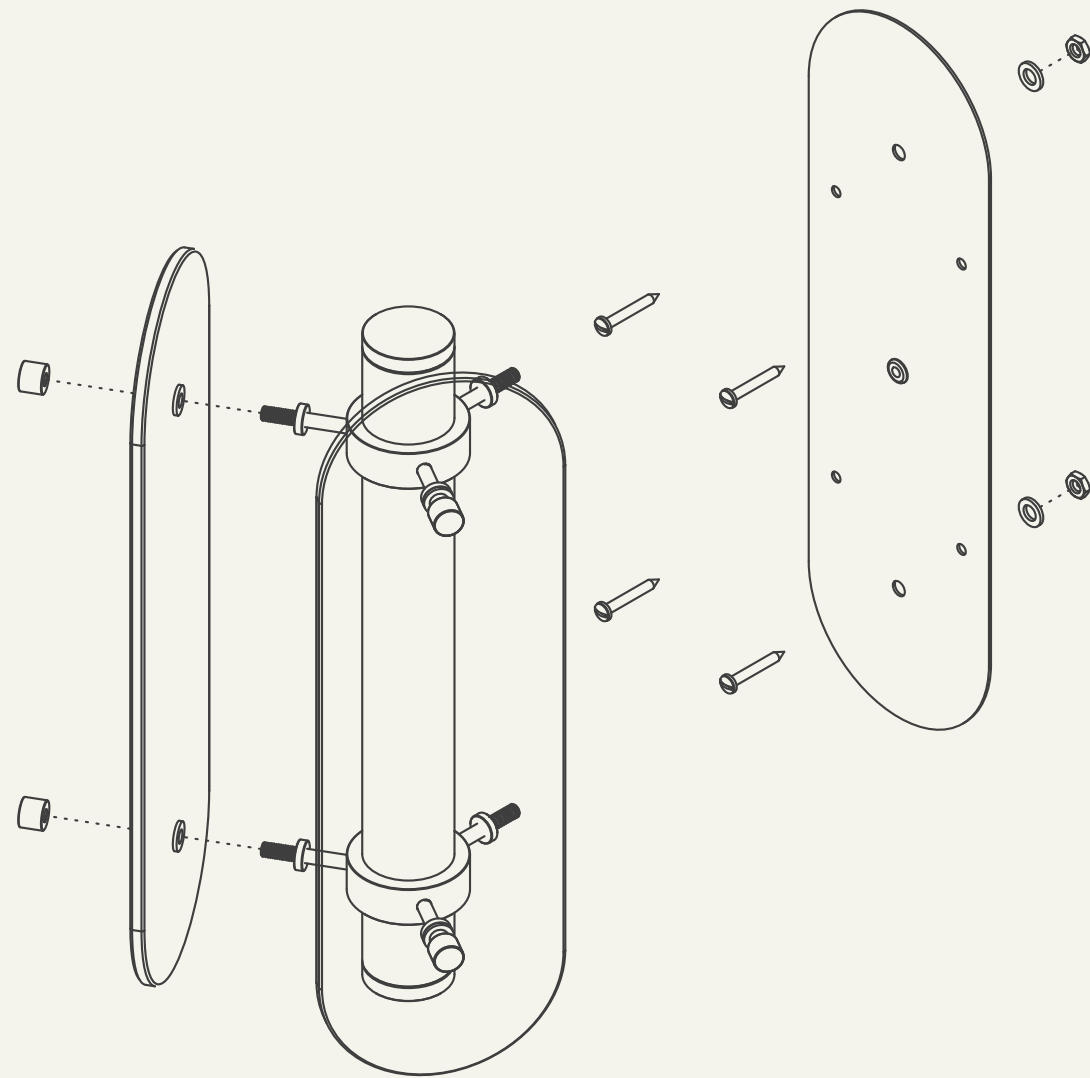

1. Put hole in wall to fit driver/transformer. This must be installed either behind the light or at a nearby location as advised by your electrician.
2. To attach back plate to the wall:
 - Cut two 15mm holes with a 9mm recess.
 - Cut four pilot holes for the 4 fixing points.
3. Screw fixture to wall using supplied screws/nuts through holes positioned on back plate.
4. Once fixture is secure, place each panel on carefully.