

# Palma

3734

Design By Antoni Arola

Nature takes control of space. With the pendant lamps, the interior ambiance takes on a life of its own with the possibility of integrating plants with the lighting compositions.

## Spec sheet

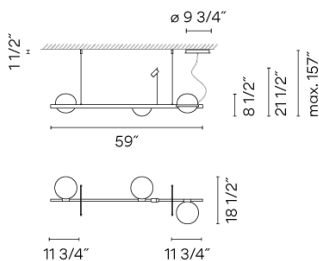

**Optional: Extra cable length**  
Min. Quantity, upcharge and extra lead time apply

**Finish** 18 Graphite  
ADAPTA RF 9913 WX

**LED color temperature** 2700 K

**Dimming** 0-10V / LUTRON / DALI

**Installation type** Surface

**Materials** Profile: Aluminum  
Diffuser: Blown-glass  
Flowerpot: PMMA (thermoplastic polymer)  
Canopy: Steel

**Light source** 4 x LED 4.6W 500mA  
1 x LED 2W 500mA

**LED** CRI>90 1828 lm 49.57  
2700 K

**Driver** Constant Current 500 120~277  
V V 50~60 Hz HZ

**Remarks** Title 24 (JA8) compliant

Dimmable LED IP20 Multi-volt  
Dry Location 50-60Hz 0-10V

**Application** Pendants

**Packaging** 1 Box  
72.13 m x 11.81 m x 11.81 m  
Gross weight 20.84  
Net weight 13.11  
Vol. 5.8199

### Lighting effect

#### General lighting

Lamp for general lighting that equally distributes the light in all directions.

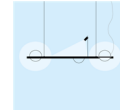

### Photometric Data

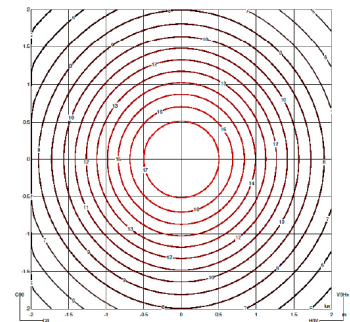
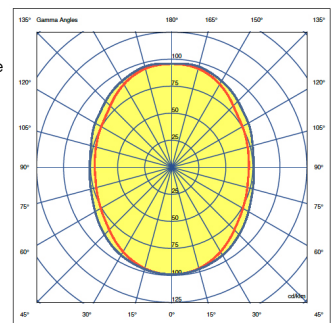

**Efficiency** 100%  
**Coordination System** CG  
**Total Flux** 1153 lm  
**Maximum Value** 98.93cd/klm

VIBIA, INC.

**USA & CANADA**  
272 Fernwood Ave. Edison, NJ 08837. USA  
Phone 732 417 1700 sales@vibia.com www.vibia.com/us/usa

**HEADQUARTERS**  
Progrés 4-6. 08850 Gavà  
(Barcelona - Spain)