

5501
HEADQUARTERS

5501
HEADQUARTERS

5501
HEADQUARTERS

5501
HEADQUARTERS

5501
HEADQUARTERS

5501
HEADQUARTERS

5501
HEADQUARTERS

5501
HEADQUARTERS



• PLANO, TX •



HIGHLIGHTS

- 17,000 RSF Available
- 5:1000 Parking | 375 Garage | 470 Surface
- 17,000 SF Renovated Common Area

BRAND NEW

- Lobby
- Fitness Center
- Locker Rooms
- Grab & Go
- Restrooms

LOCATION

5501 Headquarters is a Class A office building located in Plano's exclusive Legacy submarket. In under 5 minutes, tenants can drive to the popular mixed-use centers: **The Shops at Legacy, Legacy Town Center, and Legacy West Urban Village**. The office is one mile east of the Dallas North Tollway and one mile south of Sam Rayburn Tollway (SH 121), making it easily accessible for employees from all areas of the metroplex.

- 1 The Shops at Legacy
- 2 Legacy Town Center
- 3 Legacy West Urban Village
- 4 The Boardwalk at Granite Park
- 5 Hall Park

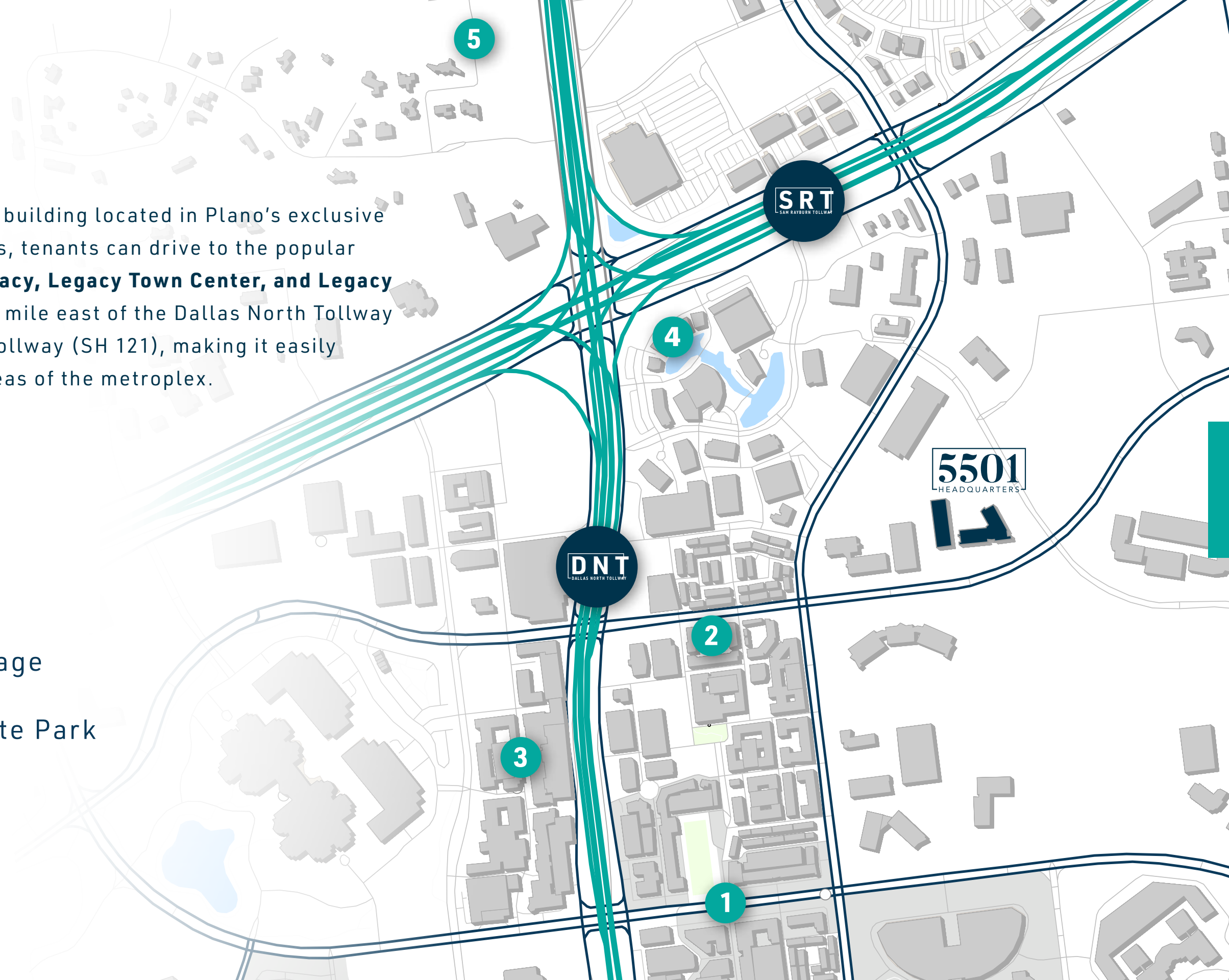

| BUILDING SPECS

BUILDING SIZE • 170,000 SF

STORIES • Three (3)

YEAR BUILT • 2007

TYPICAL FLOOR • 27,000 RSF

PARKING • 845 Total Spaces

- 375 Garage

- 470 Surface





FEATURES + AMENITIES

- Highly Efficient Floor Plates
- Covered Parking
- New Lobby
- New Fitness Center & Locker Rooms
- New Common Area
- Conference Room
- New Grab & Go
- Outdoor Putting Green
- Outdoor Patio
- On-site Security

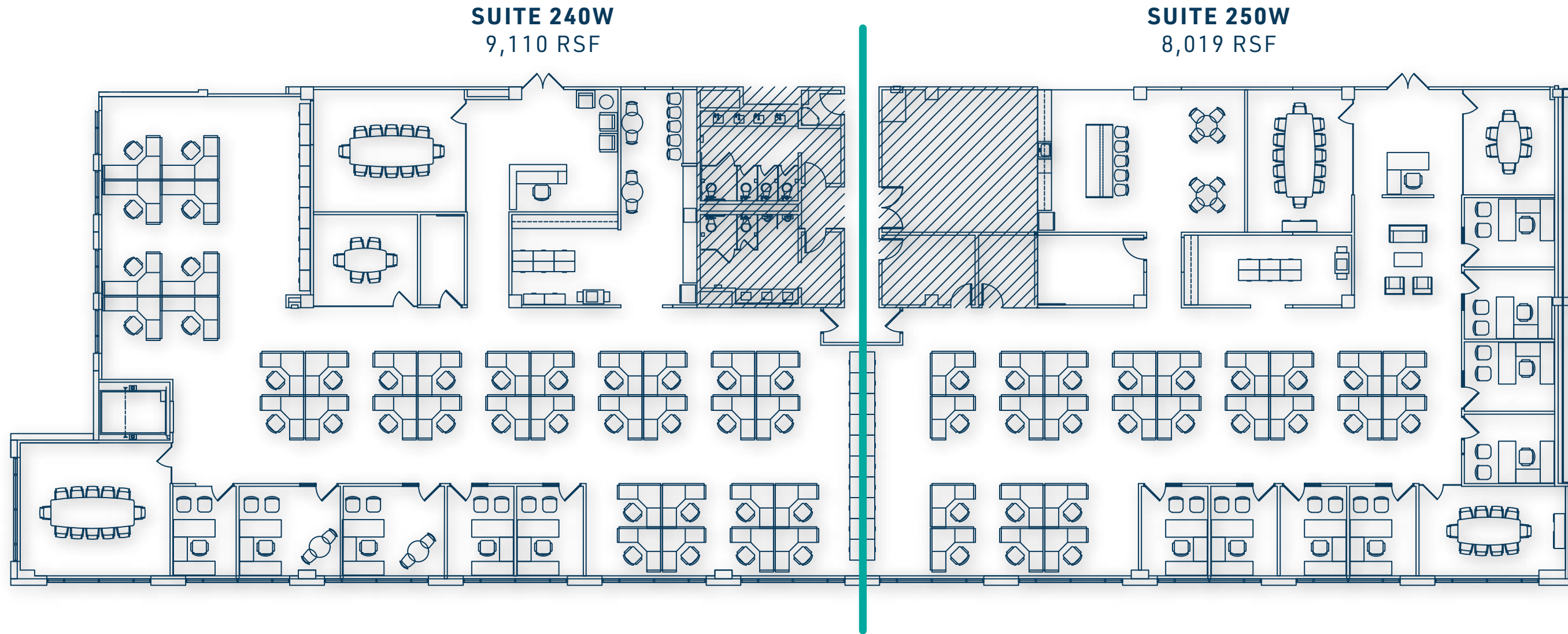

SPEC SUITES 240W AND 250W
FLOOR 02

SUITES 240W & 250W • 17,129 RSF

Spec suites are move-in ready.

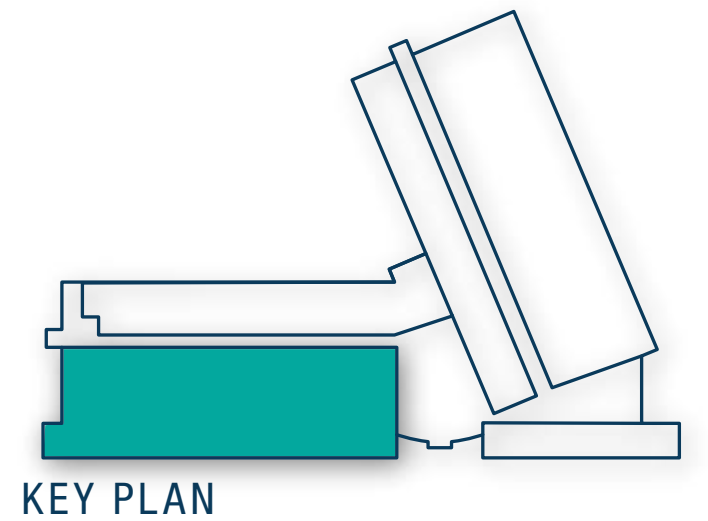

FOR LEASING INFORMATION



KRISTI WADDELL

972.759.7711

kwaddell@cawleypartners.com



JEREMY DUGGINS

972.759.7716

jduggins@cawleypartners.com



ADDIE LUDWIG

972.759.7727

kwaddell@cawleypartners.com

