

# \$939,000

# mikegreerhomes

## Styx Mill

Lot 55 Styx Mill Park - 31 Kiekie Road



# for sale

dwelling size | section size  
166 m<sup>2</sup> | 427 m<sup>2</sup>

homes  
for  
sale

This three double bedroom, double garage, fully landscaped home has been designed to maximise space and sun. The North-facing open plan living, dining and kitchen area forms the centre of the home and offers great indoor/outdoor flow. The well-appointed family bathroom and ensuite both feature quality fixtures and fittings that complement the spacious bedroom and living areas.

Styx Mill Park is a new premium development which features generous sections and its own recreation reserve. Enjoy multiple nearby recreational amenities including The Groynes and Styx Mill Conservation Reserve & Dog Park. Northwood Supa Centa is also located close by, with a great choice of food and retail outlets. Styx Mill Park perfectly combines the serenity of the country with the convenience of the city!

### more features.

- +
- +
- +
- +
- +
- +
- +

### Turn Key

A Turn Key home is an all-inclusive package that only requires 10% deposit.

bringing you **more**

03 354 0166

[mikegreerhomes.co.nz](http://mikegreerhomes.co.nz)

# Styx Mill Park Lot 55 Styx Mill Park - 31 Kiekie Road

dwelling size | section size

166 m<sup>2</sup> | 427 m<sup>2</sup>

3 2 2 1 2



## After Sales Care

At Mike Greer Homes we are committed to making the build journey as stress-free as possible. Our After Sales Care programme addresses any maintenance issues and ensures that any remedial work is undertaken once it is logged and approved.

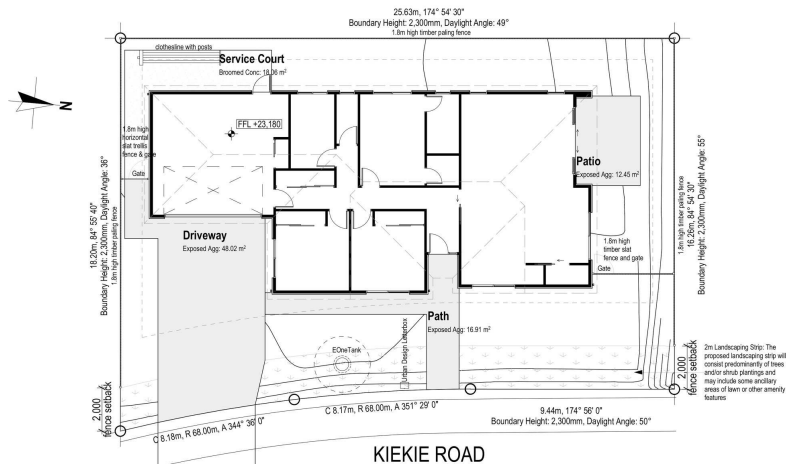

Disclaimer. While every reasonable effort has been made by Mike Greer Homes to ensure the information correctly illustrates the dwelling and section, this material may only be used by the Purchaser for illustrative and guidance purposes. Mike Greer Homes accepts no responsibility for any differences, errors or omissions which may become apparent during or on completion of the dwelling.