

\$759,000

mikegreerhomes

Rolleston

Lot 8 Wood Grove Stage 1a, Rolleston



for sale

dwelling size | section size
141 m² | 416 m²

homes
for
sale

Perfect for families and entertaining, this home is designed to maximise space and sun. The open plan living, dining and kitchen area is the centre of the home, and offers a great outlook onto the easy care section. With three double bedrooms, a family bathroom and ensuite, the house combines great functionality with a stylish feel. The home has an internal access double garage, and the section is fully landscaped with all fencing and driveways included.

Wood Grove offers a lifestyle that is hard to beat. There is something here for everyone, of every age and life stage. You and your family will soon discover why Selwyn and Rolleston are Canterbury's, and New Zealand's, fastest growing communities.

Enjoy easy access to educational institutions, green spaces, a great selection of excellent wineries and eateries, plus all the amenities you could need. Wood Grove gives residents an enviable quality of life in a highly desirable location.

 **Turn Key**

A Turn Key home is an all-inclusive package that only requires 10% deposit.

more features.





- +
- +
- +
- +
- +
- +
- +
- +

bringing you **more**

03 354 0166

mikegreerhomes.co.nz

Wood Grove Subdivision Lot 8 Wood Grove Stage 1a, Rolleston

dwelling size	section size	3	2	2	1	2
141 m ²	416 m ²					

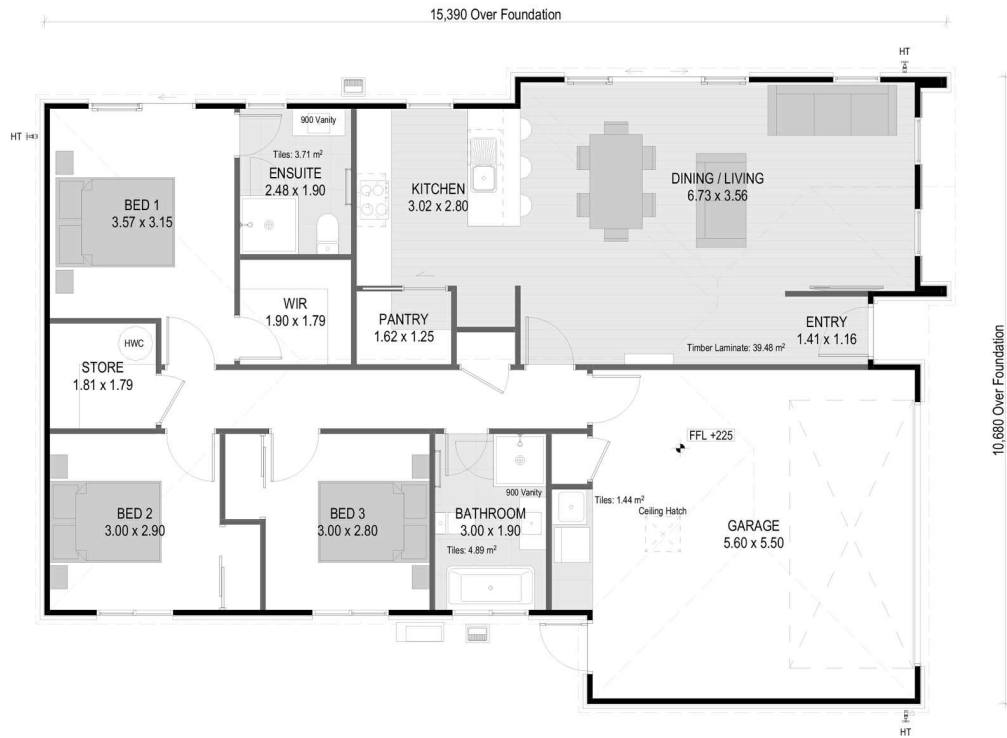

After Sales Care

At Mike Greer Homes we are committed to making the build journey as stress-free as possible. Our After Sales Care programme addresses any maintenance issues and ensures that any remedial work is undertaken once it is logged and approved.

Disclaimer. While every reasonable effort has been made by Mike Greer Homes to ensure the information correctly illustrates the dwelling and section, this material may only be used by the Purchaser for illustrative and guidance purposes. Mike Greer Homes accepts no responsibility for any differences, errors or omissions which may become apparent during or on completion of the dwelling.

