

# \$915,000

# mikegreerhomes

## Marshland

Lot 25 Prestons Grove



Artist Impression Only

# for sale

dwelling size | section size  
177 m<sup>2</sup> | 446 m<sup>2</sup>

homes  
for  
sale

This spacious three bedroom home is perfect for family life, with plenty of space for everyone to spread out. It features a separate lounge for relaxing or entertaining, plus an open plan kitchen and dining space. The home includes a family bathroom and a ensuite off the master bedroom, making mornings a breeze. The section is easy care, so you can spend more time enjoying your home and less time on upkeep. With quality finishes throughout, this place is ready to welcome you and your family!

Discover modern, easy living at Prestons Grove, a new subdivision in the fast-growing Prestons area of Christchurch. Surrounded by open green spaces and just minutes from Bottle Lake Forest, local cafes, supermarkets, schools and recreation, Prestons Grove offers the perfect balance of convenience and lifestyle - all with an easy commute to the city centre! It's an ideal spot for first-home buyers, families, and investors - a convenient, relaxed community you'll love to call home.

### more features.

- +
- +
- +
- +
- +
- +
- +



Turn Key





A Turn Key home is an all-inclusive package that only requires 10% deposit.

bringing you more

03 354 0166

mikegreerhomes.co.nz

Prestons Grove Lot 25 Prestons Grove

dwelling size	section size	3	2	2	2	2
177 m <sup>2</sup>	446 m <sup>2</sup>					



CT8397



**After Sales Care**

At Mike Greer Homes we are committed to making the build journey as stress-free as possible. Our After Sales Care programme addresses any maintenance issues and ensures that any remedial work is undertaken once it is logged and approved.

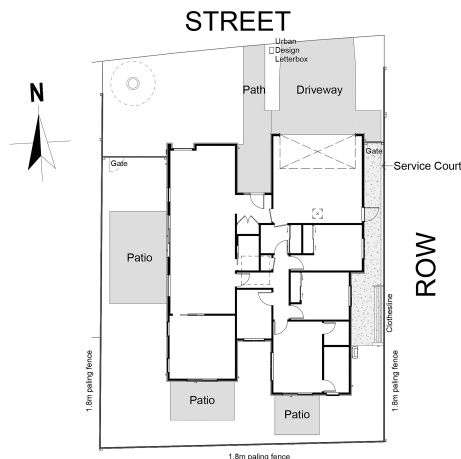

Disclaimer. While every reasonable effort has been made by Mike Greer Homes to ensure the information correctly illustrates the dwelling and section, this material may only be used by the Purchaser for illustrative and guidance purposes. Mike Greer Homes accepts no responsibility for any differences, errors or omissions which may become apparent during or on completion of the dwelling.