

\$689,000

mikegreerhomes

Rolleston

Lot 44 Wood Grove Stage 1a, Rolleston



Artist Impression Only

for sale

dwelling size	section size
129 m ²	337 m ²

homes
for
sale

Set on a fully landscaped section, this home features three double bedrooms, a family bathroom, an ensuite, and an open plan design. The living, kitchen, and dining space offer a versatile area well suited to families and for entertaining. This home is well appointed, with ample storage and quality fixtures and fittings throughout.

Wood Grove offers a lifestyle that is hard to beat. There is something here for everyone, of every age and life stage. You and your family will soon discover why Selwyn and Rolleston are Canterbury's, and New Zealand's, fastest growing communities.

Enjoy easy access to educational institutions, green spaces, a great selection of excellent wineries and eateries, plus all the amenities you could need. Wood Grove gives residents an enviable quality of life in a highly desirable location.



A Turn Key home is an all-inclusive package that only requires 10% deposit.

more features.

- ✦ Designer Kitchen
- ✦ Ensuite
- ✦ Godfrey Hirst Flooring
- ✦ Single Car Garaging
- ✦ Tiled Floors to Wet Areas
- ✦ Walk-in Pantry
- ✦ Walk-in Wardrobe

Wood Grove Subdivision Lot 44 Wood Grove Stage 1a, Rolleston

dwelling size | section size

129 m² | 337 m²

3 2 2 1 1

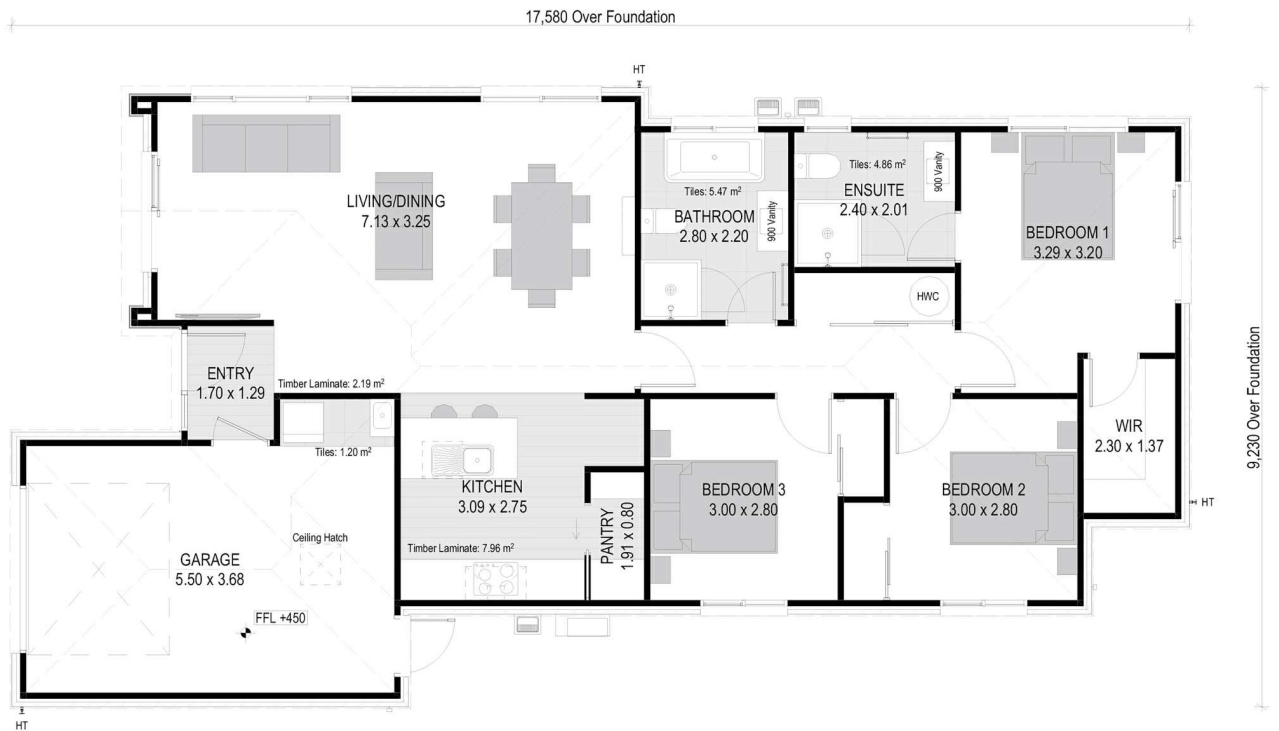
After Sales Care

At Mike Greer Homes we are committed to making the build journey as stress-free as possible. Our After Sales Care programme addresses any maintenance issues and ensures that any remedial work is undertaken once it is logged and approved.

Disclaimer. While every reasonable effort has been made by Mike Greer Homes to ensure the information correctly illustrates the dwelling and section, this material may only be used by the Purchaser for illustrative and guidance purposes. Mike Greer Homes accepts no responsibility for any differences, errors or omissions which may become apparent during or on completion of the dwelling.

