

# \$739,000

# mikegreerhomes

## Darfield

Lot 55 Kersey Park



# for sale

dwelling size | section size  
169 m<sup>2</sup> | 740 m<sup>2</sup>

homes  
for  
sale

Set on a fully landscaped section in the pleasant Kersey Park neighbourhood, this home offers four double bedrooms, a family bathroom, an ensuite, and a convenient separate toilet. The open plan kitchen, dining, and living area provides a versatile space well suited to family living and entertaining. Located in the heart of Darfield, this home enjoys the benefits of a relaxed rural township, with easy access to local walks, green spaces, and an outdoor focused lifestyle.

Set in the heart of Darfield, Kersey Park is a thoughtfully planned subdivision offering relaxed modern living in a scenic rural setting. Open green spaces and framed by views toward the Southern Alps, this welcoming community delivers space, convenience, and lifestyle in equal measure. Darfield's amenities are all close at hand, while Christchurch City and the airport are within easy commuting distance. Kersey Park offers residents the opportunity to enjoy a connected, family friendly environment in one of Selwyn's most appealing townships.



A Turn Key home is an all-inclusive package that only requires 10% deposit.

### more features.





- ✦ Godfrey Hirst Flooring
- ✦ LED Lighting
- ✦ Open Plan Living
- ✦ Stone Benchtop
- ✦ Walk-in Pantry
- ✦ Walk-in Wardrobe

bringing you more

03 354 0166

mikegreerhomes.co.nz

# Kersey Park Lot 55 Kersey Park

dwelling size	section size	4	2	2	1	2
169 m <sup>2</sup>	740 m <sup>2</sup>					



## After Sales Care

At Mike Greer Homes we are committed to making the build journey as stress-free as possible. Our After Sales Care programme addresses any maintenance issues and ensures that any remedial work is undertaken once it is logged and approved.

Disclaimer. While every reasonable effort has been made by Mike Greer Homes to ensure the information correctly illustrates the dwelling and section, this material may only be used by the Purchaser for illustrative and guidance purposes. Mike Greer Homes accepts no responsibility for any differences, errors or omissions which may become apparent during or on completion of the dwelling.

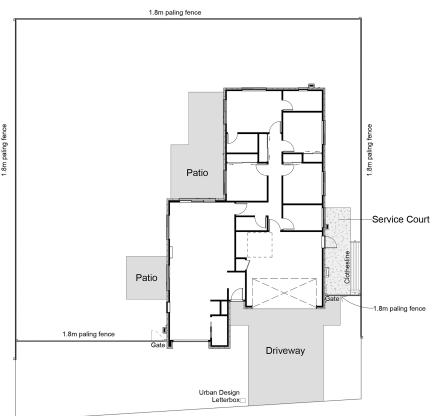

KERSEY AVE