

Archives Summary with Images

08/02/2019

Matches 554

Catalog / Objectid / Objname	Description	Condition	Status	Home Location
------------------------------	-------------	-----------	--------	---------------

A 2000.1.1
Map

Suwanee Sheet Topo Map (USGS)

Fourth Floor Storage



A 2000.1.2
Map

Allatoona Dam Quadrangle Topo Map (USGS)

Fourth Floor Storage

A 2000.1.3
Map

Acworth Quadrangle Topo Map (USGS) 1907 see media file

Fourth Floor Storage

A 2000.1.4
Map

GA-TN Dalton Sheet Topo Map (USGS) 2 copies

Fourth Floor Storage

Catalog / Objectid / Objname	Description	Condition	Status	Home Location
A 2000.1.5 Map	Cartersville Mining District Topo Map (USGS)			Fourth Floor Storage
A 2000.1.6 Map	Tate Quadrangle Topo Map (USGS)			Fourth Floor Storage
A 2000.1.7 Map	Canton Quadrangle Topo Map (USGS)			Fourth Floor Storage
A 2000.1.8 Map	Waleska Quadrangle Topo Map (USGS) 1950 see media file			Fourth Floor Storage
A 2000.1.9 Map	Mountain Quadrangle Topo Map (USGS)			Fourth Floor Storage

Catalog / Objectid / Objname	Description	Condition	Status	Home Location
A 2000.1.10 Map	Roswell Quadrangle Topo Map (USGS)			Fourth Floor Storage
A 2000.1.11 Map	Calhoon Quadrangle Topo Map (USGS)			Fourth Floor Storage
A 2000.1.12 Map	Birmingham Quadrangle Topo Map (USGS)			Fourth Floor Storage
A 2000.1.13 Map	City of Canton Topo Map			Fourth Floor Storage
A 2000.1.14 Map	Cherokee County General Highway Map (in 3 pieces)			Fourth Floor Storage

Catalog / Objectid / Objname	Description	Condition	Status	Home Location
A 2000.1.15 Map	Canton and Adjoining Areas (from 1955 aerial photo) 5 maps - 1 large (36X48), 4 small (17X22)			Fourth Floor Storage
A 2000.1.16 Map	Canton and Adjoining Areas from 1955 Aerial Photo Revised and Extended			Fourth Floor Storage
A 2000.1.17 Map	Cherokee County General Highway Map			Fourth Floor Storage
A 2000.1.18 Map	Murray County General Highway Map			Fourth Floor Storage
A 2000.1.19 Map	Woodstock City Map from Aerial Photo (original velum)			Fourth Floor Storage

Catalog / Objectid / Objname	Description	Condition	Status	Home Location
A 2000.1.20 Map	Cherokee County General Highway Map			Fourth Floor Storage
A 2000.1.21 Map	Murray County General Highway Map			Fourth Floor Storage
A 2000.1.22 Map	Part of District22. Section2			Fourth Floor Storage
A 2000.1.23 Map	Observation Hill Subdivision Plat Map LL195, LL201, LL202 B.F. Coggins			Fourth Floor Storage
A 2000.1.24 Map	Observation Hill Town Lots and Adjoining Farm Tracts LL195, LL196, LL201, LL202 (original drawing plus 3 prints) B.F. Coggins City of Canton			Fourth Floor Storage

Catalog / Objectid / Objname	Description	Condition	Status	Home Location
A 2000.1.25 Map	Plat LL169 Dist4 Mrs. R. L. Payne			Fourth Floor Storage
A 2000.1.26 Map	LL272, Dist15 Pine Crest Inn with Topo Lines Tom Arrendale & C. O. White			Fourth Floor Storage
A 2000.1.27 Map	LL272, Dist15 Pine Crest Inn (3 prints) Billy & Joann Groover			Fourth Floor Storage
A 2000.1.28 Map	LL166, Dist14 Hilcrest Subdivision			Fourth Floor Storage
A 2000.1.29 Map	Magnolia Road & Oakdale Road			Fourth Floor Storage

Catalog / Objectid / Objname	Description	Condition	Status	Home Location
A 2000.1.30 Map	Free Home School			Fourth Floor Storage
A 2000.1.31 Map	LL195, Dist14 Crisler & Teasley Addition (2 prints)			Fourth Floor Storage
A 2000.1.32 Map	LL833, LL896 Dist21 Mrs. Gladys Mays			Fourth Floor Storage
A 2000.1.33 Map	LL165 Dist14 Harmon Ball Field			Fourth Floor Storage
A 2000.1.34 Map	Sherwood Forest			Fourth Floor Storage

Catalog / Objectid / Objname	Description	Condition	Status	Home Location
A 2000.1.35 Map	Ball Ground Traced from 1882 Survey. also copies in map caddy in office			Fourth Floor Storage
A 2000.1.36 Map	Part of Land Dist21			Fourth Floor Storage
A 2000.1.37 Map	3 Unidentified Working Drawings			Fourth Floor Storage
A 2000.1.38 Map	LL175, LL176, LL177, LL184, LL185, LL248, LL249 Dist15 Adams, Moses C. Estate			Fourth Floor Storage
A 2000.1.39 Map	LL434, LL503, LL504, Dist3 Allison, Ralph			Fourth Floor Storage

Catalog / Objectid / Objname	Description	Condition	Status	Home Location
A 2000.1.40 Map	LL227, Dist14 Beauty Heights North Canton Subdivision			Fourth Floor Storage
A 2000.1.41 Map	LL 227, Dist14 Beauty Heights North Canton Subdivision			Fourth Floor Storage
A 2000.1.42 Map	LL129, LL130, Dist14 Bell View Heights			Fourth Floor Storage
A 2000.1.43 Map	LL170, Dist14 (off GA 140) Billingslea			Fourth Floor Storage
A 2000.1.44 Map	LL9, Dist22 (Bartow Co.) Brooks Subdivision			Fourth Floor Storage

Catalog / Objectid / Objname	Description	Condition	Status	Home Location
A 2000.1.45 Map	LL168, Dist14 (off GA 140) Cannon, James A			Fourth Floor Storage
A 2000.1.46 Map	LL3, Dist2 Charmichael, R. L.			Fourth Floor Storage
A 2000.1.47 Map	LL17, LL18, LL56, Dist15 Chambers, Eugene B "Bud"			Fourth Floor Storage
A 2000.1.48 Map	LL174, Dist14 (Sharp Top Road) Chamlee, Mrs. J. W.			Fourth Floor Storage
A 2000.1.49 Map	LL345, LL376, LL377, Dist15 Childers, Mrs. H. T.			Fourth Floor Storage

Catalog / Objectid / Objname	Description	Condition	Status	Home Location
A 2000.1.50 Map	LL345, LL376, LL377, Dist15 (preliminary plan) Childers, Mrs. H. T.			Fourth Floor Storage
A 2000.1.51 Map	LL158, Dist14 (revised plat) Cherokee Heights (Jones Mercantile)			Fourth Floor Storage
				
A 2000.1.52 Map	LL162, Dist14 Coker, Dr. G. N. Subdivision			Fourth Floor Storage
A 2000.1.53 Map	LL171, Dist14 Cummins, W. E.			Fourth Floor Storage
A 2000.1.54 Map	LL171, Dist14 Cummings, W. E.			Fourth Floor Storage

Catalog / Objectid / Objname	Description	Condition	Status	Home Location
A 2000.1.55 Map	LL 16, Dist 15 Edwards Heights			Fourth Floor Storage
A 2000.1.56 Map	LL 169, Dist 14 (Bartow Co.) Felton, William H. Subdivision			Fourth Floor Storage
A 2000.1.57 Map	LL 195, 196, 201, 202, Dist 4 Forest Hills (Charlie Cobb)			Fourth Floor Storage
A 2000.1.58 Map	LL 64, Dist 3 (Ball Ground) Green Subdivision (Mrs. Luther Green)			Fourth Floor Storage
A 2000.1.59 Map	LL 129, 160, Dist 14 Haynes, J. P.			Fourth Floor Storage

Catalog / Objectid / Objname	Description	Condition	Status	Home Location
A 2000.1.60 Map	LL 129, 160, Dist 14 (revised and incomplete) Haynes, J. P.			Fourth Floor Storage
A 2000.1.61 Map	LL 130, Dist 14 Haynes, H. G.			Fourth Floor Storage
A 2000.1.62 Map	LL 123, 129, 130, 131, 159, Dist 14 Haynes, Prentice			Fourth Floor Storage
A 2000.1.63 Map	LL 339, 338, Dist 15 Holloway & Holloway Subdivision Plans			Fourth Floor Storage
A 2000.1.64 Map	LL 59, 60, 14, 13,1283, Dist 3 Johnson, W. J. Estate			Fourth Floor Storage

Catalog / Objectid / Objname	Description	Condition	Status	Home Location
A 2000.1.65 Map	LL 922, 923, 950, 951, Dist 15 Johnston, Smith L. Jr.			Fourth Floor Storage
A 2000.1.66 Map	LL 342, 343, Dist 15 (Holly Springs) Long, E. J.			Fourth Floor Storage
A 2000.1.67 Map	LL 805, 852, Dist 3 Macedonia Subdivision			Fourth Floor Storage
A 2000.1.68 Map	LL 415, Dist 15 (Holly Springs) McWhirter, C. F. (heirs)			Fourth Floor Storage
A 2000.1.69 Map	LL 169, Dist 14 Mountin View Puckett, W. B.			Fourth Floor Storage

Catalog / Objectid / Objname	Description	Condition	Status	Home Location
A 2000.1.70 Map	Ormwood Park Cherokee Ave			Fourth Floor Storage
A 2000.1.71 Map	LL 127, Dist 14 Pine Crest			Fourth Floor Storage
A 2000.1.72 Map	Dist 14, 15 Parts of Coker Subdivision & Rolling Hills Heights Nichols, Dr. William H			Fourth Floor Storage
A 2000.1.73 Map	LL 851, 878, Dist 3 Pinyan & Williams Subdivision			Fourth Floor Storage
A 2000.1.74 Map	LL 195, Dist 15 Holloway & Holloway - Plainview			Fourth Floor Storage

Catalog / Objectid / Objname	Description	Condition	Status	Home Location
A 2000.1.75 Map	LL 16, 17, 18, 56, 57, 58, Dist 15 Rolling Hills Heights Blackwell			Fourth Floor Storage
A 2000.1.76 Map	Blackwell, W. L. (3 plats)			Fourth Floor Storage
A 2000.1.77 Map	LL 922, 923, 950, 951, Dist 15 (Woodstock) Ridgecrest			Fourth Floor Storage
A 2000.1.78 Map	LL 160, 165, Dist 14 Sunnyside Addition McLain, J. A.			Fourth Floor Storage
A 2000.1.79 Map	LL 700, 701, 702, 739, 740, 773, 812, 845, Dist 4 (Bartow Co.) Tumlin Estate			Fourth Floor Storage

Catalog / Objectid / Objname	Description	Condition	Status	Home Location
A 2000.1.80 Map	LL 195, Dist 15 Turner, E. E.			Fourth Floor Storage
A 2000.1.81 Map	LL 1186, 1187, 1190, 1191, Dist 21 Tyson Estates			Fourth Floor Storage
A 2000.1.82 Map	LL 54, Dist 14 Saxon Heights estates			Fourth Floor Storage
A 2000.1.83 Map	LL 10, Dist 15 Shady Brook Acres			Fourth Floor Storage
A 2000.1.84 Map	LL 161, 162, Dist 15 Whispering Pines Reed, L. J.			Fourth Floor Storage

Catalog / Objectid / Objname	Description	Condition	Status	Home Location
A 2000.1.85 Map	LL 129, 130, Dist 14 (2 plats)			Fourth Floor Storage
A 2000.1.86 Map	LL 338, Dist 4 Ball Ground School			Fourth Floor Storage
A 2000.1.87 Map	LL 338, Dist 4 Ball Ground School			Fourth Floor Storage
A 2000.1.88 Map	LL 937, Dist 3 (Highway 20) Buffington School			Fourth Floor Storage
A 2000.1.89 Map	LL937, Dist 3 Buffington School			Fourth Floor Storage

Catalog / Objectid / Objname	Description	Condition	Status	Home Location
A 2000.1.90 Map	LL 170, Dist 14 Cherokee Co. Training School			Fourth Floor Storage
A 2000.1.91 Map	LL 130, 159, Dist 14 Cherokee Co. High School			Fourth Floor Storage
A 2000.1.92 Map	LL 179, Dist 14 (Sharptop & Burris Road) Clayton School			Fourth Floor Storage
A 2000.1.93 Map	LL 179, Dist 14 Clayton School			Fourth Floor Storage
A 2000.1.94 Map	LL 158, 159, Dist 14 Canton Elementary School			Fourth Floor Storage

Catalog / Objectid / Objname	Description	Condition	Status	Home Location
A 2000.1.95 Map	LL 160, Dist 14 Canton Elementary School;			Fourth Floor Storage
A 2000.1.96 Map	LL 965, 966, 979, 980, Dist 3 Free Home School (2 plats)			Fourth Floor Storage
A 2000.1.97 Map	LL 326, Dist 15 Hickory Flat School			Fourth Floor Storage
A 2000.1.98 Map	LL 326, Dist 15 Hickory Flat School			Fourth Floor Storage
A 2000.1.99 Map	LL 304, 305, Dist 15 Holly Springs School			Fourth Floor Storage

Catalog / Objectid / Objname	Description	Condition	Status	Home Location
A 2000.1.100 Map	LL 304, 305, Dist 14 Holly Springs School			Fourth Floor Storage
A 2000.1.101 Map	LL 192, 193, Dist 14 North Canton Elementary School			Fourth Floor Storage
A 2000.1.102 Map	LL 192, 193, Dist 14 North canton Elementary School			Fourth Floor Storage
A 2000.1.103 Map	LL 878, Dist 3 Macedonia School Land			Fourth Floor Storage
A 2000.1.104 Map	LL 1124, 1109, Dist 21 Oak Grove School			Fourth Floor Storage

Catalog / Objectid / Objname	Description	Condition	Status	Home Location
A 2000.1.105 Map	LL 40, Dist 14 Waleska School (2 plats)			Fourth Floor Storage
A 2000.1.106 Map	LL 1022, Dist 15 Woodstock School (3 plats)			Fourth Floor Storage
A 2000.1.107 Map	LL 159, Dist 14 Proposed Sewage Treatment Plant			Fourth Floor Storage
A 2000.1.108 Map	LL 74, Dist 14 Adams, Sharon & Bobby			Fourth Floor Storage
A 2000.1.109 Map	LL 165, Dist 14 Andrews, Dr. Charles R. Jr.			Fourth Floor Storage

Catalog / Objectid / Objname	Description	Condition	Status	Home Location
A 2000.1.110 Map	LL 280, Dist 14 Barnes, Mrs. Barbara Wilke			Fourth Floor Storage
A 2000.1.111 Map	LL 126, Dist 14 Bank of Canton			Fourth Floor Storage
A 2000.1.112 Map	LL 166, Dist 14 Baker and Son Funeral Home			Fourth Floor Storage
A 2000.1.113 Map	LL 169, Dist 14 Billingslea, E. D.			Fourth Floor Storage
A 2000.1.114 Map	LL 169, Dist 14 Billingslea, William G.			Fourth Floor Storage

Catalog / Objectid / Objname	Description	Condition	Status	Home Location
A 2000.1.115 Map	LL as shown, Dist 14 Bradshaw, T. B. (J. H. Holcombe estate)			Fourth Floor Storage
A 2000.1.116 Map	LL 239, Dist 14 Boyd, Elmer			Fourth Floor Storage
A 2000.1.117 Map	LL 126, Dist 14 Boettger, Robert T. & Mrs. Jean M.			Fourth Floor Storage
A 2000.1.118 Map	LL 271. 305, 306, Dist 14 Bobo, Eugene			Fourth Floor Storage
A 2000.1.119 Map	LL 168, Dist 14 Callahan, Dean D.			Fourth Floor Storage

Catalog / Objectid / Objname	Description	Condition	Status	Home Location
A 2000.1.120 Map	Cantrel, Paul (property)			Fourth Floor Storage
A 2000.1.121 Map	LL 66, 79, 102 (etc) Carpenter Estate			Fourth Floor Storage
A 2000.1.122 Map	LL 243, Dist 14 Chadwick, Billy G.			Fourth Floor Storage
A 2000.1.123 Map	LL 161, Dist 14 Champoin, Faye & others			Fourth Floor Storage
A 2000.1.124 Map	LL 167, Dist 14 Chlidre Chevrolet			Fourth Floor Storage

Catalog / Objectid / Objname	Description	Condition	Status	Home Location
A 2000.1.125 Map	LL 167, Dist 14 Cherokee Realty and Development Corporation 2 plats			Fourth Floor Storage
A 2000.1.126 Map	LL 167, Dist 14 Cherokee Federal Savings & Loan			Fourth Floor Storage
A 2000.1.127 Map	LL 94, Dist 14 Cloer, Charles K.			Fourth Floor Storage
A 2000.1.128 Map	LL 194, 203, Dist 14 Canton Cotton Mills			Fourth Floor Storage
A 2000.1.129 Map	LL 206, 207, Dist 14 Canton Cotton Mills			Fourth Floor Storage

Catalog / Objectid / Objname	Description	Condition	Status	Home Location
A 2000.1.130 Map	LL 194, 195, 202, 203, 204, 229, 230, 231, 238, 239, 240, Dist 14 Canton Cotton Mills			Fourth Floor Storage
A 2000.1.131 Map	LL 168, Dist 14 Canton Cotton Mills			Fourth Floor Storage
A 2000.1.132 Map	LL 168, 169, Dist 14 Canton Textile Mills			Fourth Floor Storage
A 2000.1.133 Map	LL 168, Dist 14 Canton Cotton Mills			Fourth Floor Storage
A 2000.1.134 Map	LL 195, Dist 14 Canton Cotton Mills			Fourth Floor Storage

Catalog / Objectid / Objname	Description	Condition	Status	Home Location
A 2000.1.135 Map	LL 167, 166, Dist 14 Canton Textile Mills			Fourth Floor Storage
A 2000.1.136 Map	LL 168, Dist 14 Canton Cotton Mills Topo Map			Fourth Floor Storage
A 2000.1.137 Map	LL 166, Dist 14 Canton Textile Mills			Fourth Floor Storage
A 2000.1.138 Map	LL 167, Dist 14 Canton Textile Mills			Fourth Floor Storage
A 2000.1.139 Map	LL 166, Dist 14 Canton Cotton Mills			Fourth Floor Storage

Catalog / Objectid / Objname	Description	Condition	Status	Home Location
A 2000.1.140 Map	LL 166, Dist 14 Canton Textile Mills Part of Hillcrest Subdivision			Fourth Floor Storage
A 2000.1.141 Map	LL 195, 196, Dist 14 Canton Textile Mills			Fourth Floor Storage
A 2000.1.142 Map	LL 195, Dist 14 Canton Textile Mills			Fourth Floor Storage
A 2000.1.143 Map	Dist 14 Canton Textile Mills Large Plat map including multiple land lots			Fourth Floor Storage
A 2000.1.144 Map	LL 69, Dist 14 Collins, Clyde Reinhardt Subdivision			Fourth Floor Storage

Catalog / Objectid / Objname	Description	Condition	Status	Home Location
A 2000.1.145 Map	LL 165, Dist 14 Cotton Producers Association			Fourth Floor Storage
A 2000.1.146 Map	LL 166, Dist 14 Cotton Producers Association Gold Kist			Fourth Floor Storage
A 2000.1.147 Map	LL 166, Dist 14 Cullens, Steve 2 plats			Fourth Floor Storage
A 2000.1.148 Map	LL 156, Dist 14 Cutts, Dr. William G. Jr.			Fourth Floor Storage
A 2000.1.149 Map	LL 240, Dist 14 Crouthers, James L. & Viva, E.			Fourth Floor Storage

Catalog / Objectid / Objname	Description	Condition	Status	Home Location
A 2000.1.150 Map	LL 162, Dist 14 Davidson, Mrs. Dell			Fourth Floor Storage
A 2000.1.151 Map	LL 256, 257, Dist 14 Dobson, Jesse C.			Fourth Floor Storage
A 2000.1.152 Map	LL 160, Dist 14 Dunn, Frank H. 2 plats			Fourth Floor Storage
A 2000.1.153 Map	LL 126, Dist 14 Dunn, Frank H.			Fourth Floor Storage
A 2000.1.154 Map	LL 16, Dist 14 Ellison, C. W. 2 plats			Fourth Floor Storage

Catalog / Objectid / Objname	Description	Condition	Status	Home Location
A 2000.1.155 Map	LL 129, 130, Dist 14 Frye, Bert L. & Chloe D			Fourth Floor Storage
A 2000.1.156 Map	LL 34, Dist 14 Fields, Arthur E. Land			Fourth Floor Storage
A 2000.1.157 Map	LL 20, 21, 52, 53, 54, 55, 56, Dist 14 Fields, E. E. Estate			Fourth Floor Storage
A 2000.1.158 Map	LL 166, Dist 14 Fincher, A. A. Sr. & Jr.			Fourth Floor Storage
A 2000.1.159 Map	LL 128, 161, Dist 14 Galanti, Sam R. & Issac R. et al			Fourth Floor Storage

Catalog / Objectid / Objname	Description	Condition	Status	Home Location
A 2000.1.160 Map	LL89, LL90, LL127, LL128, Dist15 Galanti, Issac			Fourth Floor Storage
A 2000.1.161 Map	LL 166, Dist 14 Galt & Magruder			Fourth Floor Storage
A 2000.1.162 Map	LL 165, Dist 14 Grambling, George Bryce			Fourth Floor Storage
A 2000.1.163 Map	LL 158, Dist 14 Graham, C. O. Jr. & Ellinor Cherokee Heights			Fourth Floor Storage
A 2000.1.164 Map	LL 160, Dist 14 Groves, James L.			Fourth Floor Storage

Catalog / Objectid / Objname	Description	Condition	Status	Home Location
A 2000.1.165 Map	LL 165, Dist 14 Groves, James L.			Fourth Floor Storage
A 2000.1.166 Map	LL 312, Dist 14 Hatcher, Harold P.			Fourth Floor Storage
A 2000.1.167 Map	LL 167, Dist 14 Hendrix, Arthur M.			Fourth Floor Storage
A 2000.1.168 Map 	LL 158, 159, Dist 14 Jones Merchantile Part of Gus Coggins farm Crescent Farm Rock barn			Fourth Floor Storage
A 2000.1.169 Map	LL 158, 159, Dist 14 Jones Merchantile			Fourth Floor Storage

Catalog / Objectid / Objname	Description	Condition	Status	Home Location
A 2000.1.170 Map	LL 157, 158, 167, 168 Jones Merchantile			Fourth Floor Storage
A 2000.1.171 Map	LL as shown, Dist 14 Jones Merchantile Large plat map - multiple land lots			Fourth Floor Storage
A 2000.1.172 Map	LL 194, 195, Dist 14 Jones, R. T. Memorial Library			Fourth Floor Storage
A 2000.1.173 Map	LL 167, Dist 14 Jones, A. V.			Fourth Floor Storage
A 2000.1.174 Map	LL 171, Dist 14 Keith, Wayne & Brenda Sue			Fourth Floor Storage

Catalog / Objectid / Objname	Description	Condition	Status	Home Location
A 2000.1.175 Map	LL 161, Dist 14 Kellog, C. T.			Fourth Floor Storage
A 2000.1.176 Map	LL 167, Dist 14 Key, Vernie L.			Fourth Floor Storage
A 2000.1.177 Map	LL 127, Dist 14 Logan, Leroy			Fourth Floor Storage
A 2000.1.178 Map	LL 91, Dist 14 Mason, William Keneth			Fourth Floor Storage
A 2000.1.179 Map	LL 128, 161, Dist 14 McClure, Mrs.nA. W. & C. A.			Fourth Floor Storage

Catalog / Objectid / Objname	Description	Condition	Status	Home Location
A 2000.1.180 Map	LL 125, 126, Dist 14 McKinney, Norman			Fourth Floor Storage
A 2000.1.181 Map	LL 164, Dist 14 Moore, Hardie			Fourth Floor Storage
A 2000.1.182 Map	LL 161, Dist 14 Moore, J. D. Rich Copper Mine property			Fourth Floor Storage
A 2000.1.183 Map	LL 122, Dist 14 New Hightower Baptist Church & Cemetery			Fourth Floor Storage
A 2000.1.184 Map	LL 262, Dist 14 Nations, George			Fourth Floor Storage

Catalog / Objectid / Objname	Description	Condition	Status	Home Location
A 2000.1.185 Map	LL 227, Dist 14 Owens, Howard G.			Fourth Floor Storage
A 2000.1.186 Map	LL 128, 129, Dist 14 Oakdale Baptist Church			Fourth Floor Storage
A 2000.1.187 Map	LL 162, Dist 14 Payne, Johnny & Lynn			Fourth Floor Storage
A 2000.1.188 Map	LL 158, Dist 14 Pinyan, Louise Cherokee Heights Subdivision			Fourth Floor Storage
A 2000.1.189 Map	LL 228, Dist 14 Pitts, Jack Keith Cemetery			Fourth Floor Storage

Catalog / Objectid / Objname	Description	Condition	Status	Home Location
A 2000.1.190 Map	LL 195, Dist 14 Raines, J. R. Forest Hills Subdivision			Fourth Floor Storage
A 2000.1.191 Map	LL 120, 133, Dist 14 Hembree, George R. Rock Creek Estates			Fourth Floor Storage
A 2000.1.192 Map	LL 170, Dist 14 Roach, William Preston			Fourth Floor Storage
A 2000.1.193 Map	LL 168, Dist 14 Roach, Thomas A.			Fourth Floor Storage
A 2000.1.194 Map	LL 165, 166, Dist 14 Roberts, Harley Coggins Estate			Fourth Floor Storage

Catalog / Objectid / Objname	Description	Condition	Status	Home Location
A 2000.1.195 Map	LL 167, Dist 14 Rosenblum, S. I. 2 plats			Fourth Floor Storage
A 2000.1.196 Map	LL 322, Dist 14 Shiloh Methodist Episcopal Church			Fourth Floor Storage
A 2000.1.197 Map	LL 128, Dist 14 Steakley, Mrs. Irene			Fourth Floor Storage
A 2000.1.198 Map	LL 158, Dist 14 Stewart, Howell E.			Fourth Floor Storage
A 2000.1.199 Map	LL 170, Dist 14 Stone, Ernest Jr.			Fourth Floor Storage

Catalog / Objectid / Objname	Description	Condition	Status	Home Location
A 2000.1.200 Map	LL 158, Dist 14 Cherokee Heights Near Pink Swink			Fourth Floor Storage
A 2000.1.201 Map	LL 158, Dist 14 Swink, Pink Jr. & Kathryn S.			Fourth Floor Storage
A 2000.1.202 Map	LL 158, Dist 14 Wallace, Lloyd T.			Fourth Floor Storage
A 2000.1.203 Map	LL 243, Dist 14 Wilbanks, N. J.			Fourth Floor Storage
A 2000.1.204 Map	LL 319, 320, Dist 14 Wilbanks, F. E.			Fourth Floor Storage

Catalog / Objectid / Objname	Description	Condition	Status	Home Location
A 2000.1.205 Map	LL 202, 203, Dist 14 Whitman, N. S.			Fourth Floor Storage
A 2000.1.206 Map	LL 280, Dist 14 Wilkie, Mrs. E. Herman			Fourth Floor Storage
A 2000.1.207 Map	LL 175, Dist 14 Worley, Taylor			Fourth Floor Storage
A 2000.1.208 Map	LL 167, Dist 14 Worley, Clyde			Fourth Floor Storage
A 2000.1.209 Map	LL 274, Dist 14 No Name			Fourth Floor Storage

Catalog / Objectid / Objname	Description	Condition	Status	Home Location
A 2000.1.210 Map	LL 275, Dist 14 no name			Fourth Floor Storage
A 2000.1.211 Map	LL 126, Dist 14 no name			Fourth Floor Storage
A 2000.1.212 Map	LL 129, Dist 15 Adams, Mr. & Mrs. Gary L.			Fourth Floor Storage
A 2000.1.213 Map	LL 10, Dist 3 Ball Ground Proposed New Post Office Property			Fourth Floor Storage
A 2000.1.214 Map	LL 346, Dist 15 Bailey, Douglas L			Fourth Floor Storage

Catalog / Objectid / Objname	Description	Condition	Status	Home Location
A 2000.1.215 Map	LL 346, Dist 15 Bailey, Douglas L. & Florrie Jo Subdivisdion			Fourth Floor Storage
A 2000.1.216 Map	LL 10, Dist 3 Citizens Bank - Ball Ground			Fourth Floor Storage
A 2000.1.217 Map	LL 1164, 1213, Dist 15 Boddy, Dr. A. E. Woodstock 2 plats			Fourth Floor Storage
A 2000.1.218 Map	LL 13, Dist 15 Booth, Joseph Carlton Harbin Subdivision 2 plats			Fourth Floor Storage
A 2000.1.219 Map	LL as shown, Dist 14 Bradshaw, T. B.			Fourth Floor Storage

Catalog / Objectid / Objname	Description	Condition	Status	Home Location
A 2000.1.220 Map	LL 89, 127, 128, Dist 15 Bradshaw, T. B. property 2 plats			Fourth Floor Storage
A 2000.1.221 Map	LL as shown, Dist 15 Bradshaw, T. B.			Fourth Floor Storage
A 2000.1.222 Map	LL 133, 156, 157, Dist 2 Braswell, C. N.			Fourth Floor Storage
A 2000.1.223 Map	LL 100, 101, Dist 15 Bray, H. Michael			Fourth Floor Storage
A 2000.1.224 Map	LL 18, Dist 15 Brigham, Charles Rolling Hills Heights Subdivision			Fourth Floor Storage

Catalog / Objectid / Objname	Description	Condition	Status	Home Location
A 2000.1.225 Map	LL 56, Dist 15 Brown, Mr. & Mrs. John F. Rolling Hills Heights Subdivision			Fourth Floor Storage
A 2000.1.226 Map	LL 101, Dist 15 Cagle, William C. Askew Property			Fourth Floor Storage
A 2000.1.227 Map	LL 132, Dist 15 Canton, City of 3 plats			Fourth Floor Storage
A 2000.1.228 Map	LL 296, 353, Dist 15 Cantrell, Charles W.			Fourth Floor Storage
A 2000.1.229 Map	LL 5, 6, Dist 2 Carmichael, Robert Trammell			Fourth Floor Storage

Catalog / Objectid / Objname	Description	Condition	Status	Home Location
A 2000.1.230 Map	LL 899, 900, Dist 15 Cook, Mrs. Estelle, Archie L. & Milton Doyle			Fourth Floor Storage
A 2000.1.231 Map	LL as shown, Dist 3 Coker, Dr. G. N. 4 plats			Fourth Floor Storage
A 2000.1.232 Map	LL 815, Dist 3 Cowart, Ira			Fourth Floor Storage
A 2000.1.233 Map	LL 1153, 1224, Dist 15 DeNeergaard, Jules S.			Fourth Floor Storage
A 2000.1.234 Map	LL 1152, 1153, 1224, Dist 15 DeNeergaard, Jules S. & J. C. Berthelson			Fourth Floor Storage

Catalog / Objectid / Objname	Description	Condition	Status	Home Location
A 2000.1.235 Map	LL 623, 633, Dist 15 Dobson, Mrs. Vena			Fourth Floor Storage
A 2000.1.236 Map	LL 926, 946, 947, 948, Dist 15 Dorsey, William H.			Fourth Floor Storage
A 2000.1.237 Map	LL 1004, Dist 3 Eubanks, James Phillip			Fourth Floor Storage
A 2000.1.238 Map	LL 161, 162, Dist 2 Frederick, B. W.			Fourth Floor Storage
A 2000.1.239 Map	LL 157 Dist 3 Fowler, Stanley R.			Fourth Floor Storage

Catalog / Objectid / Objname	Description	Condition	Status	Home Location
A 2000.1.240 Map	LL 10, 11, Dist 2 Gaddis, Thomas W.			Fourth Floor Storage
A 2000.1.241 Map	LL 889, 912, Dist 3 Gather, Ralph L.			Fourth Floor Storage
A 2000.1.242 Map	LL 720 & others, Dist 3 & 14 Griffin, Govenor Marvin			Fourth Floor Storage
A 2000.1.243 Map	LL 272, Dist 15 Groover, Billy J. & Joann Gilder			Fourth Floor Storage
A 2000.1.244 Map	LL 1101 etc. as shown, Dist 15 Gunnin, J. F. Estate			Fourth Floor Storage

Catalog / Objectid / Objname	Description	Condition	Status	Home Location
A 2000.1.245 Map	LL 36, Dist 15 Haley, Fred C.			Fourth Floor Storage
A 2000.1.246 Map	LL 181, 182, Dist 15 Haley, Fred and Ernest			Fourth Floor Storage
A 2000.1.247 Map	LL 1144, Dist 3 Harbin, Carl E.			Fourth Floor Storage
A 2000.1.248 Map	LL 129, Dist 15 Harbin, Mrs. Johnny & Adams, Mr and Mrs Gary L			Fourth Floor Storage
A 2000.1.249 Map	LL 343, Dist 15 Hardin, J. T. Estate Holly Springs			Fourth Floor Storage

Catalog / Objectid / Objname	Description	Condition	Status	Home Location
A 2000.1.250 Map	LL 207, 208, etc, Dist 15 Haynes, Mrs. J. E.			Fourth Floor Storage
A 2000.1.251 Map	LL 860, 869, etc, Dist 2 Hedden, Jeff A.			Fourth Floor Storage
A 2000.1.252 Map	LL89, Dist 15 Hobgood, Mrs. Annie Q			Fourth Floor Storage
A 2000.1.253 Map	LL 60, 61, 84, 85, Dist 15 Holcomb, T. E.			Fourth Floor Storage
A 2000.1.254 Map	LL ???, Dist 15 Holly Springs Lumber Company			Fourth Floor Storage

Catalog / Objectid / Objname	Description	Condition	Status	Home Location
A 2000.1.255 Map	LL 1149, 1150, Dist 3 Holtzclaw, Mrs. Chlora			Fourth Floor Storage
A 2000.1.256 Map	LL 110, 111, Dist 15 Johnson, Claud W.			Fourth Floor Storage
A 2000.1.257 Map	LL 89, 90, Dist 15 Johnston, Kate Simmons & Reece, Grace S.			Fourth Floor Storage
A 2000.1.258 Map	LL 875, 876, & Others, Dist 15 Johnston, Smith L. Jr. 2 plats			Fourth Floor Storage
A 2000.1.259 Map	LL 1139, 1166, Dist 15 Johnston, Smith L.			Fourth Floor Storage

Catalog / Objectid / Objname	Description	Condition	Status	Home Location
A 2000.1.260 Map	LL 163, Dist 15 Killian, Mrs. Fred			Fourth Floor Storage
A 2000.1.261 Map	LL 89, Dist 15 Lankster, Mrs. A. L. & Wilson, Mrs. Addie			Fourth Floor Storage
A 2000.1.262 Map	LL 1022, 1095, Dist 3 Lawson, W. L. & Son			Fourth Floor Storage
A 2000.1.263 Map	LL 221, 222, Dist 2 Lawson, Paul			Fourth Floor Storage
A 2000.1.264 Map	LL 200, 201, 233, Dist 15 Lester, Dr. W. L.			Fourth Floor Storage

Catalog / Objectid / Objname	Description	Condition	Status	Home Location
A 2000.1.265 Map	LL 233, 234, 272, Dist 15 McCurley, D. J. Estate			Fourth Floor Storage
A 2000.1.266 Map	LL 234, Dist 15 McCurley, Ray			Fourth Floor Storage
A 2000.1.267 Map	LL 414, Dist 15 McWhirter, Mrs. Earl L.			Fourth Floor Storage
A 2000.1.268 Map	LL 16, Dist 15 Neath, Mrs. S. C. & Fronebarger, Mrs. Martha			Fourth Floor Storage
A 2000.1.269 Map	LL 472, 473, 536, Dist 15 Phelps, James H.			Fourth Floor Storage

Catalog / Objectid / Objname	Description	Condition	Status	Home Location
A 2000.1.270 Map	LL 756, Dist 15 Pinyan, Sam & Florine			Fourth Floor Storage
A 2000.1.271 Map	LL 165, 196, Dist 15 Pitts, David M. & Janice S McInnish, Gary N. & Ann S. Univeter Rd & Lakeview Dr.			Fourth Floor Storage
A 2000.1.272 Map	LL 277, 299, 300, Dist 15 Poole, Arnold Land			Fourth Floor Storage
A 2000.1.273 Map	LL 1019, 1020, 1069, 1070, Dist 15 Poore, James H. & Johnston, Smith L. Jr.			Fourth Floor Storage
A 2000.1.274 Map	LL 90, 127, Dist 15 Ralston Purina Company			Fourth Floor Storage

Catalog / Objectid / Objname	Description	Condition	Status	Home Location
A 2000.1.275 Map	LL 1133, Dist 3 Rich, Pat Jr. 2 plats			Fourth Floor Storage
A 2000.1.276 Map	LL 306, Dist 15 Sams, H. M. Estate			Fourth Floor Storage
A 2000.1.277 Map	LL 65, Dist 3 Stancil, Steven L. & Christina			Fourth Floor Storage
A 2000.1.278 Map	LL 683, 686, Dist 15 Shelton, F. J. Property			Fourth Floor Storage
A 2000.1.279 Map	LL 141, 142, Dist 2 Thomas, K. M. Estate			Fourth Floor Storage

Catalog / Objectid / Objname	Description	Condition	Status	Home Location
A 2000.1.280 Map	LL 119, Dist 15 Thompson, James D.			Fourth Floor Storage
A 2000.1.281 Map	LL 633, 634, Dist 15 Toonigh Baptist Church			Fourth Floor Storage
A 2000.1.282 Map	LL 965, 966, etc., Dist 3 West, R. E. Estate 2 plats plus prints of adjacent properties			Fourth Floor Storage
A 2000.1.283 Map	LL 209, 224, Dist 15 Wheeler, Charles W.			Fourth Floor Storage
A 2000.1.284 Map	LL 592, 593, Dist 15 Worley, Eugene			Fourth Floor Storage

Catalog / Objectid / Objname	Description	Condition	Status	Home Location
A 2000.1.285 Map	LL 19, Dist 15 Sunset Heights Subdivision			Fourth Floor Storage
A 2000.1.286 Map	LL 909, 892, Dist 3 no name			Fourth Floor Storage
A 2000.1.287 Map	Acworth cemetery layout			Fourth Floor Storage
A 2000.1.288 Map	LL 196, 197, 200, 201 Golf course, Hickory Flat Road, Jones Merchantile			Fourth Floor Storage
A 2000.1.289 Map	Canton Methodist Church Property lines			Fourth Floor Storage

Catalog / Objectid / Objname	Description	Condition	Status	Home Location
A 2000.1.290 Map	Acworth Cemetery New Colored section			Fourth Floor Storage
A 2000.1.291 Map	LL 128, 129 Oakdale Baptist Church			Fourth Floor Storage
A 2000.1.292 Map	LL 166, Dist 14 Spears, Rosco P. Sr. First Baptist Church			Fourth Floor Storage
A 2000.1.293 Map	LL 166, Dist 14 Property Fronting Elizabeth St.			Fourth Floor Storage
A 2000.1.294 Map	Land Lot Overlay			Fourth Floor Storage

Catalog / Objectid / Objname	Description	Condition	Status	Home Location
A 2000.1.295 Map	Topography for planning Health and Med Center on North Church, adjacent to Cherokee County Courthouse & A. V. Jones residence			Fourth Floor Storage
A 2000.1.296 Map	LL as shown, Dist 14 Waleska - Route 140			Fourth Floor Storage
A 2000.1.297 Map	LL 106 and surrounding area, Dist 13 Donald Walton Property			Fourth Floor Storage
A 2000.1.298 Map	LL as shown, Dist 13 Cherokee-Pickins County Line			Fourth Floor Storage
A 2000.1.299 Map	LL 73, Dist 14 Towsend, Bobby & Becky			Fourth Floor Storage

Catalog / Objectid / Objname	Description	Condition	Status	Home Location
A 2000.1.300 Map	Parts of Dist 13 & 14 Georgia 20 - Etowah River			Fourth Floor Storage
A 2000.1.301 Map	Parts of Dist 21, 22, 14, 15 Corner			Fourth Floor Storage
A 2000.1.302 Map	Parts of Dist 22, 14\ Shoal Creek into Etowah			Fourth Floor Storage
A 2000.1.303 Map	Part of Dist 3, 4 from Aerial Photo			Fourth Floor Storage
A 2000.1.304 Map	LL 196, 197, 200, 201			Fourth Floor Storage

Catalog / Objectid / Objname	Description	Condition	Status	Home Location
A 2000.1.305 Map	LL as shown, Dist 15 Bank of Canton Property			Fourth Floor Storage
A 2000.1.306 Map	Part of Dist 2, 3, 14, 15 Hickory Flat Road - 140 - South Buffington - North from 1960 Aerial Photo			Fourth Floor Storage
A 2000.1.307 Map	Part of Dist 14, 15 fom Aerial Photo 1969 shows old stage coach route stagecoach			Fourth Floor Storage
A 2000.1.308 Map	LL 307, Dist 13, LL 289, 324, Dist 14			Fourth Floor Storage
A 2000.1.309 Map	Part of Dist 22, 14 from 1938 Aerial Photo Waleska North - Shoal Creek			Fourth Floor Storage

Catalog / Objectid / Objname	Description	Condition	Status	Home Location
A 2000.1.310 Map	LL 120, 133, Dist 14 Rock Creek Estates George R. Hemberee Property			Fourth Floor Storage
A 2000.1.312 Map	City of Canton (F - L) All District 14, Section 2 LL 194 - Fincher, Jack L. - 1965 (2 copies) LL 165 - Fincher, R. Olin Sr. - 1964 LL 202 - Foster, J. D. - 1959 LL 157 - Fowler, Arnold, etc - 1974 LL 165 - Fraser, Novia B. & Doris Reed - 1963 LL 165 - Gable, Manuel (City lots - Arcadia Subdivision) 1949 LL 203 - Garrett, Joseph O. - 1952 LL 195 - Garrett, Harry L. (Cherokee St.) - 1954 LL 195 - Gay, E. E. - 1960 LL 195 - Harbin, Mrs. Alice - 1961 LL 165 - Harbin, Gibbs N. Estate - 1952 LL 166 - Heard, Mrs Arah - 1967 LL 195 - Henderson, A. J. - 1950 LL 167 - Hendrix, Dr. Arthur M. & Jones Mercantile - 1954 (3 plats) LL 202 - Hendrix, T. C. - 1959 LL 195 - Hobgood, Jimmy - 1974 LL 195 - Holcombe, E. F. - 1952 LL 165 - Ingram, James R. - 1957 LL 202, 203 - Jones, L. L. Jr. - 1948 LL 194, 195, 202, 203 - Jones, L. L. Jr. - 1969 LL 194 - Johnston, Dr. Charles L. - 1954 LL 160 - Lanier, Wm. P. 1968 LL 195 - Lathem, Gene R. - 1958 LL 195 - Lathem, Robert I. Jr. - 1957 LL 165 - Lawson, J. L. - 1956 LL 166 - Lawson, R. G. - 1949 LL 168 - Loggins, Harvey - 1975 LL 194 - Looper, Dr. B. K. - 1951 (2 plats)			Fourth Floor Storage

Catalog / Objectid / Objname	Description	Condition	Status	Home Location
A 2000.1.313 Map	City of Canton (M - Z) All District 14, Section 2 LL 165 - Manous, John W. - 1963 LL 195 - Martz, G. H. - 1968 LL 194, 202, 203 - McCanless, E. A. Home Lands - 1947 LL 195 - McCanless, Lee - 1968 LL 195 - Methodist Church (Murial St.) 1957 LL 166 - Nichols, Dr. Wm. H. (Clinic) - 1955 LL 129 - Ogletree, Hugh - 1966 LL 195 - Owen, C. E. - 1949 LL 166 - Palmer, Jim (Jarvis St) - 1952 LL 165 - Payne, Louis - 1949 (2 plats) LL 166 - Peoples Financial Corporation - 1967 LL 194 - Reid, Clayton (Proposed Homesite) 1954 LL 194 - Reid, Albert Clayton Jr. - 1955 LL 202 - Reynolds, Roy (part of Observation Hill 1919) - 1952 LL 167 - Riverdale Baptist Church - 1969 LL 167 - Roberts, A. R. (North St.) - 1965 LL 202 - Rosenblum, S. I. (Jeanette Ave) - 1950 LL 167 - Rosenblum, S. I. (Main & North Sts.) - 1952 LL 167 - Rosenblum Property and Store - 1963 LL 165 - Settle, W. H. (Scott Mill Road) - 1954 LL 195 - Sieg, - 1963 LL 129 - Thacker, Hugh & Marlene - 1968 LL 165 - Thacker, Hugh & Marlene - 1975 LL 167 - Thompson Property (North and Dupree Sts.) 1952 LL 195 - Thompson, Tom W. - 1952 LL 203 - Turner, John M. - 1965 LL 165 - Welchel, James R. 1969 LL 165 - Wood, Elbert D. - 1972			Fourth Floor Storage
A 2000.1.314 Map	Canton south of Town Creek and Etowah River LL 161 - Moore, J. D. mentions Copper Mine LL 160 - Abernathy, Louise LL 165 - City of canton Marietta Rd, Scott Mill, 140 LL 165 - South canton Addition - 1919, 1907 - 7 various maps Sunnyside Addition- LL164, LL161- 9 various maps Arcadia Subdivision - 1924 - 5 various maps LL128, LL161- Sam R. and Isaac R. Galanti 1965- 2 copies LL128, LL129- Oakdale Baptist Church LL164, LL165, LL196, LL197, LL201, LL202 Marietta, Scott Mill, 140 Old Ga Hwy 5 and New Georgia Hwy 5- 2 copies LL164, LL197- Broad St. and East South St.- 4 copies Marietta Rd, Cartersville Rd, Kennett St.			Fourth Floor Storage

Catalog / Objectid / Objname	Description	Condition	Status	Home Location
	LL160, LL161, LL164, LL165, LL196, LL197 LL37- Dr. F. Max Grist LL196- W.A. Kelley 1969- Kelley's Store at Scott Mill and 140 LL160- J.E. Pruitt LL6- Gus B. Dobson LL165- Louis Payne- 2 maps- 140 and Scott Mill- shows Old Pauper's Home location LL201, LL202, LL231, LL232- Cherokee County JH Holcomb Estate, Canton Golf Course LL201- Claude W. Hopkins Marietta St and Etowah St LL196, LL165 Carlton Cronkite Copper Mine Hill Robert J. Harbin, McLain St. LL161- Crestview J.M. Steel- 2 maps, Marietta Hwy Kennett St, National Hwy, McClure St. JC Boling 1956 Edwards & marietta St Block C			

A 2000.1.315
Map

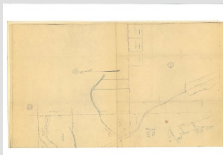

Canton Misc.
LL 165, 166, 196, 197 - Gus Coggins Estate in Bankruptcy - 1927
Brown, Joseph E. Estate - 1905 Shows location of Jail on Church St.; Ellis House; Canton Bank or corner of Marietta & Main; Webb House; post office and College St. now Archer; old Baptist church (see image attached)
Crissler & Teasley Addition - 1908
Canton Cotton Mills property North canton Heights topo map - 1959
City of Canton LL130, LL159, LL129, LL160, LL131 proposed Cherokee High site
Cherokee County LL201, LL202 Dist14 Sec2
LL157, LL158, LL167, LL168 Shows RT Jones Hospital
Scrap Paper
LL202, LL195 Hospital Circle
LL6, LL7, LL8, LL9, LL15, LL16, LL17, LL18, LL19, LL20, LL21, LL22, LL23, LL24, LL25, LL26 - Residential lots Coker & Thacker St.
Coker Rest Home LL202, LL195
B.F. Crisler Dist14, Sec2, LL202, LL203
Dist14, Sec2, LL195 Jones Mercantile property
North St. and Main St. before joined owned by Jones Mercantile 1966
Waleska Hwy and Hospital Road 1959 with other copies
Dist14, Sec2, LL201, LL202, LL231, LL232 J.H. Holcomb estate,

Fourth Floor Storage

Catalog / Objectid / Objname	Description	Condition	Status	Home Location
	<p>shows golf course 1957 T. Barron Gibson Dist14, Sect2, LL195 1959 CC Mill Property LL193, LL194, LL203, LL204 city of Canton 1954 and traced copy LL166 for Board of Education 1966 LL196, LL197, LL200, LL201 Hwy 140, golf course, planing mill, scott mill ck LL130, LL131, LL158, LL159 on Etowah LL168- Miss Lois Edge 1958 LL195- Mrs. Pauline Chambers 1965 LL167 Canton Cotton Mill property intersection Hwy 5 and 140 1958 Gulf Service Station, Depot St, Marietta St. 1962 Main St, Church St, Spring St. Etowah Ave, Cherokee Ave, Oak St. LL194- Howard Baker, Ga 20 and church St. 1957 LL165- Novia B. and Doris Reid Fraser 1963 shows Harmon Field LL201- Howard Yarbrough 1954 LL166- Galt Property W. Marietta and E. Marietta, 1938 LL167- Si Rosenblum store next to residence, North St. 1963 LL168- Eugene T. Price 1951 LL11, LL12, LL13, LL14- Roy Stancil Golf Course Road Main St. Marietta St. L.L. Jones, Jr., LL194, LL203 shows old Brown Rd; Chamlee; Britt; Main St. Canton</p>			
A 2000.1.316 Map	<p>Ball Ground Property Surveys Dist 3 & 4, Section 2 LL 9 - Allison, Mrs. Lila G. & J. L. - 1954 (Original & 2 blue prints) LL 64, 81 - Farmer, J. E. - 1949 LL 10 - Gentry, Kenneth - 1969 LL 9 - Greif, Dale J. - 1954 LL 10 - Henson, Weldon - lots 2 & 3, Block Q - 1952 LL 83 - Holcombe, Mrs. Emma D. - 1947 LL 10 - Hovanec, John & Bessie C. - 1971 LL 338 - Jordon, Mrs. W. T. - 1956 LL 9 - Kelley, Thomas - 1964 LL 10 - Nelson, Ballground Telephone Co. - 1951 LL 63 - Roach, James E. (Lots 3, 4 & 5 Block K) - 1955 LL 10, 338 - Roberts, A. W. Estate - 1962 LL 10 - Ward, Mrs. John B. - 1961 LL 309 - Wlikie, Edd - 1951</p>			Fourth Floor Storage

Catalog / Objectid / Objname	Description	Condition	Status	Home Location
A 2000.1.319 Map	Cherokee County District 2, Section 2 - A - J LL 502 - Bailey, Doyle Lee - 1966 LL 27 - Bennett, Allie R - 1961 LL 27 - Bennett, Allie R. - 1956 LL 867 - Berger, Chester A. - 1964 LL 644, 581, 582 - Bobo, A. L. - 1948 LL 436 - Blalock, H. V. - 1960 LL 133 - Braswell, C. N. - 1955 LL 867 - Callahan, Daniel Ray & John Patrick - 1963 LL 357 - Carmichael, Johnny B. - 1970 LL 932, 933, 939, 940 - Carson, W. C. - 1955 LL 220, 221 - Clarke & Clarke - 1965 LL 86, 59 - Church & Cemetery - Union Hall Methodist - 1957 LL 494, 514, 515 - Cobb, Lawrence - 1951 LL 80 - Coker Property - 1961 LL 81 - Coker, Frank - 1960 LL153 - Danger, R. L.. - 1959 LL 212 - Davenport, J. G. - 1957 LL 436 - Darby, James R. - 1962 LL 656 - Earney, E. S. & Lester Owen - 1956 LL 795, 796, 863, 862 - Galbrath, Mrs. Laura - 1963 (Grimes Est.) LL 234 - Gilbert, Mrs. Irene - 1965 LL 27 - Gilbert, Georgia Vivian - 1968 LL 81, 64 - Graham, Charles T. - 1958 LL 58 - Graham, Jerry L. - 1971 LL 56 - Graham, Edwin - 1972 LL 174 - Heard, James C. 1972 LL 72 - Haley, Roy - 1952 LL 1, 72 - Haley, Fred C. - 1951 LL 1 & LL 1296 Dist 3 & LL 36 Dist 15 - Haley, Fred - 1957 LL 867 - Harris, Joel Chandler - 1974 LL 81 - Hamby, Jerry - 1960 LL 134 - Henderson, Frank - 1967 LL 134, 135, 154 - Johnston, Dr. J. C. - 1965 LL 287, 290 - Jones, L. S.. - 1957			Fourth Floor Storage
A 2000.1.320 Map	Cherokee County District 2, Section 2 L - R LL 136 - Lance, Lance J. - 1967 LL 35 - Lewis, Olen - 1963 LL653 - Lingefelt, George - 1948 LL 357, 358 - Mason, Milford & Patsy - 1968 LL 638, 639 - Maxey, James H. - 1962 LL 786, 787, 799 - Maxwell, Mrs. Nancy Waits - 1953			Fourth Floor Storage

Catalog / Objectid / Objname	Description	Condition	Status	Home Location
	LL 120, 169, 192 - McAteer, Ted P. & Aronson, Hal J. - 1952			
	LL 507 - McClure, C. Weldon - 1964			
	LL 215, 216, 217, 218 - McBrayer, George W. - 1958			
	LL 224, 225 - McGahee, Ewell F. & mary E. - 1958			
	LL 224, 225 - McGahee, Ewell F. & mary E. (proposed lake) - 1958			
	LL 361 - Morris, Michael & patricia - 1969			
	LL 363 - Moss, Corbett A. - 1958			
	LL 794, 795, 862, 863 - Norton, Mrs. W. E. - 1953			
	LL 131 - Pinyan, Luke S. - 1975			
	LL 109 - Price, Ernest P. - 1955			
	LL 55 - Price, lee - 1971			
	LL 138 - Pressley, W. A. Jr. - 1958			
	LL 435, 434. 502 - Rayburn, Billy - 1966			
	LL 434 - Ray, Alvin P. 1965			
	LL 428, 529, 430 - Reece, Loyd E. - 1966			
	LL798 - Rampley, Daniel Boyd & Bradbury, Thomas L. - 1971			
	LL 351, 352, 369, 370 - Reece, S. W. - 1954			
	LL 14 - Ripley, Allen W. - 1963			
	LL 862 - Rusk, Parkes - 1955			
	LL 795 - Rusk, Parks - 1957			
A 2000.1.321 Map	Cherokee County District 2, Section 2 S - Z LL 798 - Sims, Floyd C. - 1953 LL 574, 575 - Southern, Mrs. Emma - 1966 LL 141, 142, 148 - Thomas, Bentley M. 1952 LL 81 - Thomas, lawson Jr. - 1960 LL 420, 421 - Todd, Mrs. R. R. - 1954 LL 132 - Walters, L. E. - 1964 LL 934 - Whitworth, Eugene - 1960 LL 299 - Wheeler, Jerry Franklin - 1974 LL 289 - Wilson, Reuben O. _ 1957			Fourth Floor Storage
A 2000.1.322 Map	Cherokee County District 3, Section 2 A - E LL 811 - Acevedo, L. E. 1971 LL 942 - Askew, Howard K. - 1960 LL 934, 935 - Arrowhead Development Corp. - 1974 LL 774, 811 - bagwell, C. G. - 1951 LL 944 - Beavers, james A. - 1967 LL 935, 938 - Bell, M. V. - 1962 LL 1083, 1084 - Blanton, Bobby E. - 1963 LL 934, 935, 938 - Brickey, M. C. - 1973 LL 1078, 1079, 1082, 1083 - Brown, Joe - 1952 LL 65 - Byrd, Dorothy - 1957			Fourth Floor Storage

Catalog / Objectid / Objname	Description	Condition	Status	Home Location
	LL 83 - cain, J. Frank - 1953			
	LL 771 - Calvary Baptist Church - 1969			
	LL 1220, 1229 - Carmichael, W. G. Estate - 1965			
	LL 1220 - Carmichael, Trammell - 1970			
	LL 1105 - Church Trinity Presbyterian - 1958			
	LL 907 - Cochran, Emmitt - 1966			
	LL 835, 836 - Cochran Property - 1958			
	LL 1285, 1286 - Coker, Robert B. - 1964			
	LL 1090, 1091, 1102, 1103 - Collett, Jack A. - 1959			
	LL 708 - Collett, Mr. & Mrs. L. G. - 1965			
	LL 928 - Cook, Herbert C. - 1957			
	LL 1007 - Conn, Allen - 1971			
	LL 162, 127, 126 - Cornlison, Arvine, B. - 1959			
	LL 65, 66 - Cowart, Mannifred - 1963			
	LL 1183 - Cox, Jimmy R. - 1975			
	LL 1078, 1079, 1082, 1083 - Cox, T. T. - 1964			
	LL 952 - Densmore, W. H. - 1955			
	LL 952 - Densmorre, ray F. - 1956			
	LL 938 - Dobson, Lamar - 1962			
	LL 1045, 1046 - Echols, J. D. - 1951			
	LL 85, 132 - Edwards, Jack A. - 1961			
	LL 683 - Edwards, J. A. - 1957			
	LL 936, 937 - Edwards, Jay Y. - 1958			
	LL 951, 994 - Elrod, Hubert - 1967			
A 2000.1.323 Map	Cherokee County District 3, Section 2 F - J LL 1081, 1152 - Fowler, James A. - 1966 LL 567 - Fowler, Ray W. - 1957 LL 1010 - Frady, Olen Eugene - 1966 LL 1081, 1082, 1151 - Frady, George Lenford - 1966 LL 1227, 1294 - Garrett, Jesse T. - 1970 LL 1003 - Garrison, Joe - 1954 LL 942, 1003, 1014, 1075 - Garrison, Joe A. - 1957 LL 1044, 1045 - Gayton, Ernest E. - 1954 LL 942, 1003 - Gilleland, L. J. - 1958 LL 1001 - Gilleland, L. J. - 1958 LL940, 1005 - Green, Hubert C. - 1958 LL 1150, 1151, 1154, 1155 - Haley, G. L. - 1954 LL 1010 - Harbin, Samuel R. - 1971 LL 935, 936 - Harrison, J. J. & Bell, M. V. - 1957 LL 1083, 1150 - Hathcock, G. L. - 1951 LL 967, 968 - Hester, Gene Harlod - 1956 LL 813 - Hester, Roy - 1957 LL 1010, 1011, 1012 - Hembree, Dean - 1956			Fourth Floor Storage

Catalog / Objectid / Objname	Description	Condition	Status	Home Location
	LL 295 - Hendrix, W. H. - 1966 LL 1169, 1170 - Hendrix, J. W. - 1951 LL 1078 - Hill, Hoyt & Wanda - 1965 LL 845, 884, 917 - Holcomb, C. B. - 1968 LL 211 - Holcomb, Verlyn - 1966 LL 1155, 1150, 1149 - Holtzclaw, Mrs. Chlora - 1960 LL 1144 - Hyde, Clebert - 1966 LL 210, 211 - Jones, R. C. - 1960 LL 213, 220 - Jordan, J. T. - 1956			
A 2000.1.324 Map	Cherokee County District 3, Section 2 (K - S) LL 430, 429, 428, 437 - Lawson, R. G. - 1957 LL 430, 429 - Lawson, Glenn & Humphery - 1951 LL 889 - Lathem, Alton G. - 1961 LL 910 - Lathem, Hollis - 1961 LL 909 - lathem, F. H. - 1966 LL 281 - Lumpkin, James J. - 1970 LL 211 - Lumpkin, James J. - 1972 LL 1007, 1010 - Lusk, J. K. - 1954 LL 849, 850 - Macedonia Old School Lot - 1957 LL 1040 - McClure, Robert N. 1950 LL 440 - Mid State Homes, Inc. - 1963 LL 1010 - Nations, Monroe - 1971 LL 1151 - Mullinax, Sam M. - 1966 LL 815, 816 - Padgett, Sandra Y. - 1971 LL 968 - Pearson, Eugene - 1963 LL 967, 978 - Pearson, Thomas Lee - 1961 LL 1022 - Phipps, Wayne - 1970 LL 567 - Pinyan, T. K. & Sandra Joyce - 1970 LL 979, 1038 - Purcell, F. M. - 1954 LL 870, 871 - Quarles, Mrs. Evelyn & Mrs. Elsie Cook - 1959 LL 67, 68, 77 - Rainey, Mrs. D. L. - 1962 LL 1282, 1283 - Ripley, Mrs. Ruth W. - 1965 LL 954 - Richards, Miller - 1962 LL 833, 834, 823, 753 - Roper, Holman H. - 1949 LL 635 - Saggus, Mrs. Thelma C. - 1952 LL 970, 971, 902, 903, 904 - Satterfield, H. V. Jr. - 1948 LL 708, 709, 732 - Scott, John & Mary - 1964 LL 895 - Smith, C. W. - 1959 LL 839, 890 - Smith, Mrs Tom & other lots - 1962 LL 65 - Stancil, R. Max - 1955			Fourth Floor Storage

Catalog / Objectid / Objname	Description	Condition	Status	Home Location
A 2000.1.325 Map	Cherokee County District 3, Section 2 (T - Z) LL 996, 1021 - Terry, James Herbert - 1958 LL 1117, 1118 - Terry, Mrs. Ruby B. - 1954 LL 965 - Turner, Billy - 1951 LL 1083 - Turner, Buddy J. - 1976 LL 503 - Turner, Mrs. Flora - 1973 LL 1006 - Turner, John M. & Jennie S. - 1955 LL 62, 61, 60, 13 - Wacaster, J. C. - 1954 LL 1077, 1078, 1084, 1083 - Weaver, Bradley, C. - 1956 LL 934 - Weaver, Henry Autry - 1969 LL 935, 938 - Weaver, Henry Autry - 1973 LL 903 - West, R. E. - 1955 LL 986 - Williams, M. G. - 1957 LL 149, 211 - Wilson, J. H. - 1965 LL 64, 81 - Worley, Jess - 1960 LL 1062 - Vaughn, Eugene F. - 1961 LL 1172, 1173 - Vaught, Clint H. - 1961 LL 1061 - Vaughn, S. C. - 1957 LL 825, 760, 759, 826 - Proposed Lake Board Tree Creek - 1962 Lake Arrowhead? LL 840 - Yanskey, J. J. & F. B. - 1972			Fourth Floor Storage
A 2000.1.326 Map	Cherokee County District 4, Section 2 (A - Z) LL 271 - Bearden, L. G. - 1962 LL 235 - Bethesda Baptist Church - 1971 LL 227, 229, 230 - Blackwell, Mrs. Clifora - 1958 LL 259 - Brown, W. M. - 1964 Church - Gospel Temple - Cemetery layout - 1954 LL 259 - Densmore, Mrs. J. A. - 1962 LL 258, 259 - Densmore, Mrs. J. A. - 1961 LL 338 - Farmer, George F. Estate - 1969 LL 265 - Green, A. L. B. - 1954 LL 339 - Holbert, Danny B. - 1974 LL 260 - Holcomb & Holbert - 1954 LL 234, 235 - Lawson, Betty Ingram - 2 plats - 1964, 1965 LL 299, 300 - Lyon, Mrs. Nellie - 1955 LL 309 - Patterson - 1955 LL 272 - Sosebee, Phillip & Mattie - no date			Fourth Floor Storage

Catalog / Objectid / Objname	Description	Condition	Status	Home Location	
A 2000.1.327 Map	Cherokee County District 14, Section 2 (A - B) LL 160 - Abernathy, Mrs. Louise - 1950 LL 233, 236 - Adams, Amos - 1964 LL 69, 76 - Altman, H. Lamar - 1973 LL 161 - Alexander, Wm. R. - Longview Subdivision - 1956 LL 163 - Anderson, T. - 1965 LL 233 - Barber, Robert - 1968 LL 270 - Ballard, Billy - 1948 LL 176 - Barnes - Fendley - Page - Wetherby - 1966 LL 302 - Barrett, Raymond & Lula - 1967 LL 267 - Beard, J. R. - 1959 LL 126 - Bell, Bobby - 1976 LL 280, 281, 297 - Bennett, G. G. - no date LL 280, 281 - Bennett, Henry J. - 1970 LL 170 - Bird, Joe & Robert - 1972 LL 281 - Bishop, Harold E. - 1959 LL 126 - Blackstone, Edwin - 1951 LL 77 - Blalock, D. R. - 1951 LL 130 - Booth, Harold & Mary - 1969 LL 33 - Boston, William Kleven Sr. - Waleska - 1955 LL 239 - Boyd, Elmer - 1968 LL 177 - Brackett, James R. - 1957 LL 295 - Brookshire, Jack - 1966 LL 128 - Brown, W. R. - 1962 LL 168 - Brown, T. S. III & Ray H. Jr. - 1966 LL 90 - Burrell, Leslie - 1950 LL 190 - Burris, Crawford F. - 1968 LL 218 - Byess, Daniel G. & Shirley - 1975 LL 2, 3, 34, 35 etc. - Waleska - J. L. Jones 1970 & S. D. Gray Estate				Fourth Floor Storage
A 2000.1.328 Map	Cherokee County District 14, Section 2 (C) LL 239 - Cagle, A. - 1959 LL 127, 162 - Cagle, William P. - 1952 LL 283 - Cain, A. L. - 1956 LL 107 - Cain, Donald F. - 1958 LL 282, 295 - Mt. Calvery Baptist Church - 1967 LL 114 - Callahan, Douglas D. - 1959 LL 157, 168 - Cannon, W. E. - 1949 LL 161 - Canton Motor Sales - 1973 LL 239, 240 - Cantrell, Clarence - 1955 LL 168, Cantrell, Jack L. - 1958 LL 227, 242 - Carnes Property - 1971			Fourth Floor Storage	

Catalog / Objectid / Objname	Description	Condition	Status	Home Location
	LL 242 - Carnes, Jerry D. - 1963			
	LL 227, 242 - Carnes, Louie - 1964			
	LL 129 - Chambers, Chester - 1949			
	LL 258 - Chambers, Jackson, Turner, etc. - 1966			
	LL 236 - Chesser, Mrs. L. C. - 1964			
	LL 174 - Chester, Kenneth Hogan - 1964			
	LL 149 - Childers, Billy - 1967			
	LL 178 - Chadwich, Grady - 1968			
	LL 211 - Chambers, Dwight L - 1976			
	LL 162 - Citizens Bank of Ballground - 1975			
	LL 179, 182 - Clayton Mission Baptist Church - 1964			
	LL 180, 181 - Cline, Felix C. - 1960			
	LL 40 - Cline, J. W. - 1958			
	LL 145, 180 - Cloer, Hubert G. - 1958			
	LL 163, 164 - Cloud, Mrs. Emma Ruth - 1951			
	LL 275 - Cole, W. A. - 1961			
	LL 165 - Covington, A. J. - 1973			
	LL 262 - Cox & Howard - 1966			
	LL 168 - Cummings, John - 1950			
	LL 161 - Curtis, J. B. - 1951			
A 2000.1.329 Map	Cherokee County District 14, Section 2 (D - G) LL 232, 233, 267 - Davenport, Donald L. - 1959, 1960 (2 plats) LL 218 - Davis, Bobby F. & Wanda - 1975 LL 160 - Dobson, Gus E. - 1951 LL 284 - Dobson, Jerry G. - 1963 LL 136 - Dickerson, Pritchard, McPherson - 1949 LL 158 - Douglas, Dr. T. J. - 1955, 1956 (2 plats) LL 126 - Dunn, Leonard - 1973 LL 40 - Durham, Macon H. - 1953 LL 168 - Edge, Miss Lois - 1958 LL 120 - Edmonson, Clifton - 1969 LL 308, 309 - Epperson, Maxwell - 1961 LL 309 - Epperson, Maxwell B. Jr. - 1960 LL 161 - Evans, Mrs Ora & Miss Doris Smith - 1958 LL 302 - Fields, Edgar - 1950 LL 176 - Findley, Mr. & mrs H. - 1965 LL 160 - Fowler, Ray W . 1965 LL 128 - Fowler, Willis - 1948 & 1972 LL 267 - Frady, Wayne - 1972 LL 170 - Freeman, Ralph R. Jr. - 1960 LL 162 - Georgia Power Company City of canton - 1957 LL 302 - Garrison, Joe A. - 1958 LL 127, 162 - Garrison, Joe A. - 1973			Fourth Floor Storage

Catalog / Objectid / Objname	Description	Condition	Status	Home Location
	LL 248 - Gay, C. M. - 1972 LL 247 - Ghorley, Dock - 1958 LL 275 - Gramling, Frank & Bonnie - 1962 LL 64 - Green, John P. - 1968 (2 plats) LL 235 - Green, Eugene T. - 1969 LL 161 - Grist, Dr. F. Max - 1954 LL 201 - Grist, F. Max - 1958			
A 2000.1.330 Map	Cherokee County District 14, Section 2 (H - K) LL 161 - Haley, James M. - 1960 LL 158 - Harbin, E. B. - 1956 LL 310 - Harbin, W. W. "Pete" - 1951 LL 1238 - Hawkins, B. H. - 1955 LL 128 - Hawkins, B. H. - 1955 LL 161 - Haynes, Cecil H. - 1951 LL 239 - Heard, Hoyt - 1958 LL 261, 262 - Henson, Estell & Ruby - 1966 LL 312, 313 - Hester, Rupert - 1958 LL 197 - Hillhouse, H. R. - 1957 LL 161 - Hillhouse, Hubert R - 1954 LL 127, 162 - Holcombe, C. B. - 1950 LL 262 - Hughes, Ulyss A. & Anna Ruth - 1967 LL 70 - Hulsey, Mrs. Bennie Mae LL 171 - Hunter, Mrs. Viola - 1954 LL 77 - Hufstetler, Harold E. & Margie L. - 1963 LL 258 - Jackson, Spencer - 1962 LL 160 - Jensen, Wiggo H. - 1955 LL 227 - Jones, G. P. - 1955 LL 135, 154 - Jones Merchantile - 1955 LL 157 - Jones Merchantile - 1954 LL 229, 240 - Jones, Mrs. Jack W. - 1961 LL 302, 312 - Jordan, Rita Camille - 1965, 1967 (2 plats) LL 111, 112 - Jordan, William T. - 1964 LL 235 - Kabor, James - 1973 LL 246, 259 - Kelley, William A. - 1958 LL 196 - Kelley, W. A. - 1965 LL 204, 205, 228, 229 - Kiwanis Club of Canton - 1959 LL 204, 205, 228, 229 - Kiwanis Club of Canton - 1953 LL 77 - King, Douglas & Dor - 1974			Fourth Floor Storage

Catalog / Objectid / Objname	Description	Condition	Status	Home Location
A 2000.1.331 Map	Cherokee County District 14, Section 2 (L - M) LL 170 - Langston, Noble (Subdivision) - 1960 LL 170 - Langston, Noble - 1957 LL 128 - Lathem, Willis - 1951 LL 127 - Lawson, Ralph - 1955 LL 128 - Lipscome, Rebecca - 1972 LL 292 & 321 - Long, W. W. - 1952 LL 164 & 197 - Lowery, William Jr. - 1959 LL 164 - Lowery, John Ralph - 1955 LL 201 - Lyon, J. C. - 1951 LL 91 - Millwood, Jerry - 1974 LL 312 - Manous, W. L. - 1964 & 1968 LL 239 - Manous, Louis - 1955 LL 228, 229, 240, 241 - Manous, W. L. to LA Burch - 1961 LL 128 - McCurley, LLoyd P. - 1950 LL 163 - McHellen Baptist Church - 1968 LL 200 - McKinney, Norman - 1958 LL 243 - McFarland, Lewis - 1966 LL 160, 161, 164, 165 - McLain, J. A. - 1973 (Billing original 1925) LL 170 - McMickens & Johnson - 1959 LL 149 - McWhirter, David James - 1973 LL 302 - McVey, R. C. - 1960 LL 160 & 161 - Messer, W. H. - 1950 LL 244 - Mills, J. Edd - 1964 LL 126 - Mode, Luke - 1962 LL 243 - Moore, Frank L. LL 126 - Moore, Gene J. - 1973 LL 161 - Moore, J. D. - 1960 LL 161 - Moore, J. D. - 1963 LL 161 - Moore, J. D. - 1973 LL 127 & 162 - Moore, T. K. - 1971 LL 54 - Moore, George - Saxon Heights - 1972 LL 226 - Mulinax, J. M. & Inez - 1966			Fourth Floor Storage
A 2000.1.332 Map	Cherokee County District 14, Section 2 (N-P) LL 262 - Nations, George - 1967 LL 261 - Nations, Mr. & Mrs. J. A. - 1969 LL 261 - Nations, Mr. & mrs. J. A. - 1949 LL 261 - Nations, mrs. james A. - 1959 LL 64 - Nelson, Roy M. - 1962 LL 233 - Newhope Baptist Church cememter - 1946			Fourth Floor Storage

Catalog / Objectid / Objname	Description	Condition	Status	Home Location
	LL 77 - Owen, Lucille D. - 1968			
	LL 161 - Owen, J. B. - 1959			
	LL 267 - Owen, Ralph - 1951			
	LL 312 & 313 - Padgett, Roy L. - 1959			
	LL 8, 9, 28, 29 - Padgett, Roy L. - 1958			
	LL 130 - Page, Harold - 1974			
	LL 165 - Payne, Simon - 1952			
	LL 164 - Payne, Simon - 1955			
	LL 169 - Payne, Mrs. L. R. - 1964			
	LL 244 - Pendley, Herschel - 1960			
	LL 129 & 130 - Pettit, Phillip E. - 1965			
	LL 205 & 222 - Pettit, Jack - 1971			
	LL 163 - Pharr, Homer L. - 1952			
	LL 227 - Pitts, Jack - 1963			
	LL 130 - Pitts, Jack - 1971 (Oakdale Road)			
	LL 89 & 90 - Pool, Silas - 1958			
	LL 40 - Ponder, Mrs. J. D. - 1966			
	LL 136 & 137 - Pope, Wilton - 1951			
	LL 137 - Pope, Wilton - 1975			
	LL 137 - Pope, Wilton - 1974			
	LL 168 - Price, Eugene T. - 1951			
	LL 164 & 165 - Pruitt, Amos C. - 1960			
	LL 163 - Pruitt, Cecil - 1971 (Lot 2-Sunset Heights)			
	LL 160 - Pruitt, J. E. - 1952			
A 2000.1.333 Map	Cherokee County District 14, Section 2 (Q-V) LL 127 - Raye, Carl - 1958 LL 235 - Raper, C. H. - 1964 LL 281 - Richey, Paul J. - 1952 LL 239 - Rolan, A. C. - 1952 LL 226 - Roland, C.E. - 1975, 1959 LL 127 - Roper Tire Company - 1957 LL 91 - Rossignol, William - 1972 LL 161 - Sanford Lake Coop. - 1965 LL 296 - Shoemaker, James W. - 1973 LL 91 - Sims, Johnnie (Property) - 1950 LL 91 - Sims, Johnnie Subdivision - 1954 (Butterworth & 20) LL 217 - Smith, James O. - 1958 LL 247 - Smith, Ronald - 1971 LL 128 & 161 - Smith, Willie L. - 1960 LL 202 - Smith, Johnnie - 1964 LL 309 - Smith, Willia Y. - 1963 LL 164 - Smith, Willie L. - 1966 LL 301 - Smith, Earl E. - 1961			Fourth Floor Storage

Catalog / Objectid / Objname	Description	Condition	Status	Home Location
	LL 289 & 324 - Spence, Arnold - 1960			
	LL 168 - Stansberry, Mrs. Ozella Smith - 1959			
	LL 128 - Stephens, James A. - 1963			
	LL 261 - Sullivan, Ruby S. - 1950			
	LL 170 - Tanner, K. L. - 1972			
	LL 228 - Teague Subdivision - 1953 Clydesdale Subdivision			
	LL 197 - Teems, Mrs. Eula - 1961			
	LL 228 - Theaters Martin & Thompson - 1950			
	LL 170 - Thomas, Charlie - 1960			
	LL 91 - Thompson, Phillip - 1974			
	LL 256 - Thompson, Wm. A - 1968			
	LL 274 - Turner, Douglas E. - 1971			
	LL 128 - Vaughn, James E. - 1958			
	LL 302 - Vaughn, John A. - 1952			
A 2000.1.334	Cherokee County			Fourth Floor Storage
Map	District 14, Section 2 (W-Z)			
	LL 132 - Wade, Martin - 1968			
	LL 243 - Wallace, Paul - 1951			
	LL 235 - Walker, Luke - 1950			
	LL 161 & 162 - Watkins, McClellan S. - 1954			
	LL 161 & 162 - Watkins, J. W. Estate - 1954			
	LL 67 - Watts, Dillard, K. - 1951			
	LL 164 & 165 - Weatherby, Alex & Porter, T. J. - 1952			
	LL 244 - West, Larry O'Neal - 1963			
	LL 201 - West, Wm. L. - 1972			
	LL 111 - Westbrook. T. L. - 1961			
	LL 253, 254 & 288 - Whatley, L. D. - 1954			
	LL 154 - Wheeler, James - 1951			
	LL 168 - Whiddon, L. R. - 1968			
	LL 162 - Whitmire, W. A. Jr. - 1958			
	LL 162 - Whitmire, W. A. Jr. - 1959			
	LL 91 - Whitfield, Mrs. Elaine Page - 1957			
	LL 261 - Wilkie, Mrs. Herman - 1973			
	LL 239 - Wilson, James - 1964			
	LL 284 - Worley, Charles W. - 1965			
	LL 205 & 229 - Yancey, James W. - 1954			
	LL 201 - Yarbrough, Howard - 1954 & 1956 (2 plats)			

Catalog / Objectid / Objname	Description	Condition	Status	Home Location	
A 2000.1.335 Map	Cherokee County District 15 Section 2 (A-B) LL 40, 41, 104, 105 - Adams, W. A. - 1950 LL 334, 387 - Adams, Lloyd H. - 1960 LL 28 - Adams, Homer A. - 1958 LL 113 - Adams Estate (Ralph Marshall land) - 1964 (2 plats) LL 536 - Allen, Mrs. Tamer - 1964 & 1965 (2 plats) LL 547, 606 - Allen, Tamer property - 1964 LL 39, 106 - Allen, John O. - 1958 LL 107 - Allen, John O. - 1964 LL 1025 - American Legion Post # 256 - 1953 LL 730 - Amos, Samuel E & Margaret - 1954 (2 plats) LL 357 - Anderson, Buford - 1969 LL 904, 969, 977, 1040 - Anderson, W. B. - 1958 LL 272 - Bailey, Dock - 1970 LL 603, 622 - Barnett, Robert E - 1964 LL 520, 561 - Bell, Bradford - 1964 LL 955 - Bentley, Ernest, Larry - 1970 LL 250 - Bishop, H L - 1951 LL 15 - Blackstock, Edwin - 1958 LL 1284 - Blalock, J L - 1959 LL 1277 - Blalock, Melvin D - 1958 LL 378 - Blanton, James R - 1956 LL 1187, 1190 - R & M Bonding Co., Mareitta - 1956 LL 378 - Boggs, Billy H Mrs. Billy H - 1960 LL 203 - Bohannon, Jim M - 1968 LL 15, 16 - Bradshaw, Richard B - 1958 LL 16 - Bradshaw, W T - 1954 LL 936 - Brooks, C Clifton & Claire - 1953 LL 88, 129 - Brown, J F- 1949 LL 414 - Bryan, B B - 1975 LL 127 - Burgess, W T - 1973 LL 90 - Burton, Mrs. Robert - 1964				Fourth Floor Storage
A 2000.1.336 Map	Cherokee County District 15 Section 2 (C-D) LL 101, 102 - Cagle, William - 1958 LL 465 - Campbell, B J - 1969 LL 58 - Caldwell, W L - 1965 LL 1236, 1237, 1284, 1285 - Call, Oran C - 1959 LL 301, 302 - Canton By-Products Company - 1957 LL 13, 14 - Cantrell, Michael D (Harbin Subdivision) - 1967 LL 293, 294, 355, 356 - cantrell, J T - 1961 LL 296, 353 - Cantrell, Ch. W - 1968 LL 294, 355 - Cantrell, Roy Wiley - 1963			Fourth Floor Storage	

Catalog / Objectid / Objname	Description	Condition	Status	Home Location
	LL 355 - Cantrell, Mrs. Roy E - 1969			
	LL 673, 674, 695, 696 - Carlan, Luther E. - 1963			
	LL 1231 - Cason, Hoke S & Hilda L - 1959			
	LL 374, 387, 388 - Chaambers Property - 1974			
	LL 195 - Champion, Elbert - 1963			
	LL 280 - Chesser, William - 1973			
	LL 249 - Church of God of Prophecy - 1963			
	LL 377 - Clark, Benny & Brenda - 1972			
	LL 86, 87 - Clark, Edward wayne - 1974			
	LL 344 - Cleghorn, Billy J - 1959			
	LL 467 - Cook, James E - 1966			
	LL 466, 467, 470 - Cook, J L (farm) - 1952			
	LL 899 - Cook, Milton D - 1971			
	LL 899, 900, 902 - Cook, Albert Dan - 1960			
	LL 19, 53, 54 - Cox, Carlisle, B - 1950 & 1969 (2 plats)			
	LL 101 - Cox, James E - 1969			
	LL 384, 385 - Cocke, L L & Mulkey, O C - 1949			
	LL 536 - Conner, Charles - 1965			
	LL 517 - Covington, George P & M A - 1965			
	LL 516 - Covington, Myrtle Ann - 1967			
	LL 114 - Crowe, A I - 1963			
	LL 417 - D & D Manufacturing Company - 1967			
	LL 264, 265, 312, 313 - Davis, Ralph A - 1960			
	LL 266 - Davis, Ralph - 1974			
	LL 387 - Davenport, Mr & mrs H D - 1972			
	LL 182 - DeLong, C A & Euna H - 1959			
	LL 271 - Denny, Mrs Hunt - 1966			
	LL 483 - Dickerson, D W - 1958			
	LL 1254, 1267 - Dobbs, H L - 1959			
	LL 101 - Dover, Donald & lavelle - 1973			
	LL 633 - Dover, Joe & Edna - 1976			
	LL 344 - Dunn, Ronald - 1959			
	LL 377 - Dunn, Jimmy E & Patricia H - 1964			

A 2000.1.337
Map

Cherokee County
District 15 Section 2 (E-G)
LL 16 - Edwards, James A - 1950
LL 632 - Edmondson, Ethel - 1964
LL 1115, 1117, 1118, 1187 - Eldridge, Ben F - 1952
LL 200 - Eadie, Mrs Frank - 1974
LL 448 - Elliot, James F - 1973
LL 1061 - Ellis, E C - 1958

Fourth Floor Storage

Catalog / Objectid / Objname	Description	Condition	Status	Home Location
	LL 198 - Eades - Jessie - no date LL 634 - Emory, T A - 1959 LL 886 - Eubanks, Paul - 1966 LL 1019, 1020 - Fann, L F - 1957 LL 388 - Fountain, M Omeday - 1971 LL 224 - Fowler, Don Q - 1957 LL 282, 296 - Fowler, Don Q - 1961 LL 162 - Fowler, Jimmy (Whispering Pines) - 1972 LL 1214, 1215 - Fowler, Howard E, 1959 LL 1214 - Fowler, Thomas O - 1957 LL 473, 536 - Forrester, Martha - 1964 LL 250, 255 - Forrester, Pierce - 1951 LL 109, 110 - Forrestrer, Camalee & John L - 1968 LL 255 - Forrester, Pierce - 1958 LL 19, 20, 21 - Foster, C R (A L B Powell) - 1959 LL 25 - Frady, C O'Neal & Martin, E H - 1971 LL 1171 - Garland, R M - 1963 LL 38 - Golik, J J - 1965 LL 339 - Goodwin, Larry Thomas - 1975 LL 12 - Grace Baptist Church - 1972 LL 38 - Graham, Ronald W - 1958 LL 159, 129 - Gray, Arthur - 1949 LL 161 - Gray, Mrs. Arthur - 1966 LL 272, 273 - Gray, Arthur S Estate - 1958 LL 682 - Gravely, P G - 1965 LL 272 - Green, Thomas R. (2 plats) - 1960 & 1964 LL 1171 - Greml, Charles - 1971 LL 415 - Grier, Bobby L - 1968			
A 2000.1.338 Map	Cherokee High School District 14 Section 2 LL 130, 159 10 topographic surveys 1 warranty deed			Fourth Floor Storage
A 2000.1.339 Map	Rock Creek Estates George Ray Hembree District 14 Section 2 LL 133 LL120 John Thrower Guy Jones George Hembree John Adams			Fourth Floor Storage

Catalog / Objectid / Objname	Description	Condition	Status	Home Location
	Jones Mercantile Edward Wallis Merita Ann Cotner			
A 2000.1.340 Map	Edwards Heights District 15 Section 2 LL 16 Protective Covenants Richard Sims Cherokee County High School proposed site, 1952			Fourth Floor Storage
A 2000.1.341 Map	Forest Hills District 14, Section 2 Forest Hills Subdivision C. K. Cobb Randall Charles Bagwell LL 195, 202 Billy Beard LL 195, 196, 201 Carl C. Edge, Jr. LL 196 Dorothy & Roy Dawn LL 195 Jack Hamby Perry & Barbara Jones Thomas Jones, LL 195 Clay Owen LL202 J. R. Raines Jack Whitmire			Fourth Floor Storage
A 2000.1.343 Map	Ball Ground School			Fourth Floor Storage
A 2000.1.344 Map	Ball Ground Misc . Pics . , Etc. includes new post office site copy of 1882 layout by F. S. Wallace site of Roberts Lake John B. Ward property LL 10 - Ford Sales and Service LL 10 Kenneth Gentry 1969 Pure Oil Company R. C. Purcell to Thomas and Lullie Smith Holcomb Hubbard property			Fourth Floor Storage

Catalog / Objectid / Objname	Description	Condition	Status	Home Location
A 2000.1.345 Map	Harbin Subdivision Harbin Subdivision Dist. 15 Sec. 2 Mrs. Johnny Harbin LL 13 Dean Roper LL 13, LL14 Elisha Wyatt LL13 Joseph Carlton Booth LL 13 1964 James Winston Samples 1965 Ll 13 James and Lucille Thomas LL 13 1968			
A 2000.1.346 Map	Ralph Owen 14 District Second Section Land Lot 267 Two Drawings			Fourth Floor Storage
A 2000.1.347 Map	G. R. Hembree Rock Creek Estates District 14 Section 2 LL 120, 133 Mrs. Betty Hembree Edge, 1965 District 15 Section 2 LL 199 Joe Manous, 1964 James and Janeal Orr, 1965 Earl Dean and Mary Frances Cordell, 1964 Hensley Edge, 1964 George Ray Hembree, 1967 Lewis and Virginia Roberts, 1964			Fourth Floor Storage
A 2000.1.348 Map	Jones Mercantile Co., Misc. Rock Creek Estates Cherokee Heights Old Cantex Building Main Street LL 157, 158, 167, 168 James Wheeler Property 14 District 2nd Section LL 154 Warranty deed District 14 Section 2 LL 154			Fourth Floor Storage

Catalog / Objectid / Objname	Description	Condition	Status	Home Location
A 2000.1.349 Map	City Of Canton A - E Folder - City of Canton (A - E) All District 14, Section 2 LL 160, 165 - Bagwell, Leland H. - 1959 LL 194 - Baker, Howard E. - 1957 LL 195, 196, 201 - Beard, Billy - 1971 (Longview Road) LL 160 - Blalock, J. L. - 1974 LL 195 - Burtz, Sam P. - 1950 LL 194 - Butterworth, Roy Jr. - 1954 LL 202 - Cain, Donald F. - 1960 LL 167 - Callahan, Douglas D. - 1968 LL 168 - Canton Medical Center - 1966 LL 166 - Canton Telephone Company - 1956 LL 165 - Canton Veterinary Clinic - 1972 LL 168 - Cannon, James A. - 1966 LL 165 - Cantrell, Paul Q. - 1967 LL 165 - Chamlee, Jerry M. (land) - 1957 LL 195 - Champion, Johnny W. - 1975 LL 195 - Cole, W. A. 1967 LL 195 - Cole, William Alton - 1950 LL 195 - Cole, Wm. A. - 1952 LL 195 - Cole, Mrs. W. A. - 1949 LL 165 - Collett, Harrison & Mary Glenn - 1957 LL 194 - Cowart, Mrs. Opal - 1964 LL 195 - Cullens, Steve (contour map) - 1953 LL 202 - Dale, Thomas D. - 1966 LL 165 - Dickerson, David William - 1951 LL 195 - Durham, Clifford L. - 1957 LL 195 - Edge, Carl C. - 1968 LL 165 - Evans, Lee Jr. - 1973 LL ??? - Everton, Mrs T. Z. B. - 1951			Fourth Floor Storage
A 2000.1.350 Map	Keeter Subd .			Fourth Floor Storage

Catalog / Objectid / Objname	Description	Condition	Status	Home Location
A 2000.1.351 Map	Mrs . Louise M. Roelofs Mrs . Sam A. Roelofs Mrs . Louise M. Roelofs			Fourth Floor Storage
A 2000.1.352 Map	Canton Textile Mills (North Canton Area)			Fourth Floor Storage
A 2000.1.353 Map	Canton textile Mills Canton Cotton Mills			Fourth Floor Storage
A 2000.1.354 Map	J. P. Haynes			Fourth Floor Storage
A 2000.1.355 Map	Buffington			Fourth Floor Storage

Catalog / Objectid / Objname	Description	Condition	Status	Home Location
A 2000.1.356 Map	McCanless , etc.			Fourth Floor Storage
A 2000.1.357 Map	Mrs . J. W. Chamlee			Fourth Floor Storage
A 2000.1.358 Map	County Training School Colored			Fourth Floor Storage
A 2000.1.359 Map	North Canton - Elementary			Fourth Floor Storage
A 2000.1.360 Map	Woodstock School			Fourth Floor Storage

Catalog / Objectid / Objname	Description	Condition	Status	Home Location
A 2000.1.361 Map	Jones mercantile Company Shoal Creek Road Subd .			Fourth Floor Storage
A 2000.1.362 Map	J. P. Haynes Subd. J. P. Haynes Subd .			Fourth Floor Storage
A 2000.1.363 Map	C. W. Ellison			Fourth Floor Storage
A 2000.1.364 Map	Blueberry Hills			Fourth Floor Storage
A 2000.1.365 Map	Eugene B. Chambers (Rolling Hills Hgts)			Fourth Floor Storage

Catalog / Objectid / Objname	Description	Condition	Status	Home Location
A 2000.1.366 Map	Jerry T. Greshem			Fourth Floor Storage
A 2000.1.367 Map	C. O. Chapman Estste Holly Springs			Fourth Floor Storage
A 2000.1.368 Map	Canton Cotton Mills			Fourth Floor Storage
A 2000.1.369 Map	Cannon , James A.			Fourth Floor Storage
A 2000.1.370 Map	Billingsles			Fourth Floor Storage

Catalog / Objectid / Objname	Description	Condition	Status	Home Location
A 2000.1.371 Map	W. L. Blackwell, Misc.			Fourth Floor Storage
A 2000.1.372 Map	" Beauty Heights " Mrs . S. C. Neath (was Mrs . Clyde Teague)			Fourth Floor Storage
A 2000.1.373 Map	W. E. Cummins Subd .			Fourth Floor Storage
A 2000.1.374 Map	Cagle , Henry			Fourth Floor Storage
A 2000.1.375 Map	Smith L. Johnston , Estate			Fourth Floor Storage

Catalog / Objectid / Objname	Description	Condition	Status	Home Location
A 2000.1.376 Map	E. E. Turner Subdivision			Fourth Floor Storage
A 2000.1.377 Map	Saxon Heights			Fourth Floor Storage
A 2000.1.378 Map	Rolling Hills Heights Subd . Rolling Hills Heights Subd.			Fourth Floor Storage
A 2000.1.379 Map	Page			Fourth Floor Storage
A 2000.1.380 Map	Galt			Fourth Floor Storage

Catalog / Objectid / Objname	Description	Condition	Status	Home Location
A 2000.1.381 Map	Arthur E. (Buddy) Fields			Fourth Floor Storage
A 2000.1.382 Map	Cherokee Hgts - Misc.			Fourth Floor Storage
A 2000.1.383 Map	Dr . G. N. Coker - Subd.			Fourth Floor Storage
A 2000.1.384 Map	Hembredge Hills Subd (Geo. Ray Hembree)			Fourth Floor Storage
A 2000.1.385 Map	Macedonia			Fourth Floor Storage

Catalog / Objectid / Objname	Description	Condition	Status	Home Location
A 2000.1.386 Map	Hickory Flat			Fourth Floor Storage
A 2000.1.387 Map	Clayton			Fourth Floor Storage
A 2000.1.388 Map	Oak Grove			Fourth Floor Storage
A 2000.1.389 Map	Holly Springs Subd .			Fourth Floor Storage
A 2000.1.390 Map	Pine Crest Subd .			Fourth Floor Storage

Catalog / Objectid / Objname	Description	Condition	Status	Home Location
A 2000.1.391 Map	Holly Springs			Fourth Floor Storage
A 2000.1.392 Map	Childers Subd. (Mrs . H. T.)			Fourth Floor Storage
A 2000.1.393 Map	Woodstock Prop . Woodstock , GA			Fourth Floor Storage
A 2000.1.394 Map	Smith L. Johnston , Jr.			Fourth Floor Storage
A 2000.1.395 Map	James H. Poore & Smith L. Johnston , Jr. Woodstock			Fourth Floor Storage

Catalog / Objectid / Objname	Description	Condition	Status	Home Location
A 2000.1.396 Map	Reinhardt College			Fourth Floor Storage
A 2000.1.397 Map	Waleska			Fourth Floor Storage
A 2000.1.398 Map	Waleska Prop . Waleska , GA			Fourth Floor Storage
A 2000.1.399 Map	Herbert Lee Bennett			Fourth Floor Storage
A 2000.1.400 Map	T . B . Bradshaw			Fourth Floor Storage

Catalog / Objectid / Objname	Description	Condition	Status	Home Location
A 2000.1.401 Map	Fields Estste			Fourth Floor Storage
A 2000.1.402 Map	Dist 15 - Tracings, Misc. Section 2 From aerial photo 1938 Wm. Nolte Toonigh Nora Voyles Land Cherokee County Board Education LL 1154 Ronnie New LL 388 LL 130, 131 Patton LL 908 Howell Stenger - Dawson Parr Department Store LL 1027, 1028, 990			Fourth Floor Storage
A 2000.1.403 Map	District 14 - Tracings, etc. Dist 14 Section 2			Fourth Floor Storage
A 2000.1.404 Map	District 15 - Misc. Pt's Ragsdale Cook Pruitt Kelley Bradshaw Lake Redd Holloway Burton Hause Blackstock			Fourth Floor Storage

Catalog / Objectid / Objname	Description	Condition	Status	Home Location
A 2000.1.405 Map	District 15 - Tracings			Fourth Floor Storage
A 2000.1.406 Map	Acworth - Misc. Including Allatoona Dam			Fourth Floor Storage
A 2000.1.407 Map	Acworth, City of			Fourth Floor Storage
A 2000.1.408 Map	Forsyth County			Fourth Floor Storage
A 2000.1.409 Map	Fulton County			Fourth Floor Storage

Catalog / Objectid / Objname	Description	Condition	Status	Home Location
A 2000.1.410 Map	Pickens County			Fourth Floor Storage
A 2000.1.411 Map	City of Canton LL 132			Fourth Floor Storage
A 2000.1.412 Map	Canton North of River			Fourth Floor Storage
A 2000.1.413 Map	Canton Between River and Town Creek			Fourth Floor Storage
A 2000.1.414 Map	1895 Cherokee County			Fourth Floor Storage

Catalog / Objectid / Objname	Description	Condition	Status	Home Location
A 2000.1.415 Map	Fulton County 1951			Fourth Floor Storage
A 2000.1.416 Map	1946 Road Map Pickens, Dawson, Cherokee, Forsyth Agricultural and Industrial Development Board			Fourth Floor Storage
A 2000.1.417 Map	1965 State Road 5 Cobb and Cherokee County Public Hearing F 057-I			Fourth Floor Storage
A 2000.1.418 Map	1959 Highway Map Forsyth County			Fourth Floor Storage
A 2000.1.419 Map	1966 Highway Map Stephens County			Fourth Floor Storage

Catalog / Objectid / Objname	Description	Condition	Status	Home Location
A 2000.1.420 Map	1957 Highway Map Stephens County			Fourth Floor Storage
A 2000.1.421 Map	Section 15 H - K			Fourth Floor Storage
A 2000.1.422 Map	Section 15 P - R			Fourth Floor Storage
A 2000.1.423 Map	Section 15 L-O			Fourth Floor Storage
A 2000.1.424 Map	Section 15 S-Z			Fourth Floor Storage

Catalog / Objectid / Objname	Description	Condition	Status	Home Location
A 2000.1.425 Map	Section 21 A-K			Fourth Floor Storage
A 2000.1.426 Map	Section 21 L-Z			Fourth Floor Storage
A 2000.1.427 Map	Section 22 A-Z			Fourth Floor Storage
A 2000.1.428 Map	1954 Highway Map Cherokee County			Fourth Floor Storage
A 2000.1.429 Map	1951 Highway Map Banks County			Fourth Floor Storage

Catalog / Objectid / Objname	Description	Condition	Status	Home Location
A 2000.1.430 Map	1954 Cobb County			Fourth Floor Storage
A 2000.1.431 Map	1958 Cobb County			Fourth Floor Storage
A 2000.1.432 Map	1956 Highway Map Hall County			Fourth Floor Storage
A 2000.1.433 Map	Miscellaneous Harmon Circle Highway 5 White and Bradley Highway 20 Ponders Store Lakeside Inn Truck Stop Martin			Fourth Floor Storage
A 2000.1.434 Map	Bradford Bell Canton Georgia Bell View Heights Dunn Transit Ave LL 228, 129, 205, 130			Fourth Floor Storage

Catalog / Objectid / Objname	Description	Condition	Status	Home Location
A 2000.1.435 Map	National Guard Unit			Fourth Floor Storage
A 2000.1.436 Map	Ball Ground (inlcuding from 1882 map) WL Blackwell Rolling Hills Heights			Fourth Floor Storage
A 2000.1.437 Map	Chlora Holtzclaw LL 1150, 1154, 1155, 1156, 1223			Fourth Floor Storage
A 2000.1.438 Map	Boy Scouts Camp Dobbs LL 208, 224			Fourth Floor Storage
A 2000.1.439 Map	Teague, Chas R. Beauty Heights LL 227, 242 North Canton Subdivision			Fourth Floor Storage

Catalog / Objectid / Objname	Description	Condition	Status	Home Location
A 2000.1.440 Map	District 3			Fourth Floor Storage
A 2000.1.441 Map	District 14			Fourth Floor Storage
A 2000.1.442 Map	District 14 Tracings			Fourth Floor Storage
A 2000.1.443 Map	District 3 Contains 65 plats and folder			Fourth Floor Storage
A 2000.1.444 Map	District 2 Contains 59 plats and folder			Fourth Floor Storage

Catalog / Objectid / Objname	Description	Condition	Status	Home Location
A 2000.1.445 Map	Bartow County			Fourth Floor Storage
A 2000.1.446 Map	District 21			Fourth Floor Storage
A 2000.1.447 Map	District 4			Fourth Floor Storage
A 2000.1.448 Map	District 13			Fourth Floor Storage
A 2000.1.449 Map	District 23			Fourth Floor Storage

Catalog / Objectid / Objname	Description	Condition	Status	Home Location
A 2000.1.450 Map	District 22 - Including Coordinates of Lake Allatoona			Fourth Floor Storage
A 2000.1.451 Map	Free Home Including Free Home School			Fourth Floor Storage
A 2000.1.452 Map	Cartersville			Fourth Floor Storage
A 2000.1.453 Map	Acworth			Fourth Floor Storage
A 2000.1.454 Map	District 3 Border lines, etc.			Fourth Floor Storage

Catalog / Objectid / Objname	Description	Condition	Status	Home Location
A 2000.1.455 Map	miscellaneous Maps - Canton Motor Sales, Coppermine Subdivision			Fourth Floor Storage
A 2000.1.456 Correspondence	Ridgway's Notes and Correspondence Letterhead / invoice			Fourth Floor Storage
				
A 2000.1.457 Print, Photographic	Aerial Photographs Master Key. Book includes City of Canton 1929 with master and 11 sheets. Loose in book are two County masters dated 1948-1950			Fourth Floor Storage
A 2000.2.5 Brochure	Booklet titled "Topographic Maps Tools for Planning" published by the U. S. Department of the Interior Geological Survey.			Fourth Floor Storage
A 2000.2.7 Book	Small engineer's field book used by Latimer Ridgway in 1947. Brown cover is almost completely faded. Has technical information on the properties he surveyed in 1947 (including his own). A typical entry may have a blueprint sketch of buildings on the property and its location in relation to land lots, roads, other nearby features, and coordinates. P. 1: Lat. Ridgway property at 659 Marietta Rd.			Fourth Floor Storage

Catalog / Objectid / Objname	Description	Condition	Status	Home Location
	P. 2: Pat Blackstock property			
	P. 3: Macedonia School Lot on Orange Road			
	P. 4: Edgar Long property in Holly Springs			
	P. 7: M. J. White property on Cemetery St. and Hickory Flat Highway			
	P. 8: G. L. Bohanon property			
	P. 13: Bob Lathem property on Highway 5			
	P. 15: E. A. McCanless property on Main Street Canton			
	P. 18: Canton Cotton Mill property on Old Waleska Road			
	P. 19: Teasley property survey			
	P. 49: Canton Cotton Mills property survey			
	P. 70: Brown farm survey			
	P. 73: Emma Holcombe property on Gilmer Bridge Road			
A 2000.2.8 Book	<p>Small engineer's field book used by Latimer Ridgway in 1973. Light brown cover is marked "BK 53. 1972. 1973." Has technical information on the properties he surveyed in 1973. A typical entry may have a blueprint sketch of buildings on the property and its location in relation to land lots, roads, other nearby features, and coordinates.</p> <p>Properties surveyed in this book</p> <p>James L. Long property on Hickory Flat Road</p> <p>Wayne Frady property</p> <p>Omie Reece property</p> <p>Benny & Brenda M. Clark property on Highway 5</p> <p>Charles L. Smith property on Goodwin Road</p>			Fourth Floor Storage

Catalog / Objectid / Objname	Description	Condition	Status	Home Location
	Robert A. Neely Property			
	Ray Anderson property			
	Dr. William J. Johnston (Canton Vet Clinic) property on Highway 140			
	Rebekah Lipscomb property on Page St.			
	Douglas L. Bailey property on Quarry road			
	P. 15: J. J. Lumpkin property in Ball Ground on Highway 5			
	P. 16: Grace Baptist Church on Butterworth Road			
	P. 18: J. P. Haynes property on Magnolia Road			
	P. 19: C. O'Neal Frady property on Brick Mill Road			
	P. 20: Canon Textile Mills on Railroad Street			
	P. 26: Elbert D. Wood property on E. Killian Street			
	P. 27: Ray Rutledge property			
	P. 28: J. P. Haynes property on Ridgway Road			
	P. 29: George Ray Hembree property near Cherokee Heights			
	P. 30: Weldon Leon Padgett property			
	P. 31: Charles W. Wheeler property on Highway 20			
	P. 32: John J. Yanskey property on Old Mill Road			
	P. 33: James Phillip Eubanks property on Hasty Road			
	P. 34: Ruben Jones property (sold to N. S. Whitman) on Highway 20			
	P. 35: George Moore property on Fields Landing Road			
	P. 36: Barbara Barnes Wilkie property on Highway 5			
	P. 37: William G. Cagle property on Highway 140			

Catalog / Objectid / Objname	Description	Condition	Status	Home Location
	P. 38: J. P. Haynes property on Oakdale and Magnolia Road			
	P. 40: Parks Rusk property			
	P. 41: J. D. Moore property			
	P. 42: R. L. Carmichael property			
	P. 43: Ralph Allison property			
	P. 44: B & B Mobile Homes property on Ridge Road			
	P. 45: Mrs. Wilkie property			
	P. 47: J. B. Morris property on Butterworth Road			
	P. 48: Dan & Lavelle Dover property			
	P. 49: Freddie Underwood property on Clayton School Road			
	P. 50: Gene J. Moore property			
	P. 51: Bank of Canton property			
	P. 53: James F. Elliot property			
	P. 54: Jerry W. Fouts property on Hembree Hill Rd. and Honeysuckle Dr.			
	P. 55: G. R. Hembree property in Rock Creek Estates			
	P. 56: Guy S. Jones property on Hill Crest Dr. and Old Shoal Creek Rd.			
	P. 57: W. T. Burgess property on Univeter road			
	P. 58: James W. Shoemaker property on Gorley Road			
	P. 59: St. Paul A. M. E. Methodist Church property on Crisler St.			
	P. 60: Edwin Graham property on Clarke Road			
	P. 61: Clarence M. Gay property on Sharp Top Road			
	P. 62: George Silvers property on Childers Road			

Catalog / Objectid / Objname	Description	Condition	Status	Home Location
	<p>P. 63: George Ray Hembree on Ranch Creek Road and Hembree Hill Road</p> <p>P. 64: Old Hickory Products Co. on Arnold Mill Road</p> <p>P. 65: Vena Dobson property on Highway 5 and Hickory Flat Road</p> <p>P. 66: Kenneth Lewis Tanner property on Highway 140</p> <p>P. 67: Shady Brooks Acres Subdivision on Crestwood Dr.</p> <p>P. 68: William Rossignol property on Waconda Avenue and Duke St.</p> <p>P. 69: Jimmy L. Fowler property on Lakeside Drive</p> <p>P. 70: George Ray Hembree property on Hembree Hill Dr. and Hank Ln.</p>			
A 2000.2.16 Manual	Two detailed instructional pamphlets about the operation of the MA-7 and MA-7-W Monroe Adding Calculators. Also included is a letter from Monroe Calculating Machine Company, Inc. about requesting additional information about the operation of their adding machines. The Monroe letterhead indicates that the letter is from the early 1950s to late 1960s. Documents held in envelope addressed to Lat Ridgway.			Fourth Floor Storage
A 2000.2.17 Pamphlet, Instruction	A pamphlet guide published by the Georgia State Museum of Science and Industry to be used for basic identification of snakes indigenous to Georgia. Written by Charles Wharton.			Fourth Floor Storage

Catalog / Objectid / Objname	Description	Condition	Status	Home Location
A 2000.2.18 Manual, Training	A dense technical manual published by the U.S. Coast and Geodetic survey in 1945 covering general and advanced aspects of surveying systems. Written by Hugh C. Mitchell and Lansing G. Simmons. Special Publicaion No. 235.			Fourth Floor Storage
A 2000.2.19 Pamphlet	Small booklet detailing the Georgia Plat act of 1978 put out by Ben W. Fortson, Jr., Secretary of State and Surveyor General. Gives the full text of Georgia Act No. 1291.			Fourth Floor Storage
A 2000.2.20 Pamphlet	A farmer's yearbook put out by Jones Mercantile Company. This one is unique in that it has notes written by Lat Ridgway noting the locations of mistletoe across the county and other surrounding areas as well as the varieties that they were located on.			Fourth Floor Storage
A 2000.2.21 Manual	Booklet published by the State of Georgia outlining the basic requirements and principles of the engineering profession and information about the laws that directly relate to the profession. Bound with a red paper cover.			Fourth Floor Storage
A 2000.2.22 Book	1974 publication by the State of Georgia listing the names and addresses of registered engineers and surveyors of the State.			Fourth Floor Storage

Catalog / Objectid / Objname	Description	Condition	Status	Home Location
A 2000.2.23 Document	Four documents (one large book, two booklets, and a paper) from the U.S. Coast and Geodetic survey relating to uses of Earth's magnetism in surveying. The large book is titled magnetic declination in Georgia and was published in 1935. The two smaller booklets are titled "Practical uses of the Earth's Magnetism" and "Horizontal Control Data" (relating to using control data in the field) and were published in 1939 and 1942 respectively. The single paper is from 1946 and shows a table of change in magnetic declination.			Fourth Floor Storage
A 2000.2.24 Document	Order form from 1975 used for requesting Georgia quadrangle maps from the U.S. Geological Society. Also included is a note with a return envelope stapled to it where Lat was requesting the most recent topographic maps near Georgia			Fourth Floor Storage
A 2000.2.25 Map	A 1936 reprint of a large 1916 map owned by Lat Ridgway. Shows color coded elevations and large cities.			Fourth Floor Storage
A 2000.2.26 Map	Yearly distributed road map offered for free by the State of Georgia. This is the 1970 edition with a photo of the North Georgia mountains on the cover. Folds down to brochure size.			Fourth Floor Storage
A 2000.2.27 Map	Folding road map offered for free by the State of Georgia. This is the 1976 edition. Cover shows Georgia state seals through the years.			Fourth Floor Storage

Catalog / Objectid / Objname	Description	Condition	Status	Home Location
A 2000.2.28 Document	<p data-bbox="470 126 1108 155">A collection of quadrangle reports ordered by Lat Ridgway.</p> <ol style="list-style-type: none"> <li data-bbox="470 188 1188 561">1. Tate Quadrangle, C. A. Turner, 1926. Some of the notable triangulation points mentioned are: land owned by David Densmore, A. E. Sutton's Mailbox, high school tower, courthouse yard, Methodist church spire, J. H. Hopkin's mailbox, Tate Hotel, Nelson Baptist Church spire, Byers Store, Hill Baptist Church (possibly Ball Ground Baptist), C. L. Tippens' mailbox, Keithsburg crossroads, Chalcedonia Church, Hickory Log Creek bridge, White City Store, Macedonia Church, O. L. Buffington's mailbox, Cannon's Store, Wilkin's Store, W. B. Sisson's house, Holden's house, Hubbard's Store, Canton post office, Sandy Plains School, Sharp Top School, Union Church, Salem Church, Dolf Poole Property. <li data-bbox="470 594 1188 683">2. Crabapple Quadrangle, C. A. Turner, 1926. Notable triangulation points: Orange Road, Ducktown Crossroads, Canton Cotton Mill, Sandy Springs and Woodstock Hwy crossing. <li data-bbox="470 716 1188 870">3. Tate Quadrangle, F. Larner, 1926. Notable triangulation points: Sharp Mountain Church, Chalcedonia Church, Pine Log Creek Bridge, Macedonia Church, Cannon's Store, Creighton Bridge, Ball Ground and Marble Hill Road intersection, Marble Hill Saw House, Sharp Top School <li data-bbox="470 902 1188 1146">4. Acworth Quadrangle, C. W. A., L. K. Dunagin, 1934. Notable triangulation points: Lovingood Bridge, Noonday Creek Bridge, Litchfield House, Pumpkin Vine Creek, Kennesaw Mountain, Jugs Tourist Camp, Allatoona Depot, Roland Hart House, Boston Creek Bridge, Dry Branch School, Payne Village, Allatoona Creek Bridge, Rock Hill School, Center Church, Macedonia Church, Clearwater Creek Bridge, Macedonia Schoolhouse, Sutalee near store and crossroads, Stamp Creek <li data-bbox="470 1179 1188 1300">5. Waleska Quadrangle, James Cantey, L. K. Dunagin, 1945. Notable triangulation points: Medlin Ford Place, Pine Log Creek Bridge, Millers Chapel, Gravelly Hill School, Shoal Creek Baptist Church <li data-bbox="470 1333 1188 1521">6: Acworth Quadrangle, 1957: Notable triangulation points: J. E. White property, Perkinson McAfee and Latimer Building, Noonday Creek Bridge, Mount Carmel Church, Shoal Creek Bridge, Payne Village, Gravelly Hill School, Millers Chapel, Dry Branch School, Pine Grove Church, Kennesaw Battlefield Park, Emerson School, Bascomb Methodist Church, Kellogg Creek 			Fourth Floor Storage

Catalog / Objectid / Objname	Description	Condition	Status	Home Location
	Reservoir, Toonight Baptist Church, Rowland Springs Baptist Church 7: Waleska Quadrangle, 1951, most points are previously listed 8: Crabapple Quadrangle, 1953, bound in booklet rather than stapled. Most triangulation points presviously listed.			
A 2000.2.30 Manual	A short operator's manual for the Rotolite copy machine. Covers basic operation and required materials for the machine. Included is also a warranty notice and advert for other related Rotolite printing products.			Fourth Floor Storage
A 2000.2.31 Electronic Document	Collection of scanned documents from Ronald Ridgway about Lat Ridgway. Images 1-2: Voting tabulation from 1964, showing the number of votes winning elected officials received. Image 3: Map of proposed Canton city limit expansion using a drawn aerial map from Lat in 1957. Image 4: Newspaper clipping showing the swearing in of elected officials in January, 1965. From left to right is C. B. "Butch" Holcomb, N. R. Haworth, Lat Ridgway, Trammell Carmichael, W. A. "Short" Cole, Dan Stringer, Roscoe Weatherby, Norman Sosebee, Jim Dickerson, Grady Vandivere, and Judge Sam Burtz. Images 5-8: Roadmap of Canton provided by the Bank of Canton in 1957. Image 9: THE LAT RIDGWAY FAMILY LAT RIDGWAY 811 MARIETTA RD CANTON GA 30114 Lat Ridgway, Jan. 27, 1895, Hart Co. Canon, Ga. Son of Noah James and Alice Starr Ridgway. Carruth Walters Ridgway, May 18, 1904, Franklin Co. Martin, Ga. Daughter to Robert M. Walters and Margaret Emma ElDora Garner Walters. Lat & Carruth, Married Mch. 6, 1926. Capital View Baptist Church,			Third Floor Storage

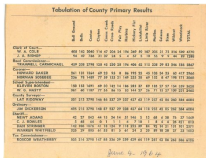

Catalog / Objectid / Objname	Description	Condition	Status	Home Location
	<p>Atlanta. Ga. by Rev. W. Lee Cutts. (Saturday) First Child- A son, born Sept 19, 1931, Madison, Ga. (Dead at Birth) burried Sunday Sept. 20, 1931, in Walters lot in cemetery, Hartin, Ga. Stephens County. 2nd Child-- Ronald Walters Ridgway, Sept. 5, 1933, Stephens Co. Martin Ga. at Grandmother's Walters home. Wt. 9 lbs. 8 Oz. 22 inches long. Dr. W. H. Swain, attending Physican. 3rd Child- Latimer Cook Ridgway, Sept. 20, 1937, Clarke .06. Athens, Ga. Athens General Hosnital. Wt~ 8 lbs. 13 oz. 21½ inches long. Dr. H. I. Reynolds, (University Doctor) Ronald Walters Ridgway, Canton, Ga. and Linda Rowena Haddock of Fernandina Beach, FL. were married Monday December 28, 1959, Glenn Memorial Chapel, Emory University, Atlanta, Ga. by Hev. Fred L. Glisson. (Linda's birthday Jan. 12, 1936) 1st. child- Ronald Walters Ridgway Jr. born Jan. 1, 1S61, St. Mary's Hospital, San Francisco, California. Wt. 7 lbs . 15oz, 20 inches long. 2nd, Child- James Clifford .nidgway, Born 1-feb 8, 1963, Providence Hospital, Washington, D., C. Wt. 8 lbs. 6 ozs. (The family lived in Springfield, Va. 3rd. Child-- Margaret Ida Ridgway, 0 orn Nay, 13, 1965, Piedmont Hospital, Atlanta, Ga. Wt. 8 lbs, 11½ ozs. Latimer Cook Hidgway, Canton, Ga. and E'rances Narie Whitfield of Doerun, Ga. were married Sunday June 21, 1959, at the liose lBf Sharon Baptist Church, :Qoettnn, Ga. by Rev. Paris J. Baker. (Frances's birthday date- October 8. 1937) 1st, child, Millicent Anne fiidgway, born Jan. 1, 1965. Cleveland, Ohio. Wt. 7 lbs. 15 ozs. 22 inches long. 2nd. Child- Kristel Alane Ridgway, born Jan. 28, 1967, Charlotte, N. Co Wt. 6 lbs. 12 ozs</p> <p>Images 10-11: Survey by Lat of his own home in June 1947</p>			

Catalog / Objectid / Objname	Description	Condition	Status	Home Location
A 2000.2.36 License	Two City of Canton Business Licenses for Lat Ridgway, Surveyor, 1967 and 1966			
A 2000.2.54 Document	Collection of documents from lat ridgway. Includes copy of survey of his own house, a proposed extension of the Canton city limits showing an aerial view drawing from 1957, two documents relating to Cherokee County voting results from June 1964, newspaper article from January 1965 showing the swearing in of elected officials, and a 1958 city map of Canton showing an aerial drawing. See 2000.2.30 for full information.			
A 2000.2.55 Notebook	Notebook Number Six 6 Transit Book 1940-1946			
A 2000.2.56 Notebook	Notebook Number Seven 7 Transit Book 1947			
A 2000.2.57 Notebook	Notebook Number Nine 9 Transit Book 1948-1949			

Catalog / Objectid / Objname	Description	Condition	Status	Home Location
A 2000.2.58 Notebook	Notebook Number Eleven 11 Transit Book 1948-1949			
A 2000.2.59 Notebook	Notebook Number Twelve 12 Cross Section Book 1949-1951			
A 2000.2.60 Notebook	Notebook Number Thirteen 13 Transit Book 1949-1952			
A 2000.2.61 Notebook	Notebook Number Fourteen 14 Field Book Book Eleven 11 Also contains records of service and fuelings for his Model 1936 Ford Car in the back of the notebook. Also contains accident and wreck sketches in the book for car accidents in Cherokee County.			
A 2000.2.62 Notebook	Notebook Number Fifteen 15 Field Book 1951-1954			

Catalog / Objectid / Objname	Description	Condition	Status	Home Location
A 2000.2.63 Notebook	Notebook Number Sixteen 16 Field Book Cherokee County Schools 1952-1969 Surveys for Free Home, Buffington, County Training School, Holly Springs, Hickory Flat, Oak Grove, Cherokee County High School, Clayton, and Ball Ground schools.			
A 2000.2.64 Notebook	Notebook Number Seventeen 17 Engineers Field Book Cherokee Schools 1952-1957			
A 2000.2.65 Notebook	Notebook Number Eighteen 18 Engineers' Field Book 1952-1953 Includes surveys for properties in Clarkesville in Habersham County.			
A 2000.2.66 Notebook	Notebook Number Nineteen 19 Field Book 1953-1955			
A 2000.2.67 Notebook	Notebook Number Twenty 20 Field Book 1955-1957 Includes surveys for Tumlin - Etowah Indian Mounds, Bartow County, W.L. Lawson, Roy Lipscomb - White, GA, Ronald Eaton - Acworth, GA, Henry C. Cagle - Canton, Jones Mercantile Company - Canton, James A. Cannon and Henry C. Cagle - Canton, J.W. Chamlee - Sharptop Road			

Catalog / Objectid / Objname	Description	Condition	Status	Home Location
A 2000.2.68 Notebook	Notebook Number Twenty One 21 Field Book 1956-1957			
A 2000.2.69 Notebook	Notebook Number Twenty-Two 22 Field Book 1957-1958			
A 2000.2.70 Notebook	Notebook Number Twenty Three 23 Field Book 1958-1959			
A 2000.2.71 Notebook	Notebook Number Twenty Five 25 Transit Book 1959-1960			
A 2000.2.72 Notebook	Notebook Number Twenty Six 26 Field Book 1960-1962			

Catalog / Objectid / Objname	Description	Condition	Status	Home Location
A 2000.2.73 Notebook	Notebook Number Twenty Seven 27 Field Book 1961-1967			
A 2000.2.74 Notebook	Notebook Number Twenty Eight 28 Field Book 1962-1965 contains survey for Jasper Post Office July 10, 1962			
A 2000.2.75 Notebook	Notebook Number Twenty Nine 29 Engineer Field Book 1964-1968			
A 2000.2.76 Notebook	Notebook Number Thirty 30 Engineer Field Book 1964-1967			
A 2000.2.77 Notebook	Notebook Number Thirty One 31 Engineer Field Book 1965-1966			

Catalog / Objectid / Objname	Description	Condition	Status	Home Location
A 2000.2.78 Notebook	Notebook Number Fity 50 Field Book 1967-1969			
A 2000.2.79 Notebook	Notebook Number Fifty One 51 Engineer Field Book 1969-1970			
A 2000.2.80 Notebook	Notebook Number Fifty Two 52 Engineer Field Book 1970-1972			
A 2000.2.81 Notebook	Notebook Number Fifty Four 54 Engineer Field Book 1973-1975			
A 2000.2.82 Notebook	Notebook Number Fifty Five 55 Engineer Field Book 1975-1976			

Catalog / Objectid / Objname	Description	Condition	Status	Home Location
A 2000.2.83 Notebook	Notebook First Baptist Church of Canton and others 1966			
A 2000.2.84 Notebook	Notebook Dietzgen Notebook Number Thirty One 31 1963			
A 2000.2.85 Notebook	Notebook Dietzgen Field Book Number Thirty 30			
A 2000.2.86 Notebook	Notebook Dietzgen Field Book Number Thirty Two 32 1963-1965			
A 2000.2.87 Notebook	Notebook Dietzgen Field Book Number Forty 40 1966-1968			

Catalog / Objectid / Objname	Description	Condition	Status	Home Location
A 2000.2.131 Deed	Deed from J.D. Parris to Lula Parris Deed Book 63 Page 93 September 25, 1961, Land Lot 190, 23rd District, 2nd Section, Cherokee County, Georgia			
A 2000.2.132 Pamphlet	Green Thumb Tips for the Urban Gardener Pamphlet of Air layering Leaflet 91 April, 1970			
A 2000.2.133 Pamphlet	Banyan tree informational packet including postcard			
A 2000.2.135 Plat	Plat and notebook paper with Lat's logo			
A 2000.2.136 Stencil	RapiDesign Plastic Circle Template Number 40 and shipping receipt from Georgia Blue Print Company July 17, 1962			

Catalog / Objectid / Objname	Description	Condition	Status	Home Location
A 2000.2.137 Pamphlet	Instructions for Installing Parallel Ruling Unit			
A 2000.2.138 Map	General Highway Map of Cherokee County Georgia prepared by the State Highway Department of Georgia Division of Highway Planning in cooperation with U.S. Department of Commerce Bureau of Public Roads 1954			
A 2000.2.140 Map	1971 Georgia Official Highway Map			
A 2000.2.141 Map	1972 Georgia Official Highway Map			
A 2000.2.142 Map	Georgia State Map by Texaco			

Catalog / Objectid / Objname	Description	Condition	Status	Home Location
A 2000.2.143 Map	Florida State map by Chevron			
A 2000.2.144 Map	1971 Map of Eastern United States containing states east of the Mississippi River. This map introduces the new Interstate Highway Signs which were put out by the US Government in 1972.			
A 2000.2.145 Map	Eastern United States Map Adjacent to Canada			
A 2000.2.146 Map	North Carolina and South Carolina Map by Esso. Stamped by L. Smith Esso Service 4501 Randolph Road Charlott, NC.			
A 2000.2.147 Map	1961 Standard Oil 75th Anniversary Forever Map of the United States. It is a pictorial map showing how oil products have made life easier and more secure. It is a road map of America's newer and safer highways. It was distributed on the occasion of the 75th Anniversary of Standard Oil Company in Kentucky. The map also listed other Standard Oil products which are Crown Gasoline, Crown Extra Gasoline, Super Crown Extra Gasoline, Mobiloil Special, Mobiloil, Uniflo Motor Oil, Esso Extra Motor Oil, Esso Motor Oil, Atlas Tires and Tubes, Atlas Batteries, and Accessories.			

Catalog / Objectid / Objname	Description	Condition	Status	Home Location
A 2000.2.148 Map	1964 Sears and Roebuck Florida State Map			
A 2000.2.149 Brochure	Study Abroad Brochures from the University of Georgia Annual Fund 1977 and 1977 Wildlife Stamps. Brochures are of trips to Egypt with three days in London and a trip to Switzerland and Germany. These were sent to Lat for him giving money to the Annual Fund. Wildlife Stamps are from the National Wildlife Federation and contain stickers of Desert Kangaroo Rat, American Woodcock, Yellow Birch, Common Dolphin, Marbled Salamander, Mink, Saguaro Cactus, Green Kingfisher, Atlantic Hawksbill Turtle, Common Loon, Water Hyacinth, American Coot, Polyphemus Moth, Wilson's Plover, Claret Cup Cactus, Brown Pelican, Green Sunfish, Moose, Black Crowned Night Heron, Sea Anemone, Labrador Duck, Strawberry Hedgehog, Common Murre, Western Tiger Swallowtail, White Eyed Vireo, Manta Ray, Spotted Towhee, Porkfish, Osprey, Mayfly, Dipper, Ornate Chorus Frog, King Eider, West Indian Flamingo, Lionfish, and Frigatebird			
A 2000.2.150 Book	Pecans in Georgia 1961 by the University of Georgia College of Agriculture Cooperative Extension Service. Cooperative Extension Work in Agriculture and Home Economics State of Georgia. The Unveristy of Georgia College of AGriculture and the U.S. Department of Agriculture Cooperating. Distributed in furtherance of the purposes provided for by the Acts of Congress of May 8, 1914.			
A 2000.2.151 Brochure	Four Exciting New Adventures from the National Geographic Society advertising for special publications called Hawaii, In The Footsteps of Lewis and Clark, Gypsies, and Those Inventive Americans.			

Catalog / Objectid / Objname	Description	Condition	Status	Home Location
A 2000.2.152 File	Contains Plat Tracing for Plat JJ/193. Tracement is for Teasley Estate In Land Lot 195, 14th District, 2nd Section, Cherokee County, Georgia October 1908, deed between D. Carl Tallant to Robert I. Lathem, Sr. for the sum of \$7000.00 on November 18, 1950 being further described in Deed Book NN/223 and Deed Book VV/113. Also includes Security deed from D. Carl Tallant to the Bank of Canton in the amount of \$3500.00 for the formerly referenced property. Also Includes deed from Jesse Fincher to Robert I. Lathem for Land Lot 65 and Block C of the Town of Canton further described in Deed Book JJ/168 for the sum of \$2500.00			
A 2000.2.154 Map	United States Department of the Interior Geological Survey Topographic Map of Georgia August 1973 and Mail Order Forms for the Map			
A 2000.2.155 Notebook	Farmer's Year Book 1960 Contains farming information			
A 2000.2.156 Document	National Ocean Survey National Geodetic Survey Data Report January 1973 by United States Department of Commerce National Oceanic and Atmospheric Administration. National Geodetic Survey Data Availability - Explanation - Application. Authored by Joseph F. Dracup Assistant Chief, Horizontal Network Division National Geodetic Survey National Ocean Survey National Oceanic and Atmospheric Administration United States Department of Commerce, Rockville, Maryland 20852. Also contains letter to Lat Ridgway from Allen L. Powell, Rear Admiral, NOAA Diretor National Ocean Survey			

Catalog / Objectid / Objname	Description	Condition	Status	Home Location
A 2000.2.157 Deed	Deeds for property of Stan Hudgins containing Forty 40 Acres more or less. These deeds were to be used for a survey for Mr. Hudgins' property.			
A 2000.2.158 Advertisement	Three 3 Phone Book Covers with old Advertisements from businesses in the City of Canton. The Multi Colored Cover has advertisements from Huey Funeral Home, Canton Motor Sales, Canton Weightloss Clinic, Canton Chiropractic Clinic, Canton Sports Center, B & B Parts Company Inc., Herndon Heatin and Air, The Grass Roots Retaurant, Cherokee Federal Savings and Loan Association, Joe Manous State Farm Insurance, Cherokee Tire Service, and Canton-Marietta Termit and pest Control. The first yellow cover has 1981 written on the front and contains advertisements from Lusk Construction Inc, Canton Marietta-Jasper Termite & Pest Control, Huey Funeral Home, Kearley's Autoparts, The Cosmetique, Atlantic Building Systems. The second yellow cover has advertisements for North Georgia Sign Company, Leon Cox Wrecker Service, Canton-Marietta-Jasper Termite and Pest Control, Huey Funeral Home, Canton Chiropractic Clinic, Cherokee Answering Service, Paint by Filman and Moore Paints, The Macrame Outlet, The Cosmetique, Mathews Photography, Leon Cox Wrecker Service, and Georgia Aluminum Storm Door and Windo Manufacturing Company.			
A 2000.2.162 Notebook	Jones Mercantile Company Farmer's Year Book 1957 for Jones Mercantile Company's Seventy Eighth Year Serving North Georgia. Contains farming information and Lat Ridgeway's notes on his trip of the east coast for mileage, costs, and fuel ups.			

Catalog / Objectid / Objname	Description	Condition	Status	Home Location
A 2000.2.163 Plat	<p>1. Contains Survey for Clyde Worley, Canton, Cherokee County, Georgia Land June 30, 1970 Land Lot 197, District 14, 2nd Section 3.7 acres more or less.</p> <p>2. Survey for Jackson Samuel Payne and Jeanne Payne for 22.25 Acres more or less for property located at Land Lots 278 and 299, 2nd District, 2nd Section, Surveyed September 24, 1979 by Darryl R. Brumbelow.</p> <p>3. Survey for Jack-Will Mobile Home Park in Woodstock, Georgia by RW Hastings of property that is part of Freeman Heights, Land Lot 1121, 21st District, 2nd Section, Cherokee County, Georgia.</p> <p>4. Survey tracement for C.B. Miller, O. Reece, and J. W. Reece for property located in parts of Land Lots 127, 128, and 162 containing 56.2 acres more or less, dated March 16 -17, 1923.</p> <p>5. Blue plat of survey for Canton Cotton Mills along with a letter about the survey to Mr. LL Jones from Dr. E. Billings, dated March 30, 1938. This was a survey for the Canton Cotton Mills in Land Lots 89 and 90, 15h District, 2nd Section, Cherokee County, Georgia dated March 25th, 1938.</p>			
A 2000.2.173 Document	<p>Contract, Survey Notes, and Title Work for Cotton Mill # 2. Contains the building contract and title notes for Canton Cotton Mill # 2 Number Two. Also contains a letter from E Billings to LL Jones for the survey he did for the new cotton mill. The survey cost \$38.00. All of these documents are dated May 1923 to July 1923.</p>			
A 2000.2.175 Book	<p>Allatoona Reservoir Horizontal and Vertical Control Data for Sedimentation and Retrogression Ranges 1953. Brown book stapled together with a sketch of the Allatoona Dam and Powerhouse on the cover. Contains a letter in between the pages from the Reservoir Engineer, O.H. Monroe, to Lat Ridgway dated February 12, 1964.</p>			

Catalog / Objectid / Objname	Description	Condition	Status	Home Location
A 2000.4.1 Map	Topographical Map of Birmingham Georgia 1956	Good		Fourth Floor Storage
A 2000.4.2 Map	Topographical Map of Roswell Georgia 1956	Good		Fourth Floor Storage
A 2000.4.3 Map	Topographical Map of Chamblee Georgia 1954	Good		Fourth Floor Storage
A 2000.4.4 Map	Topographical Map of Rome Georgia, Alabama, North Carolina, and Tennessee 1954	Good		Fourth Floor Storage
A 2000.4.5 Map	Topographical Map of Greenville South Carolina, Georgia, and North Carolina 1954	Good		Fourth Floor Storage

Catalog / Objectid / Objname	Description	Condition	Status	Home Location
A 2000.4.6 Map	Topographical Map of Atlanta Georgia 1926.	Good		Fourth Floor Storage
A 2000.4.7 Map	Topographical Map of Marietta Georgia 1932.	Good		Fourth Floor Storage
A 2000.4.8 Map	Topographical Map of Ellijay Georgia, North Carolina, and Tennessee 1926.	Good		Fourth Floor Storage
A 2000.4.9 Map	Topographical Map of Atlanta Georgia 1926.	Good		Fourth Floor Storage
A 2000.4.10 Map	Topographical Map of Suwanee Georgia 1917.	Fair		Fourth Floor Storage

Catalog / Objectid / Objname	Description	Condition	Status	Home Location
A 2000.4.11 Map	Topographical Map of Rome Georgia and Alabama 1928.	Good		Fourth Floor Storage
A 2000.4.12 Map	Topographical Map of Cartersville Georgia 1939.	Good		Fourth Floor Storage
A 2000.4.13 Map	Topographical Map of Cartersville Georgia 1914.	Fair		Fourth Floor Storage
A 2000.4.14 Map	Topographical Map of Georgia-Tennessee, Ringgold 1929.	Good		Fourth Floor Storage
A 2000.4.15 Map	Topographical Map Gainsville Georgia 1914.	Good		Fourth Floor Storage

Catalog / Objectid / Objname	Description	Condition	Status	Home Location
A 2000.4.16 Map	Topographical Map of Marietta Georgia 1932.	Good		Fourth Floor Storage
A 2000.4.17 Map	Topographical Map of Dahlonega Georgia 1922.	Good		Fourth Floor Storage
A 2005.1.68 Ledger	Justice Court documents dated 1889 to 1902.			Fourth Floor Storage
A 2005.1.70 Book	Charter and ordinances of the town of Canton dated 1916. Compiled by E.W. Coleman, the city attorney and printed by the Rudasill Printing Company in Canton, GA.			First Floor Museum

Total Items 554