

STEP 2: FOLD FOLLOW THIS LINE

STEP 1: FOLD FOLLOW THIS LINE

STEP 2: FOLD FOLLOW THIS LINE

WITH MY HAND?

HOW TO SOLVE THE TASK IN A SUSTAINABLE WAY?

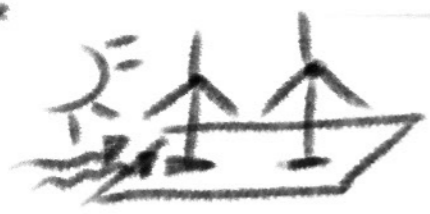

"SUSTAINABLE?"

A3 PAPER?



4 IMAGES?

GRAB THE PAPER, FOLD IN HALF, I GOT A TENT!

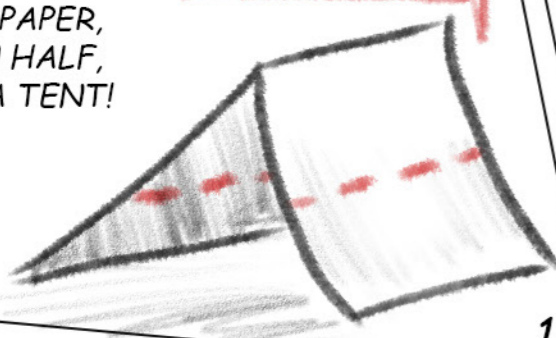

I NEED A PLACE TO LIVE

1

KEEP FOLDING FOLLOW THE RED LINE, I GOT ROOF AND WALLS

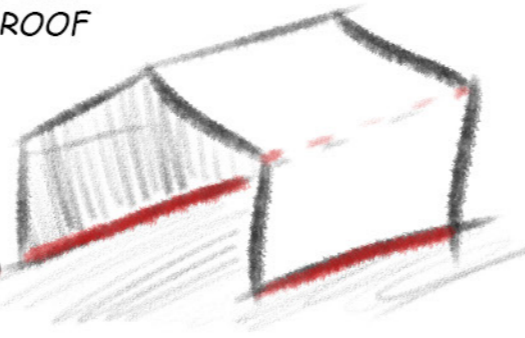

TOO COLD, I NEED MORE ROOM

2

OPEN IT! REUSE THE PAPER AND THE FOLDING LINE

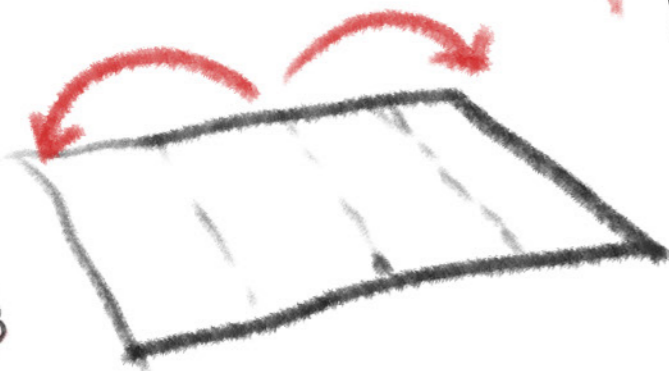

I WANT TO REBUILD

4

STICK THE RED EDGES AND ROTATE IT, I GOT HIGHRISE.

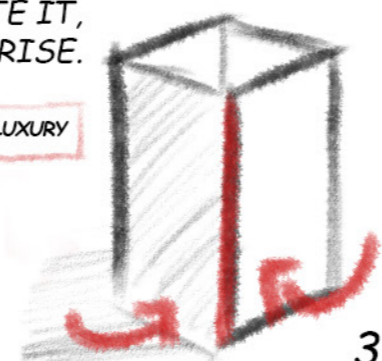

TOO SIMPLE, I WANT LUXURY

3

THE ONLY THING THAT NEVER CHANGES IS THAT EVERYTHING CHANGES.

WE HAVE TO ADMIT THAT EVERYTHING HAS THEIR OWN CIRCLE OF LIFE: BIRTH, GROWING UP, BEING OLD AND DIE. EVERY SINGLE BUILDING IS SIMILAR TO THAT, "DEATH" IS NOT THE END BUT A NEW START OF A NEW LIFE. THIS PROCESS HAS TO BE PLANNED AND YOU HAVE TO ACCEPT TO CHANGE. DO NOT TRY TO BE IMMORTALITY.

USE EVERYTHING AROUND YOU, NO MATTER HOW IT LOOKS, YOU DON'T HAVE TO ORDER SOMETHING FANCY AND GREEN TO BE "SUSTAINABLE". BUT YOU MUST FOCUS NOT TO RUIN IT, IF YOU FAIL YOU CAN TRY AGAIN, BUT YOUR RESOURCES ARE SMALLER.

KEEP FAILING, NOTHING LEFT FOR YOU!

IF YOU FOLD IT WRONG, TRY AGAIN HERE.

THE PAPER IS GETTING SMALLER. BE CAREFUL FOR WHAT YOU GONNA DO!

TRY AGAIN HERE